

2023 KX™ 65 PARTS DIAGRAM

Front Fork

F2340

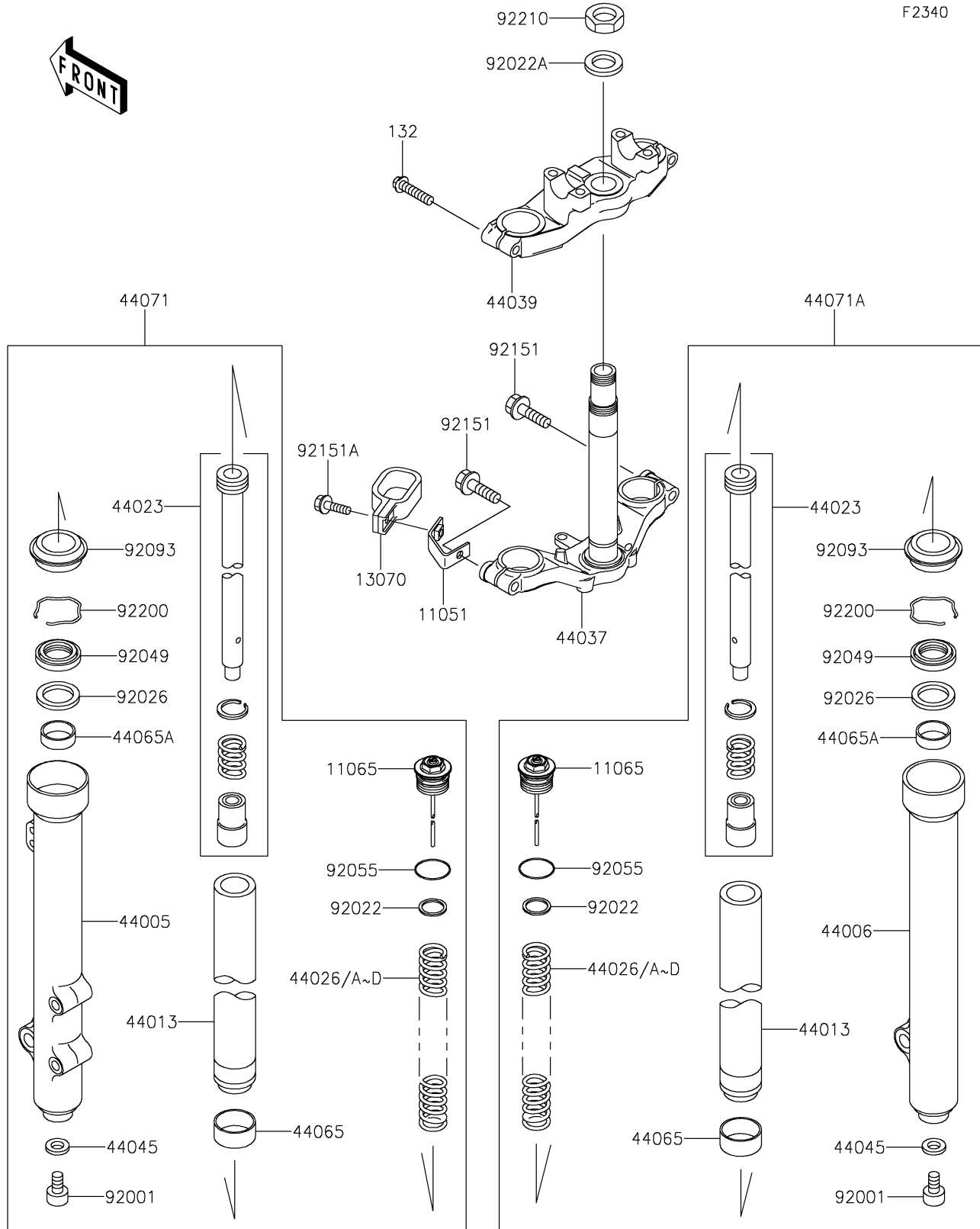

2023 KX™ 65 PARTS LIST

Front Fork

| ITEM NAME | PART NUMBER | QUANTITY |
|--|----------------|----------|
| BRACKET,BRAKE HOSE GUIDE (Ref # 11051) | 11051-1892 | 1 |
| CAP,FORK TOP,G.B.GREEN (Ref # 11065) | 11065-0746-50Y | 2 |
| GUIDE,BRAKE HOSE (Ref # 13070) | 13070-1349 | 1 |
| PIPE-LEFT FORK OUTER,P.SILVER (Ref # 44005) | 44005-0042-458 | 1 |
| PIPE-RIGHT FORK OUTER,P.SILVER (Ref # 44006) | 44006-0042-458 | 1 |
| PIPE-FORK INNER (Ref # 44013) | 44013-1496 | 2 |
| CYLINDER-SET-FORK (Ref # 44023) | 44023-1161 | 2 |
| SPRING-FRONT FORK,K=2.55N/MM (Ref # 44026) | 44026-1735 | 2 |
| SPRING-FRONT FORK,K=2.65N/MM (Ref # 44026A) | 44026-1736 | 2 |
| SPRING-FRONT FORK,K=2.75N/MM (Ref # 44026B) | 44026-1737 | 2 |
| SPRING-FRONT FORK,K=2.84N/MM (Ref # 44026C) | 44026-1738 | 2 |
| SPRING-FRONT FORK,K=2.45N/MM (Ref # 44026D) | 44026-1739 | 2 |
| HOLDER-FORK UNDER,F.BLACK (Ref # 44037) | 44037-0023-21 | 1 |
| HOLDER-FORK UPPER,F.BLACK (Ref # 44039) | 44039-0022-21 | 1 |
| GASKET,FORK CYLINDER BOLT (Ref # 44045) | 44045-051 | 2 |
| BUSHING-FRONT FORK,INNER PIPE (Ref # 44065) | 44065-1123 | 2 |
| BUSHING-FRONT FORK (Ref # 44065A) | 44065-1133 | 2 |
| DAMPER-ASSY,FORK,LH (Ref # 44071) | 44071-0803 | 1 |
| DAMPER-ASSY,FORK,RH (Ref # 44071A) | 44071-0804 | 1 |
| BOLT,FORK CYLINDER (Ref # 92001) | 92001-1464 | 2 |
| WASHER,FORK SPRING (Ref # 92022) | 92022-1841 | 2 |
| WASHER,STEERING STEM (Ref # 92022A) | 92022-1873 | 1 |
| SPACER (Ref # 92026) | 92026-1365 | 2 |
| SEAL-OIL,FORK OUTER TUBE (Ref # 92049) | 92049-1524 | 2 |
| RING-O,FORK TOP (Ref # 92055) | 92055-1367 | 2 |
| SEAL,FORK OUTER TUBE (Ref # 92093) | 92093-1519 | 2 |
| BOLT,FLANGED,10X35 (Ref # 92151) | 92151-1636 | 2 |
| BOLT,FLANGED,5X16 (Ref # 92151A) | 92151-1637 | 1 |
| WASHER (Ref # 92200) | 92200-1496 | 2 |

2023 KX™65 PARTS LIST

Front Fork

| ITEM NAME | PART NUMBER | QUANTITY |
|--------------------------------------|-------------|----------|
| NUT,STEERING STEM,22MM (Ref # 92210) | 92210-1521 | 1 |
| BOLT-FLANGED-SMALL,8X35 (Ref # 132) | 132BA0835 | 2 |