

# 1995 Ninja® ZX™ -11 PARTS DIAGRAM

Frame

F2120

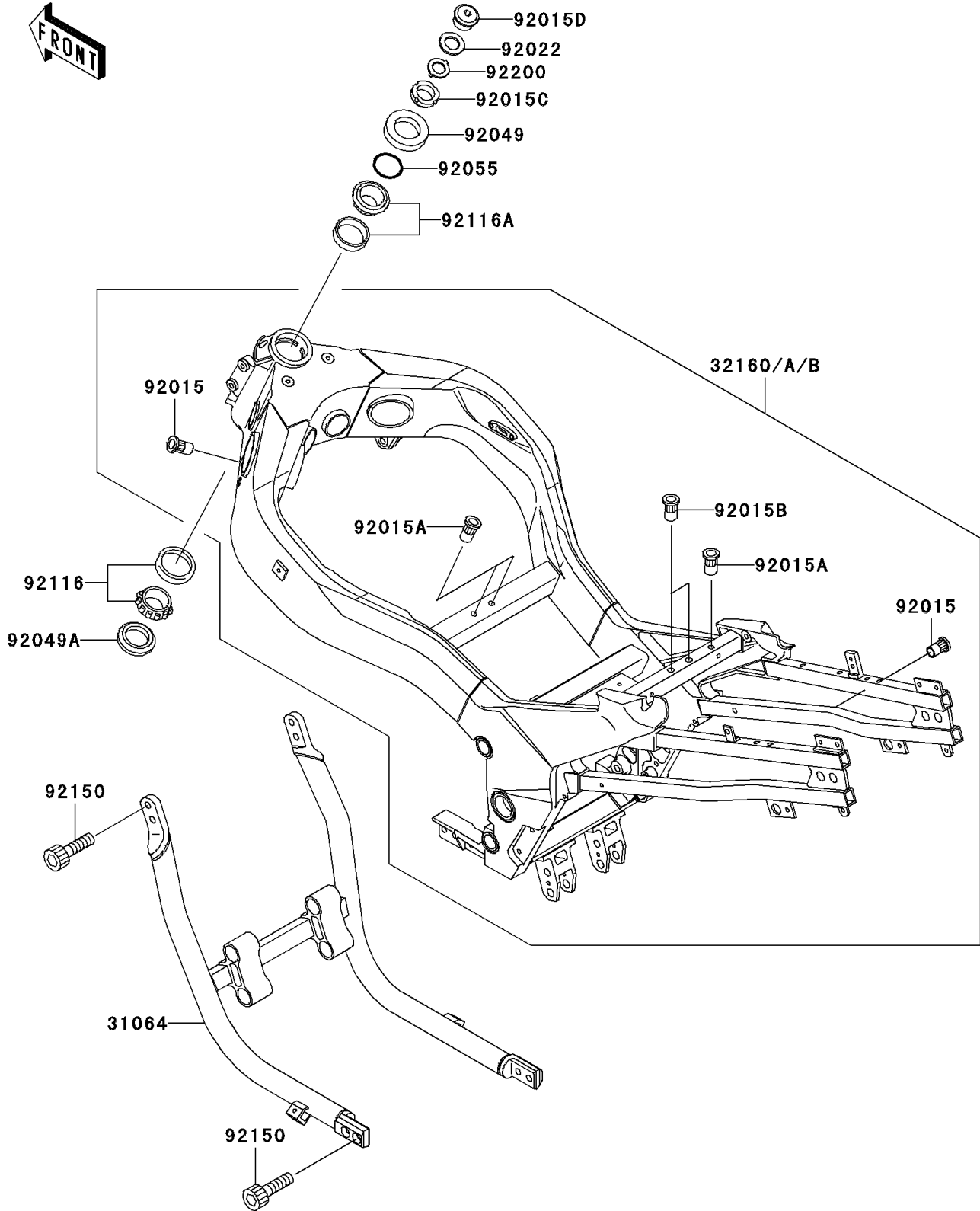

# 1995 Ninja® ZX™ -11 PARTS LIST

## Frame

| ITEM NAME                                 | PART NUMBER   | QUANTITY |
|---|---------------|----------|
| PIPE-COMP,SIDE FRAME,BLACK (Ref # 31064)  | 31064-1148-10 | 1        |
| NUT,POP,6MM,L=15 (Ref # 92015)            | 92015-1791    | 10       |
| NUT,POP,6MM,L=16.5 (Ref # 92015A)         | 92015-1792    | 3        |
| NUT,POP,8MM,L=18 (Ref # 92015B)           | 92015-1794    | 2        |
| NUT,STEERING STEM,35MM (Ref # 92015C)     | 92015-1848    | 1        |
| NUT,STEERING,25MM (Ref # 92015D)          | 92015-1891    | 1        |
| WASHER,25X36X2.3 (Ref # 92022)            | 92022-250     | 1        |
| SEAL-OIL,XXMH 43 75 6.4J (Ref # 92049)    | 92049-1382    | 1        |
| SEAL-OIL,XXMHE 43 55 4J (Ref # 92049A)    | 92049-1383    | 1        |
| RING-O,34.5X2.0 (Ref # 92055)             | 92055-1452    | 1        |
| BEARING-ROLLER,32907JR-2 (Ref # 92116)    | 92116-1072    | 1        |
| BEARING-ROLLER,32907JR-3 (Ref # 92116A)   | 92116-1074    | 1        |
| BOLT,SOCKET,10X30 (Ref # 92150)           | 92150-1690    | 8        |
| WASHER,CLAW,25.5X40X2.3 (Ref # 92200)     | 92200-1083    | 1        |
| FRAME-COMP,AL,G.GRAY (Ref # 32160)        | 32160-1280-GD | 1        |
| FRAME-COMP,AL,SILVER NO.35 (Ref # 32160B) | 32160-1280-VZ | 1        |