

1993 Ninja® ZX™ -11 PARTS DIAGRAM

Cowling(ZX1100-D1)

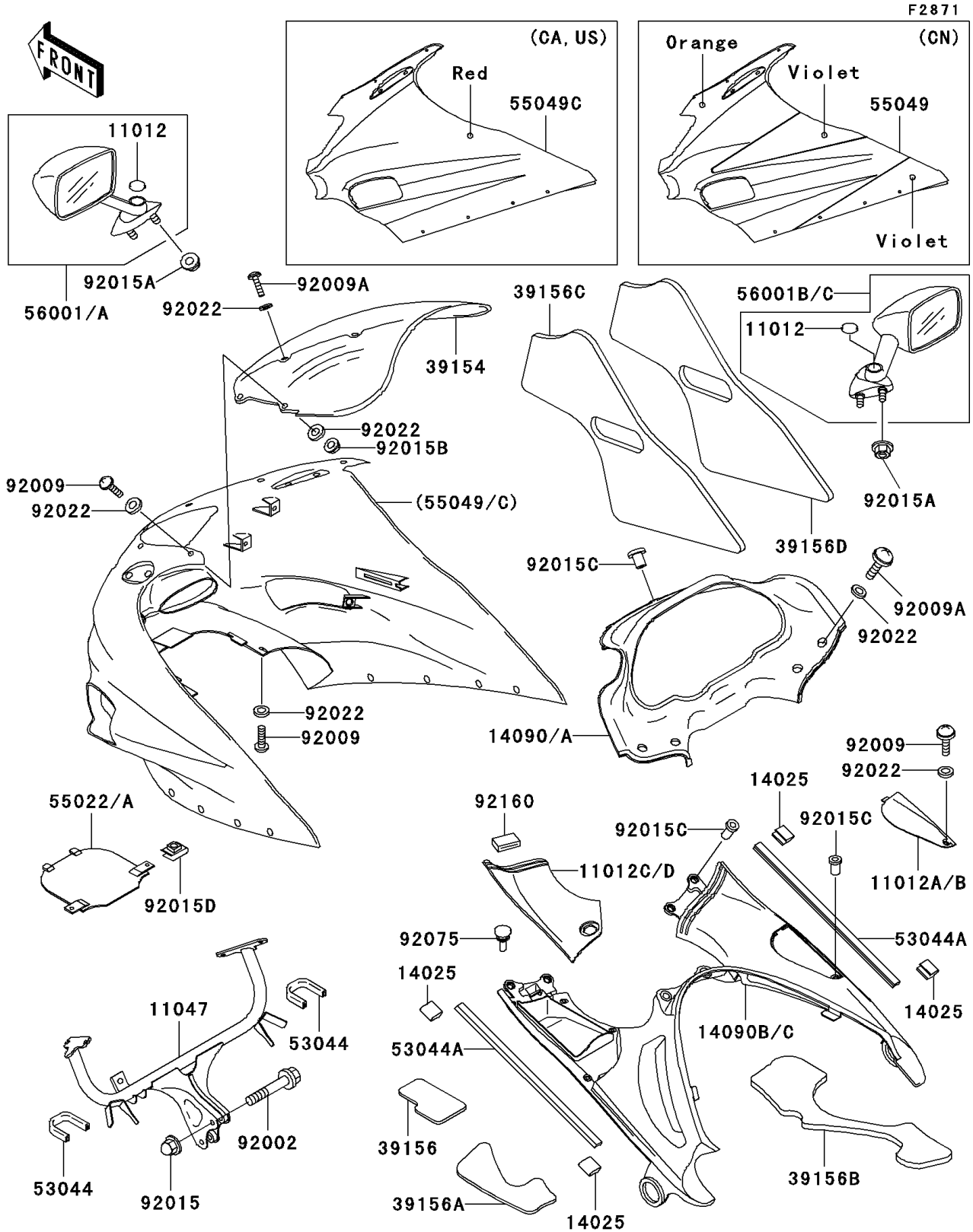

F2871

1993 Ninja® ZX™ -11 PARTS LIST

Cowling(ZX1100-D1)

| ITEM NAME | PART NUMBER | QUANTITY |
|--|---------------|----------|
| CAP,MIRROR,BLACK (Ref # 11012) | 11012-1751-6Z | 2 |
| BRACKET,UPP COWLING (Ref # 11047) | 11047-1920 | 1 |
| COVER,TRIM END (Ref # 14025) | 14025-1756 | 4 |
| WINDSHIELD (Ref # 39154) | 39154-1122 | 1 |
| PAD,INNER COWLING,LH,FR (Ref # 39156) | 39156-1329 | 1 |
| PAD,INNER COWLING,LH,RR (Ref # 39156A) | 39156-1330 | 1 |
| PAD,INNER COWLING,RH (Ref # 39156B) | 39156-1331 | 1 |
| PAD,UPP COWLING,LH (Ref # 39156C) | 39156-1332 | 1 |
| PAD,UPP COWLING,RH (Ref # 39156D) | 39156-1333 | 1 |
| TRIM,L=100 (Ref # 53044) | 53044-1200 | 2 |
| TRIM,L=385 (Ref # 53044A) | 53044-1255 | 2 |
| BOLT,8X35 (Ref # 92002) | 92002-1198 | 2 |
| SCREW,5X16 (Ref # 92009) | 92009-1654 | 5 |
| SCREW,5X25 (Ref # 92009A) | 92009-1657 | 8 |
| NUT,CAP,8MM,BLACK (Ref # 92015) | 92015-1174 | 2 |
| NUT,FLANGED,6MM,BLACK (Ref # 92015A) | 92015-1233 | 4 |
| NUT,LOCK 5MM (Ref # 92015B) | 92015-1263 | 2 |
| NUT,WELL,5MM (Ref # 92015C) | 92015-1757 | 9 |
| NUT,5MM (Ref # 92015D) | 92015-1798 | 2 |
| WASHER,NYLON,5.3X11.5X1.5 (Ref # 92022) | 92022-1521 | 15 |
| DAMPER (Ref # 92075) | 92075-1808 | 4 |
| DAMPER (Ref # 92160) | 92160-1190 | 1 |
| CAP,INNER COWLING,RH,GRAY (Ref # 11012A) | 11012-1832-11 | 1 |
| CAP,INNER COWLING,RH,GRAY (Ref # 11012B) | 11012-1832-12 | 1 |
| CAP,INNER COWLING,LH,GRAY (Ref # 11012C) | 11012-1833-11 | 1 |
| CAP,INNER COWLING,LH,GRAY (Ref # 11012D) | 11012-1833-12 | 1 |
| COVER,INNER COWLING,FR,GRAY (Ref # 14090) | 14090-1273-11 | 1 |
| COVER,INNER COWLING,FR,GRAY (Ref # 14090A) | 14090-1273-12 | 1 |
| COVER,INNER COWLING,RR,GRAY (Ref # 14090B) | 14090-1274-11 | 1 |

1993 Ninja® ZX™-11 PARTS LIST

Cowling(ZX1100-D1)

| ITEM NAME | PART NUMBER | QUANTITY |
|--|---------------|----------|
| COVER,INNER COWLING,RR,GRAY (Ref # 14090C) | 14090-1274-12 | 1 |
| COVER-HEAD LAMP,C.S.ORANGE (Ref # 55022) | 55022-1074-RK | 1 |
| COVER-HEAD LAMP,C.W.RED (Ref # 55022A) | 55022-1074-TF | 1 |
| COWLING.,UPP,VIOLET/ORANGE (Ref # 55049) | 55049-5170-VR | 1 |
| COWLING.,UPP,C.W.RED (Ref # 55049C) | 55049-5182-TF | 1 |
| MIRROR-ASSY,LH,C.W.RED (Ref # 56001) | 56001-1390-H3 | 1 |
| MIRROR-ASSY,LH,C.S.ORANGE (Ref # 56001A) | 56001-1390-RK | 1 |
| MIRROR-ASSY,RH,C.W.RED (Ref # 56001B) | 56001-1391-H3 | 1 |
| MIRROR-ASSY,RH,C.S.ORANGE (Ref # 56001C) | 56001-1391-RK | 1 |