

2023 Mule PRO-MX EPS Camo PARTS DIAGRAM

Chassis Electrical Equipment

F2760

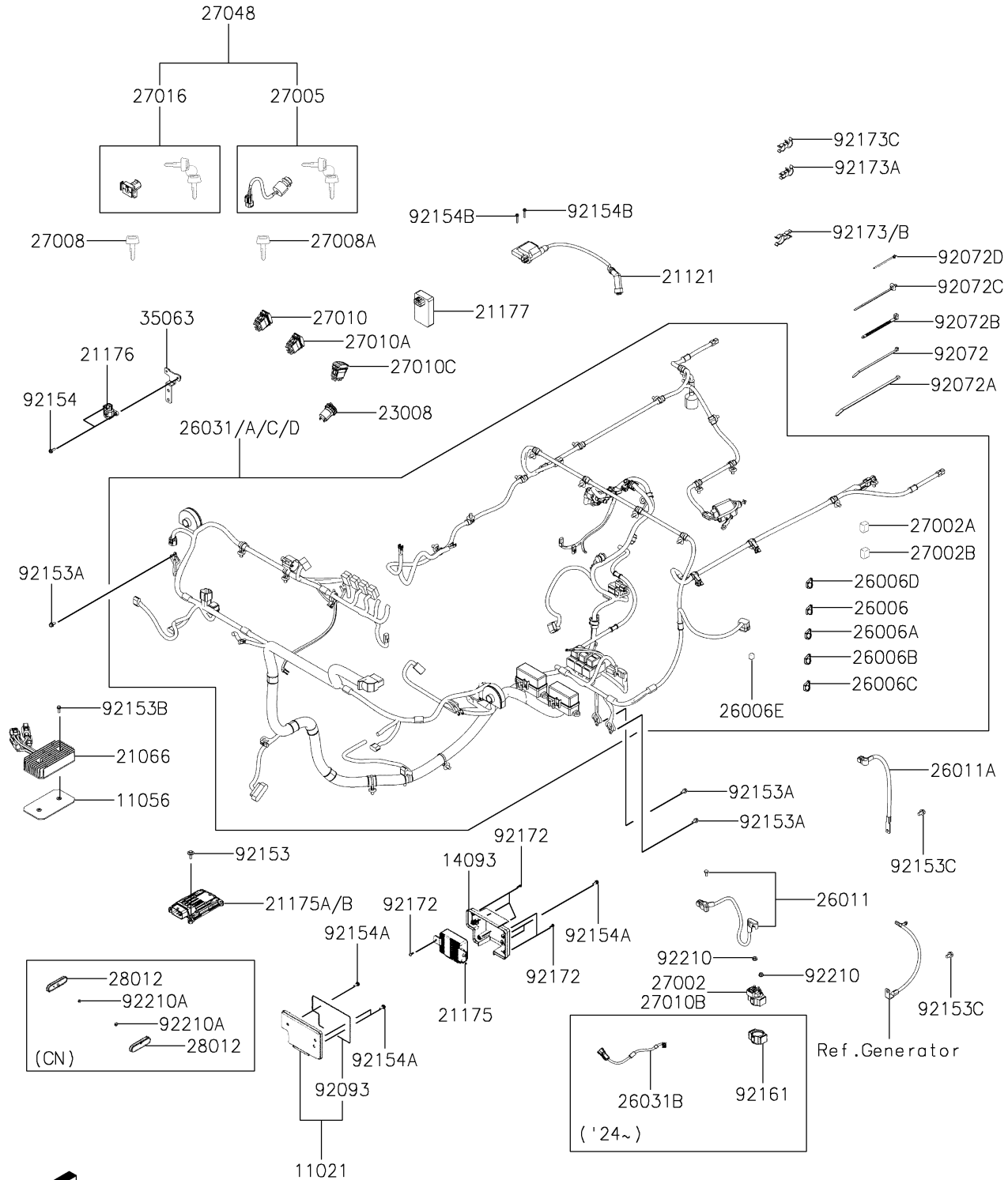

2023 Mule PRO-MX EPS Camo PARTS LIST

Chassis Electrical Equipment

| ITEM NAME | PART NUMBER | QUANTITY |
|--|-------------|----------|
| CASE-ASSY, EPS ECU (Ref # 11021) | 11021-Y003 | 1 |
| BRACKET, REGULATOR (Ref # 11056) | 11056-Y016 | 1 |
| COVER, EPS ECU (Ref # 14093) | 14093-Y042 | 1 |
| REGULATOR-VOLTAGE (Ref # 21066) | 21066-Y004 | 1 |
| COIL-IGNITION (Ref # 21121) | 21121-Y002 | 1 |
| CONTROL UNIT-ELECTRONIC (Ref # 21175) | 21175-1403 | 1 |
| CONTROL UNIT-ELECTRONIC (Ref # 21175A) | 21175-Y008 | 1 |
| CONTROL UNIT-ELECTRONIC (Ref # 21175B) | 21175-Y009 | 1 |
| SENSOR, VEHICLE-DOWN (Ref # 21176) | 21176-Y008 | 1 |
| CONTROLLER, DIFF SOLENOID (Ref # 21177) | 21177-Y004 | 1 |
| SOCKET-ASSY, DC12V (Ref # 23008) | 23008-Y006 | 1 |
| FUSE, 10A (Ref # 26006) | 26006-Y007 | 5 |
| FUSE, 20A (Ref # 26006A) | 26006-Y008 | 3 |
| FUSE, 30A (Ref # 26006B) | 26006-Y009 | 2 |
| FUSE, 40A (Ref # 26006C) | 26006-Y010 | 2 |
| FUSE, 60A (Ref # 26006D) | 26006-Y011 | 2 |
| FUSE, 20A (Ref # 26006E) | 26006-Y012 | 1 |
| WIRE-LEAD, BATTERY (Ref # 26011) | 26011-Y011 | 1 |
| WIRE-LEAD, BATTERY, EARTH (Ref # 26011A) | 26011-Y012 | 1 |
| HARNESS, MAIN (Ref # 26031) | 26031-Y027 | 1 |
| HARNESS, MAIN (Ref # 26031A) | 26031-Y030 | 1 |
| RELAY-ASSY, START (Ref # 27002) | 27002-Y009 | 1 |
| RELAY-ASSY (Ref # 27002A) | 27002-Y010 | 2 |
| RELAY-ASSY (Ref # 27002B) | 27002-Y012 | 9 |
| SWITCH-ASSY-IGNITION (Ref # 27005) | 27005-Y006 | 1 |
| KEY-LOCK, BLANK, RH CUTTING (Ref # 27008) | 27008-Y008 | 1 |
| KEY-LOCK, BLANK, LH CUTTING (Ref # 27008A) | 27008-Y009 | 1 |
| SWITCH, HEAD LAMP (Ref # 27010) | 27010-0750 | 1 |
| SWITCH, 2WD/4WD (Ref # 27010A) | 27010-0751 | 1 |

2023 Mule PRO-MX EPS Camo PARTS LIST

Chassis Electrical Equipment

| ITEM NAME | PART NUMBER | QUANTITY |
|-----------------------------------|-------------|----------|
| SWITCH,DIFF LOCK (Ref # 27010C) | 27010-0912 | 1 |
| LOCK-ASSY,INNER BOX (Ref # 27016) | 27016-Y003 | 1 |
| SWITCH-ASSY (Ref # 27048) | 27048-Y001 | 1 |
| REFLECTOR-REFLEX (Ref # 28012) | 28012-Y005 | 2 |
| STAY (Ref # 35063) | 35063-Y038 | 1 |
| BAND (Ref # 92072) | 92072-Y003 | 2 |
| BAND (Ref # 92072A) | 92072-Y011 | 4 |
| BAND (Ref # 92072B) | 92072-Y017 | 4 |
| BAND (Ref # 92072C) | 92072-Y020 | 38 |
| BAND (Ref # 92072D) | 92072-Y021 | 3 |
| SEAL (Ref # 92093) | 92093-Y046 | 1 |
| BOLT,6X20 (Ref # 92153) | 92153-Y019 | 4 |
| BOLT,FLANGE,6X12 (Ref # 92153A) | 92153-Y023 | 3 |
| BOLT,FLANGE,6X16 (Ref # 92153B) | 92153-Y025 | 2 |
| BOLT,FLANGE,8X12 (Ref # 92153C) | 92153-Y031 | 2 |
| BOLT,5X16 (Ref # 92154) | 92154-Y085 | 2 |
| BOLT,6X18 (Ref # 92154A) | 92154-Y177 | 5 |
| BOLT,4X25 (Ref # 92154B) | 92154-Y190 | 2 |
| SCREW,TAPPING,5X16 (Ref # 92172) | 92172-Y020 | 6 |
| CLAMP,D23-D18 (Ref # 92173) | 92173-Y044 | 1 |
| CLAMP,D18-D11 (Ref # 92173A) | 92173-Y046 | 1 |
| CLAMP,D11-D8 (Ref # 92173B) | 92173-Y047 | 1 |
| CLAMP (Ref # 92173C) | 92173-Y077 | 1 |
| NUT,6MM (Ref # 92210) | 92210-Y027 | 2 |
| NUT,FLANGE,5MM (Ref # 92210A) | 92210-Y053 | 2 |