

# 2024 KLX®300R PARTS DIAGRAM

Transmission

E1361

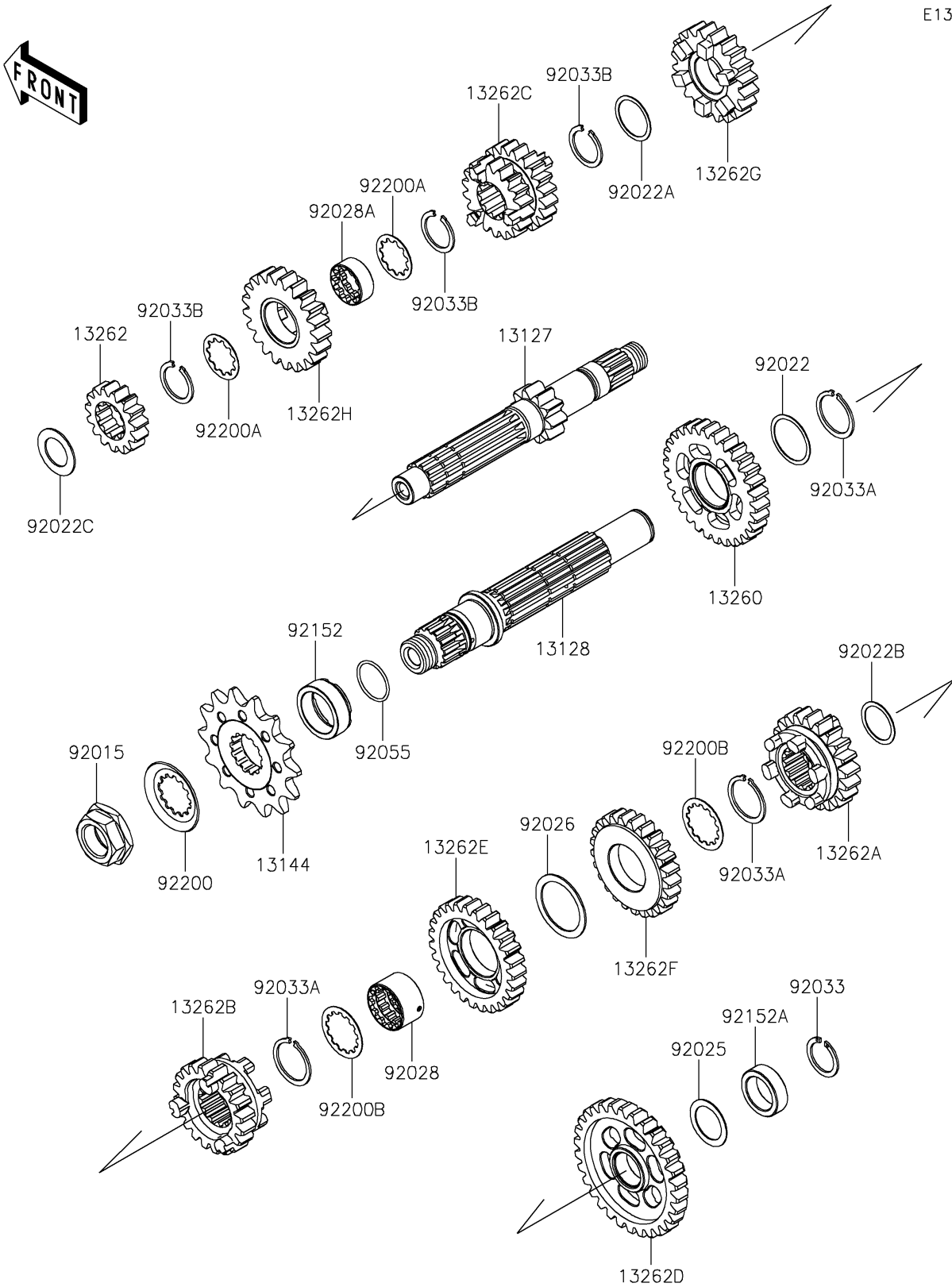

## 2024 KLX®300R PARTS LIST

### Transmission

ITEM NAME	PART NUMBER	QUANTITY
SHAFT-TRANSMISSION INPUT,10T (Ref # 13127)	13127-0670	1
SHAFT-TRANSMISSION OUTPUT (Ref # 13128)	13128-0695	1
SPROCKET-OUTPUT,14T (Ref # 13144)	13144-0055	1
GEAR,OUTPUT 2ND,30T (Ref # 13260)	13260-1386	1
GEAR,INPUT 2ND,15T (Ref # 13262)	13262-0480	1
GEAR,OUTPUT 5TH,21T (Ref # 13262A)	13262-0483	1
GEAR,OUTPUT TOP,20T (Ref # 13262B)	13262-0484	1
GEAR,INPUT 3RD&4TH,18T&20T (Ref # 13262C)	13262-0549	1
GEAR,OUTPUT LOW,30T (Ref # 13262D)	13262-0597	1
GEAR,OUTPUT 3RD,27T (Ref # 13262E)	13262-0598	1
GEAR,OUTPUT 4TH,25T (Ref # 13262F)	13262-0599	1
GEAR,INPUT 5TH,20T (Ref # 13262G)	13262-0600	1
GEAR,INPUT TOP,21T (Ref # 13262H)	13262-1380	1
NUT,20MM (Ref # 92015)	92015-1963	1
WASHER,25.3X30X0.5 (Ref # 92022)	92022-159	1
WASHER,22.3X27X0.5 (Ref # 92022A)	92022-198	1
WASHER,20.5X25.5X0.5 (Ref # 92022B)	92022-252	1
WASHER,17.3X28X1 (Ref # 92022C)	92022-255	1
SHIM,T=0.7 (Ref # 92025)	92025-1451	1
SPACER,30X38X1.0 (Ref # 92026)	92026-079	1
BUSHING,OUTPUT 3RD&4TH GEAR (Ref # 92028)	92028-1822	1
BUSHING,INPUT TOP GEAR (Ref # 92028A)	92028-1823	1
RING-SNAP,18MM (Ref # 92033)	92033-029	1
RING-SNAP,25MM (Ref # 92033A)	92033-1172	3
RING-SNAP (Ref # 92033B)	92033-1293	3
RING-O,21.5X1.5 (Ref # 92055)	92055-0196	1
COLLAR (Ref # 92152)	92152-1350	1
COLLAR,20X28X8.5 (Ref # 92152A)	92152-1357	1
WASHER (Ref # 92200)	92200-0851	1

## 2024 KLX®300R PARTS LIST

### Transmission

ITEM NAME	PART NUMBER	QUANTITY
WASHER,INPUT (Ref # 92200A)	92200-1370	2
WASHER,OUTPUT (Ref # 92200B)	92200-1371	2