

# 1996 Ninja® ZX™-11 PARTS DIAGRAM

Fuel Tank

F2410

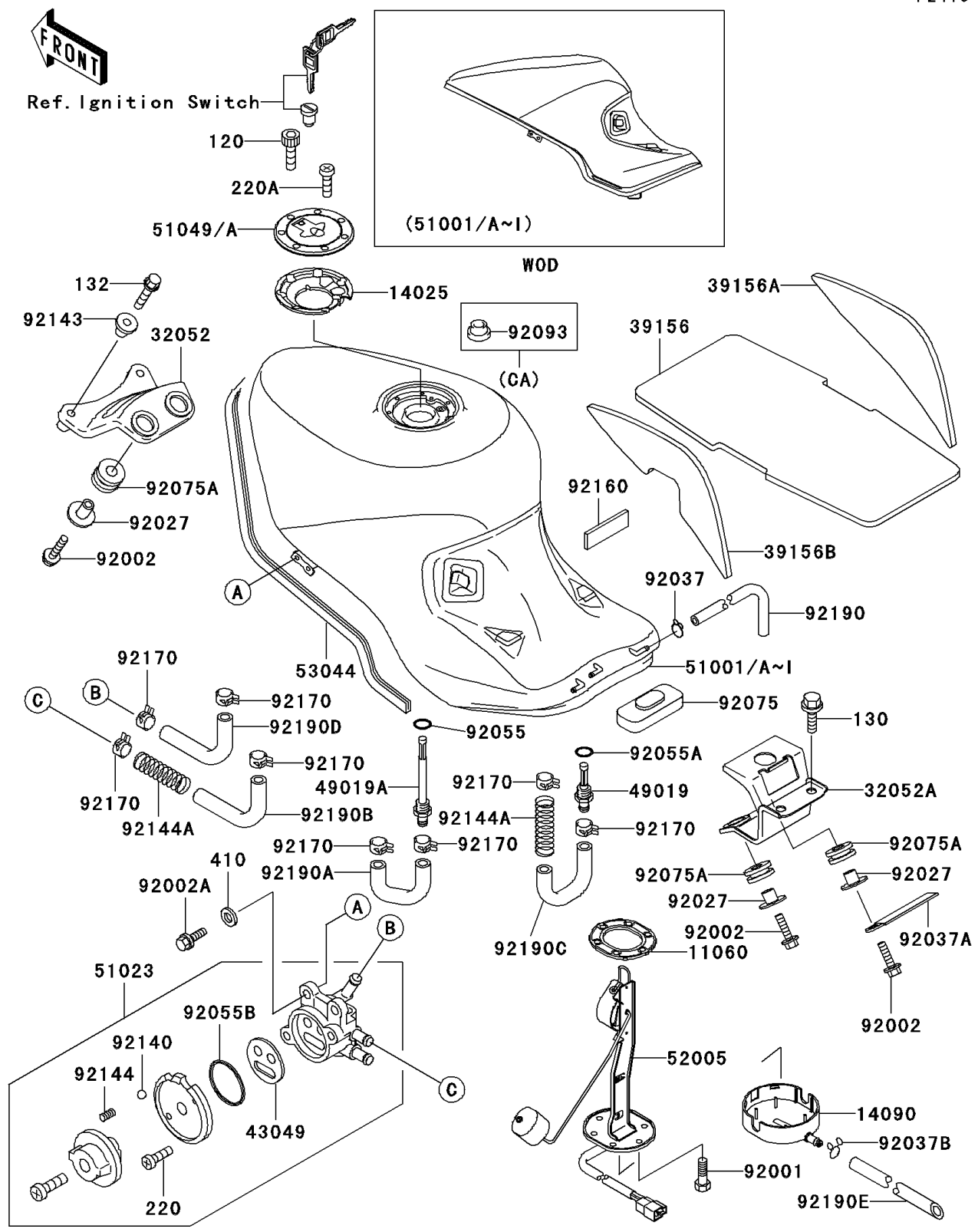

# 1996 Ninja® ZX™-11 PARTS LIST

## Fuel Tank

ITEM NAME	PART NUMBER	QUANTITY
GASKET,FUEL GAUGE (Ref # 11060)	11060-1337	1
COVER,TANK CAP (Ref # 14025)	14025-1913	1
COVER,FUEL GAUGE (Ref # 14090)	14090-1310	1
BRACKET-TANK,FR (Ref # 32052)	32052-1370	1
BRACKET-TANK,RR (Ref # 32052A)	32052-1371	1
PAD,FUEL TANK,CNT (Ref # 39156)	39156-1334	1
PAD,FUEL TANK,RH (Ref # 39156A)	39156-1335	1
PAD,FUEL TANK,LH (Ref # 39156B)	39156-1336	1
PACKING,TAP VALVE (Ref # 43049)	43049-1066	1
FILTER-FUEL (Ref # 49019)	49019-1070	1
FILTER-FUEL,"ON" (Ref # 49019A)	49019-1076	1
TAP-ASSY,FUEL (Ref # 51023)	51023-1195	1
CAP-TANK,FUEL (Ref # 51049A)	51049-1091	1
BOLT-SOCKET (Ref # 120)	120S0512	7
BOLT-FLANGED,8X20 (Ref # 130)	130J0820	2
BOLT-FLANGED-SMALL (Ref # 132)	132J0635	2
SCREW-PAN-CROS (Ref # 220)	220B0308	2
GAUGE,FUEL (Ref # 52005)	52005-1114	1
TRIM,L=1930 (Ref # 53044)	53044-1268	1
BOLT,FUEL GAUGE (Ref # 92001)	92001-1069	6
BOLT,6X20 (Ref # 92002)	92002-1237	4
BOLT,6X14 (Ref # 92002A)	92002-1700	2
COLLAR,L=13.1 (Ref # 92027)	92027-251	4
CLAMP,TUBE (Ref # 92037)	92037-010	1
CLAMP,WIRING HARNESS,L=60 (Ref # 92037A)	92037-1069	1
CLAMP,TUBE (Ref # 92037B)	92037-147	1
RING-O,ID=9.5 (Ref # 92055)	92055-1386	1
RING-O,11.5X1.5 (Ref # 92055A)	92055-1387	1
RING-O,TAP LEVER (Ref # 92055B)	92055-1419	1

# 1996 Ninja® ZX™-11 PARTS LIST

## Fuel Tank

ITEM NAME	PART NUMBER	QUANTITY
DAMPER,FUEL TANK,RR (Ref # 92075)	92075-1114	1
DAMPER (Ref # 92075A)	92075-1690	4
BALL,STAINLESS,5/32" (Ref # 92140)	92140-1051	1
COLLAR,L=6.6 (Ref # 92143)	92143-1088	2
SPRING,FUEL TAP KNOB (Ref # 92144)	92144-1212	1
SPRING,TUBE PROTECTOR (Ref # 92144A)	92144-1722	2
DAMPER (Ref # 92160)	92160-3720	1
CLAMP (Ref # 92170)	92170-1492	8
TUBE,5X8X230 (Ref # 92190)	92190-1365	1
TUBE,"ON",FILTER-TANK (Ref # 92190A)	92190-1424	1
TUBE,"ON",TANK-TAP (Ref # 92190B)	92190-1425	1
TUBE,"RES",FILTER-TANK (Ref # 92190C)	92190-1426	1
TUBE,"RES",TANK-TAP (Ref # 92190D)	92190-1427	1
TUBE,7X10X230 (Ref # 92190E)	92190-1434	1
SCREW-PAN-CROS (Ref # 220A)	220C0508	1
WASHER-PLAIN-SMALL,6MM,BLACK (Ref # 410)	410F0600	2
TANK-COMP-FUEL,L.W.GREEN (Ref # 51001)	51001-1400-DS	1
TANK-COMP-FUEL,C.W.RED (Ref # 51001B)	51001-1400-TF	1
TANK-COMP-FUEL,L.W.GREEN (Ref # 51001E)	51001-1400-24	1
TANK-COMP-FUEL,C.W.RED (Ref # 51001G)	51001-1494-TF	1
TANK-COMP-FUEL,L.W.GREEN (Ref # 51001I)	51001-1494-24	1
SEAL,FUEL TANK CAP (Ref # 92093)	92093-1030	1