

# 2022 NINJA® 1000SX PARTS DIAGRAM

## Fuel Tank

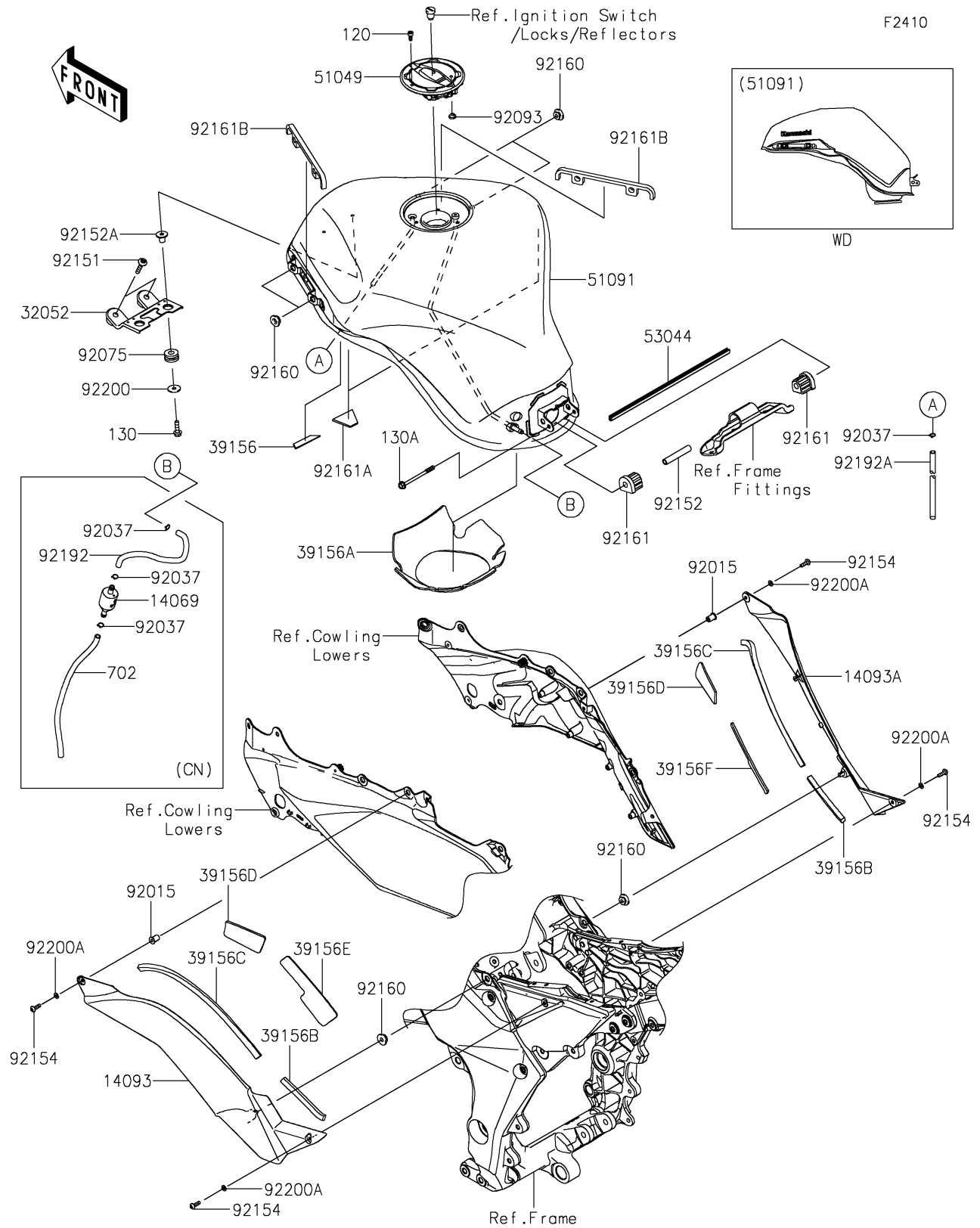

## 2022 NINJA® 1000SX PARTS LIST

### Fuel Tank

ITEM NAME	PART NUMBER	QUANTITY
BREATHER,TANK (Ref # 14069)	14069-0008	1
COVER,KNEE GRIP,LH (Ref # 14093)	14093-0529	1
COVER,KNEE GRIP,RH (Ref # 14093A)	14093-0530	1
BRACKET-TANK,F.S.BLACK (Ref # 32052)	32052-0783-18R	1
PAD,DRAIN TUBE (Ref # 39156)	39156-1770	1
PAD,FUEL PUMP (Ref # 39156A)	39156-1781	1
PAD,8X100X5 (Ref # 39156B)	39156-2150	2
PAD,8X280X10 (Ref # 39156C)	39156-2151	2
PAD,35X70X3 (Ref # 39156D)	39156-2600	2
PAD,RR,LH (Ref # 39156E)	39156-2601	1
PAD,RR,RH (Ref # 39156F)	39156-2602	1
CAP-TANK (Ref # 51049)	51049-0735	1
TANK-COMP-FUEL,M.D.BLACK (Ref # 51091)	51091-5059-17K	1
TRIM (Ref # 53044)	53044-1296	1
NUT,WELL,5MM (Ref # 92015)	92015-1757	2
CLAMP,TUBE (Ref # 92037)	92037-010	4
DAMPER,10X24X12 (Ref # 92075)	92075-1690	2
SEAL,FUEL TANK CAP (Ref # 92093)	92093-1030	1
BOLT,SOCKET,6X30 (Ref # 92151)	92151-1605	2
COLLAR,6.8X10X60 (Ref # 92152)	92152-1182	1
COLLAR,6.3X9.5X14.1 (Ref # 92152A)	92152-1847	2
BOLT,SOCKET,5X16 (Ref # 92154)	92154-0209	4
DAMPER (Ref # 92160)	92160-1613	6
DAMPER,FUEL TANK,RR (Ref # 92161)	92161-1330	2
DAMPER,30X48X3 (Ref # 92161A)	92161-1768	2
DAMPER (Ref # 92161B)	92161-1943	2
TUBE,BREATHER (Ref # 92192)	92192-0798	1
TUBE,6X9X926(30) (Ref # 92192A)	92192-1024	1
WASHER,6.5X22X1.6 (Ref # 92200)	92200-1087	2

## 2022 NINJA® 1000SX PARTS LIST

### Fuel Tank

ITEM NAME	PART NUMBER	QUANTITY
WASHER,5.2X10X1.0 (Ref # 92200A)	92200-1820	4
BOLT-SOCKET,5X12 (Ref # 120)	120CA0512	4
BOLT-FLANGED,6X22 (Ref # 130)	130BA0622	2
BOLT-FLANGED,6X70 (Ref # 130A)	130BB0670	1
TUBE-RUBBER,6X9X300 (Ref # 702)	702A06300	1