

2022 VULCAN® 900 CLASSIC LT PARTS DIAGRAM

Crankcase

E1411

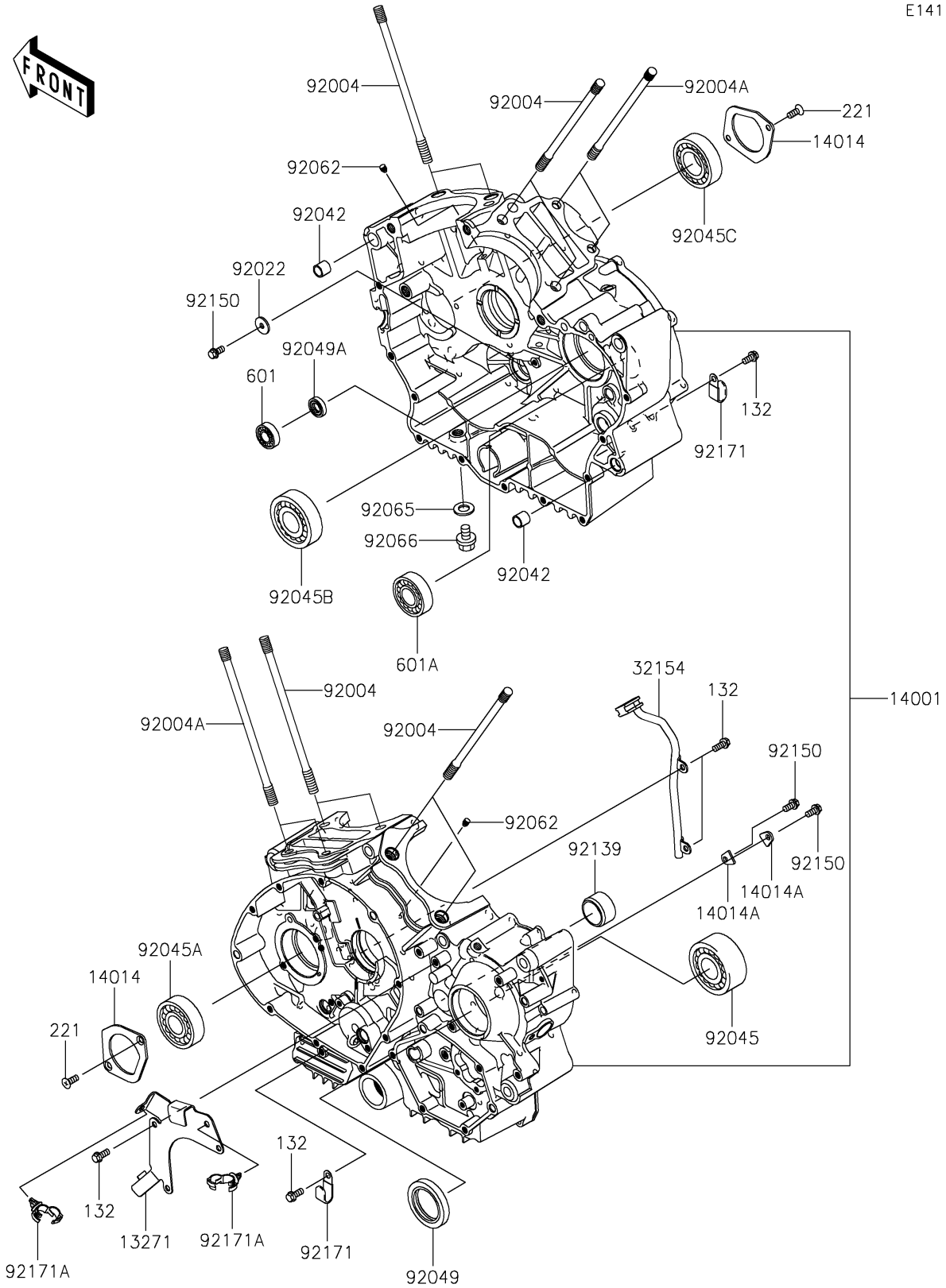

2022 VULCAN® 900 CLASSIC LT PARTS LIST

Crankcase

| ITEM NAME | PART NUMBER | QUANTITY |
|-------------------------------------|-------------|----------|
| PLATE (Ref # 13271) | 13271-0841 | 1 |
| SET-CRANKCASE (Ref # 14001) | 14001-0689 | 1 |
| PLATE-POSITION (Ref # 14014) | 14014-0024 | 2 |
| PLATE-POSITION (Ref # 14014A) | 14014-0026 | 2 |
| PIPE,OIL (Ref # 32154) | 32154-0752 | 1 |
| STUD,10X160 (Ref # 92004) | 92004-0026 | 8 |
| STUD,8X165.5 (Ref # 92004A) | 92004-0027 | 4 |
| WASHER,6X19.5X2 (Ref # 92022) | 92022-1517 | 1 |
| PIN,DOWEL,11X14X12.5 (Ref # 92042) | 92042-028 | 2 |
| BEARING-BALL,5305-A-1 (Ref # 92045) | 92045-0059 | 1 |
| BEARING-BALL,#63/22X (Ref # 92045A) | 92045-1017 | 1 |
| BEARING-BALL,TMB305 (Ref # 92045B) | 92045-1137 | 1 |
| BEARING-BALL,62/28 (Ref # 92045C) | 92045-1207 | 1 |
| SEAL-OIL,TC 38 55 8 (Ref # 92049) | 92049-0076 | 1 |
| SEAL-OIL,12X22X5 (Ref # 92049A) | 92049-0783 | 1 |
| NOZZLE,6X8,BLACK (Ref # 92062) | 92062-1079 | 2 |
| GASKET,12X22X2 (Ref # 92065) | 92065-097 | 1 |
| PLUG,12X15 (Ref # 92066) | 92066-0079 | 1 |
| BUSHING (Ref # 92139) | 92139-0139 | 1 |
| BOLT,6X12 (Ref # 92150) | 92150-1868 | 3 |
| CLAMP (Ref # 92171) | 92171-0739 | 2 |
| CLAMP,13MM DIA. (Ref # 92171A) | 92171-1415 | 2 |
| BOLT-FLANGED-SMALL,6X14 (Ref # 132) | 132BA0614 | 7 |
| SCREW-CSK-CROS,6X16 (Ref # 221) | 221AA0616 | 4 |
| BEARING-BALL (Ref # 601) | 601A6001 | 1 |
| BEARING-BALL (Ref # 601A) | 601A6204Z | 1 |