

2025 Z900RS CAFE PARTS DIAGRAM

Chassis Electrical Equipment

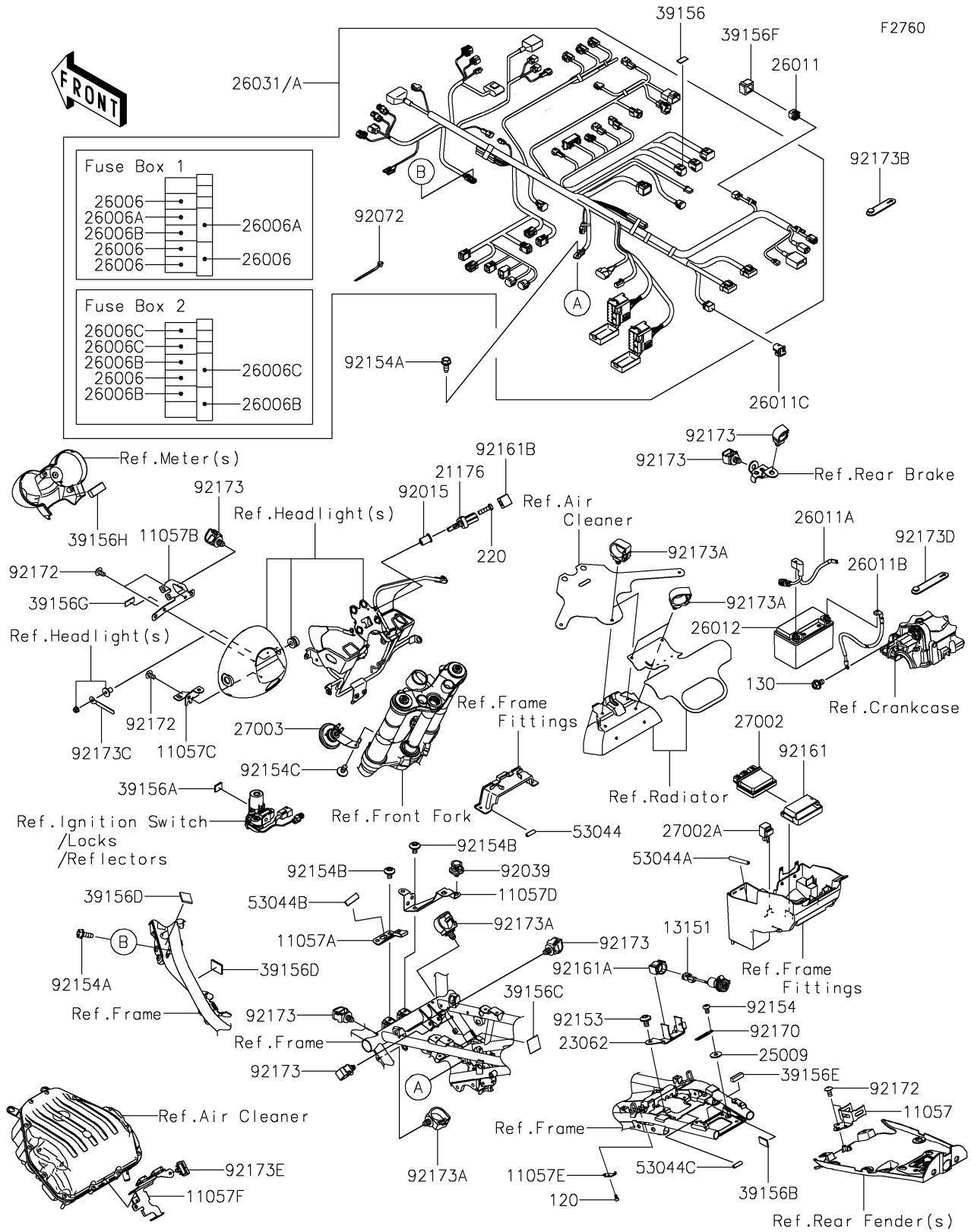

2025 Z900RS CAFE PARTS LIST

Chassis Electrical Equipment

ITEM NAME	PART NUMBER	QUANTITY
BRACKET,MAGNETIC SW. (Ref # 11057)	11057-0916	1
BRACKET,FUEL PUMP CONNECTOR (Ref # 11057A)	11057-0917	1
BRACKET,HEAD LAMP COVER,UPP (Ref # 11057B)	11057-1322	1
BRACKET,HEAD LAMP COVER,LWR (Ref # 11057C)	11057-1512	1
BRACKET,UPPER-CROSS (Ref # 11057D)	11057-3858	1
BRACKET,DIAG CONNECTOR (Ref # 11057E)	11057-7203	1
BRACKET,AIR CLEANER (Ref # 11057F)	11057-7742	1
SWITCH-COMP,DC OUTLET (Ref # 13151)	13151-0580	1
SENSOR,AIR TEMPERATURE (Ref # 21176)	21176-0048	1
BRACKET-COMP,DC SOCKET (Ref # 23062)	23062-1000	1
WASHER,5.2X16X1.2 (Ref # 25009)	25009-004	1
FUSE,MINI BLADE,15A,BLUE (Ref # 26006)	26006-0001	5
FUSE,MINI BLADE,2A,GRAY (Ref # 26006A)	26006-0052	2
FUSE,MINI BLADE,7.5A,BROWN (Ref # 26006B)	26006-0055	4
FUSE,MINI BLADE,30A,GREEN (Ref # 26006C)	26006-1080	3
WIRE-LEAD,CONNECTOR COVER (Ref # 26011)	26011-0275	1
WIRE-LEAD,BATTERY(+) (Ref # 26011A)	26011-0971	1
WIRE-LEAD,BATTERY(-) (Ref # 26011B)	26011-0972	1
WIRE-LEAD,DIAG CONNECTOR (Ref # 26011C)	26011-1901	1
BATTERY,YTX9-BS,12V 8AH (Ref # 26012)	26012-0838	1
RELAY-ASSY (Ref # 27002)	27002-0050	1
RELAY-ASSY,SIGNAL LAMP (Ref # 27002A)	27002-1097	1
HORN (Ref # 27003)	27003-0146	1
PAD,10X20X1 (Ref # 39156)	39156-2241	1
PAD,20X25X4 (Ref # 39156A)	39156-2284	1
PAD,20X40X4 (Ref # 39156B)	39156-2285	1
PAD,20X20X1 (Ref # 39156C)	39156-2288	1
PAD,30X40X4 (Ref # 39156D)	39156-2348	2
PAD,10X40X10 (Ref # 39156E)	39156-2350	1

2025 Z900RS CAFE PARTS LIST

Chassis Electrical Equipment

ITEM NAME	PART NUMBER	QUANTITY
PAD,DIAG CONNECTOR (Ref # 39156F)	39156-2361	1
PAD,15X35X1 (Ref # 39156G)	39156-2364	1
PAD,20X50X15 (Ref # 39156H)	39156-2378	1
TRIM,L=30 (Ref # 53044)	53044-0001	1
TRIM (Ref # 53044A)	53044-0018	1
TRIM,9X6.5X20 (Ref # 53044B)	53044-0596	1
TRIM,9X6.5X30 (Ref # 53044C)	53044-0632	1
NUT,WELL,5MM (Ref # 92015)	92015-1757	1
RIVET,HOLE 8MM (Ref # 92039)	92039-0014	1
BAND,OS170-FT7(BLACK) (Ref # 92072)	92072-1414	AR
BOLT,SOCKET,6X10 (Ref # 92153)	92153-1628	2
BOLT (Ref # 92154)	92154-0314	1
BOLT,FLANGED,6X16 (Ref # 92154A)	92154-0551	2
BOLT,SOCKET,6X10 (Ref # 92154B)	92154-0774	2
BOLT,SOCKET,6X12 (Ref # 92154C)	92154-2706	1
DAMPER,RELAY BOX (Ref # 92161)	92161-0203	1
DAMPER,DC SOCKET (Ref # 92161A)	92161-2069	1
DAMPER,29X29X25 (Ref # 92161B)	92161-2153	1
CLAMP (Ref # 92170)	92170-1514	1
SCREW,TAPPING,5X10 (Ref # 92172)	92172-0262	5
CLAMP,12MM DIA. (Ref # 92173)	92173-0736	7
CLAMP (Ref # 92173A)	92173-0861	6
CLAMP,RUBBER PLATE (Ref # 92173B)	92173-1229	1
CLAMP (Ref # 92173C)	92173-1306	1
CLAMP (Ref # 92173D)	92173-1526	1
CLAMP,SENSOR WIRE (Ref # 92173E)	92173-1802	1
BOLT-SOCKET,6X10 (Ref # 120)	120CA0610	1
BOLT-FLANGED,6X10 (Ref # 130)	130BA0610	1
SCREW-PAN-CROS,5X18 (Ref # 220)	220AB0518	1