

# 1996 GPZ 1100 ABS PARTS DIAGRAM

Rear Master Cylinder

F2293

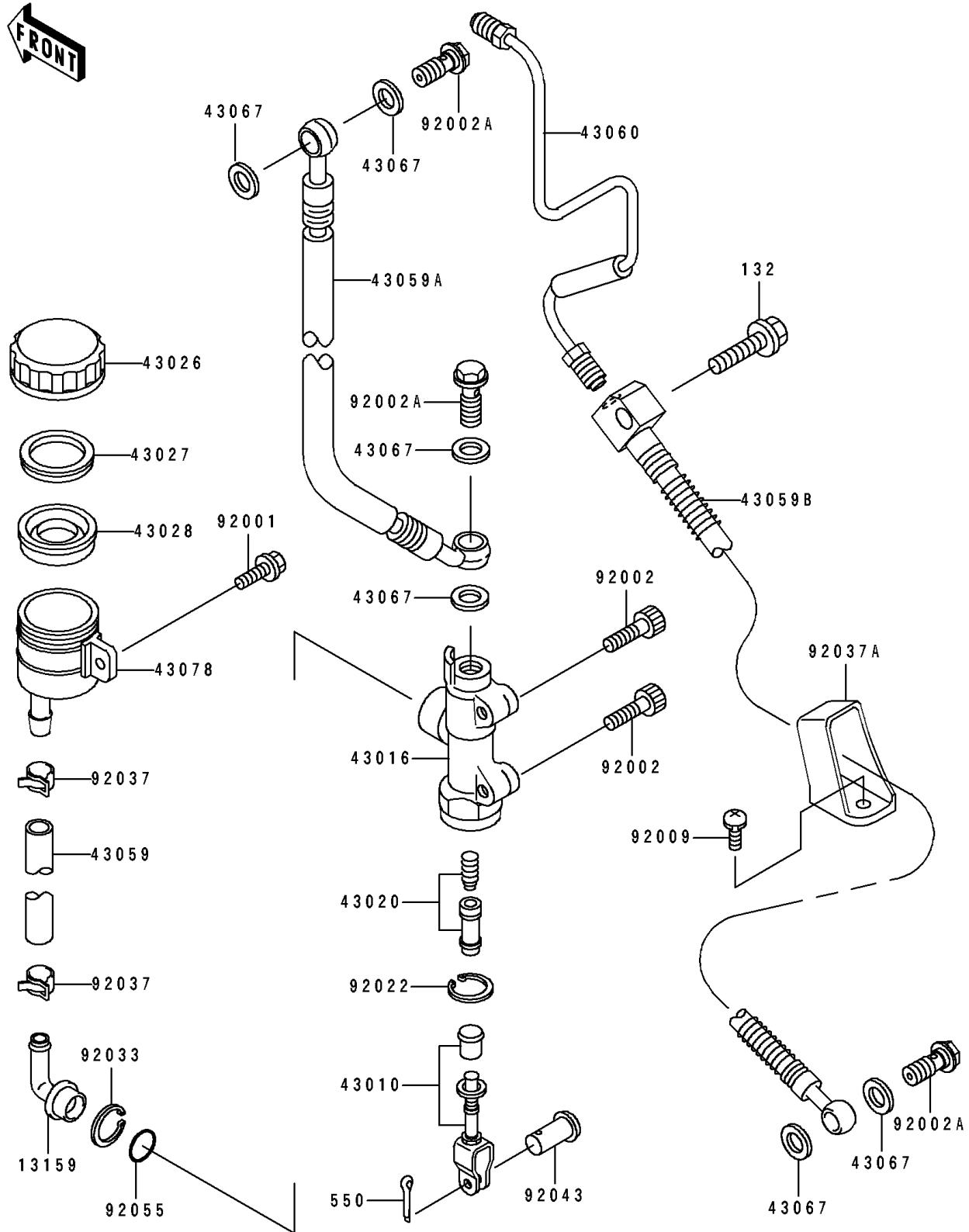

# 1996 GPZ 1100 ABS PARTS LIST

## Rear Master Cylinder

ITEM NAME	PART NUMBER	QUANTITY
CONNECTOR,RR MASTER CYLINDER (Ref # 13159)	13159-1052	1
ROD-ASSY-BRAKE (Ref # 43010)	43010-1073	1
CYLINDER-MASTER (Ref # 43016)	43016-1123	1
PISTON-COMP-BRAKE (Ref # 43020)	43020-1094	1
CAP-BRAKE (Ref # 43026)	43026-1051	1
PLATE-DIAPHRAGM (Ref # 43027)	43027-1051	1
DIAPHRAGM,MASTER CYLINDER (Ref # 43028)	43028-1057	1
HOSE-BRAKE,RR MASTER CYLINDER (Ref # 43059)	43059-1369	1
HOSE-BRAKE,RR (Ref # 43059A)	43059-1917	1
HOSE-BRAKE,RR (Ref # 43059B)	43059-1958	1
PIPE-BRAKE,RR (Ref # 43060)	43060-1107	1
WASHER,10.5X15X1.5 (Ref # 43067)	43067-001	6
RESERVOIR,RR MASTER CYLINDER (Ref # 43078)	43078-1082	1
BOLT,W/P,6X16 (Ref # 92001)	92001-1860	1
BOLT,SOCKET,8X30 (Ref # 92002)	92002-1179	2
BOLT,OIL,L=23 (Ref # 92002A)	92002-1888	3
SCREW,6X10 (Ref # 92009)	92009-1402	1
WASHER,CIRCRIP (Ref # 92022)	92022-1601	1
RING-SNAP,20.5MM (Ref # 92033)	92033-1186	1
CLAMP,BRAKE HOSE (Ref # 92037)	92037-1547	2
CLAMP,HOSE (Ref # 92037A)	92037-1896	1
PIN,8MM (Ref # 92043)	92043-1303	1
RING-O,MASTER CYLINDER (Ref # 92055)	92055-1251	1
BOLT-FLANGED-SMALL (Ref # 132)	132J0830	1
PIN-COTTER,2.0X15 (Ref # 550)	550D2015	1