

# 2023 KLR® 650 S PARTS DIAGRAM

## Rear Master Cylinder

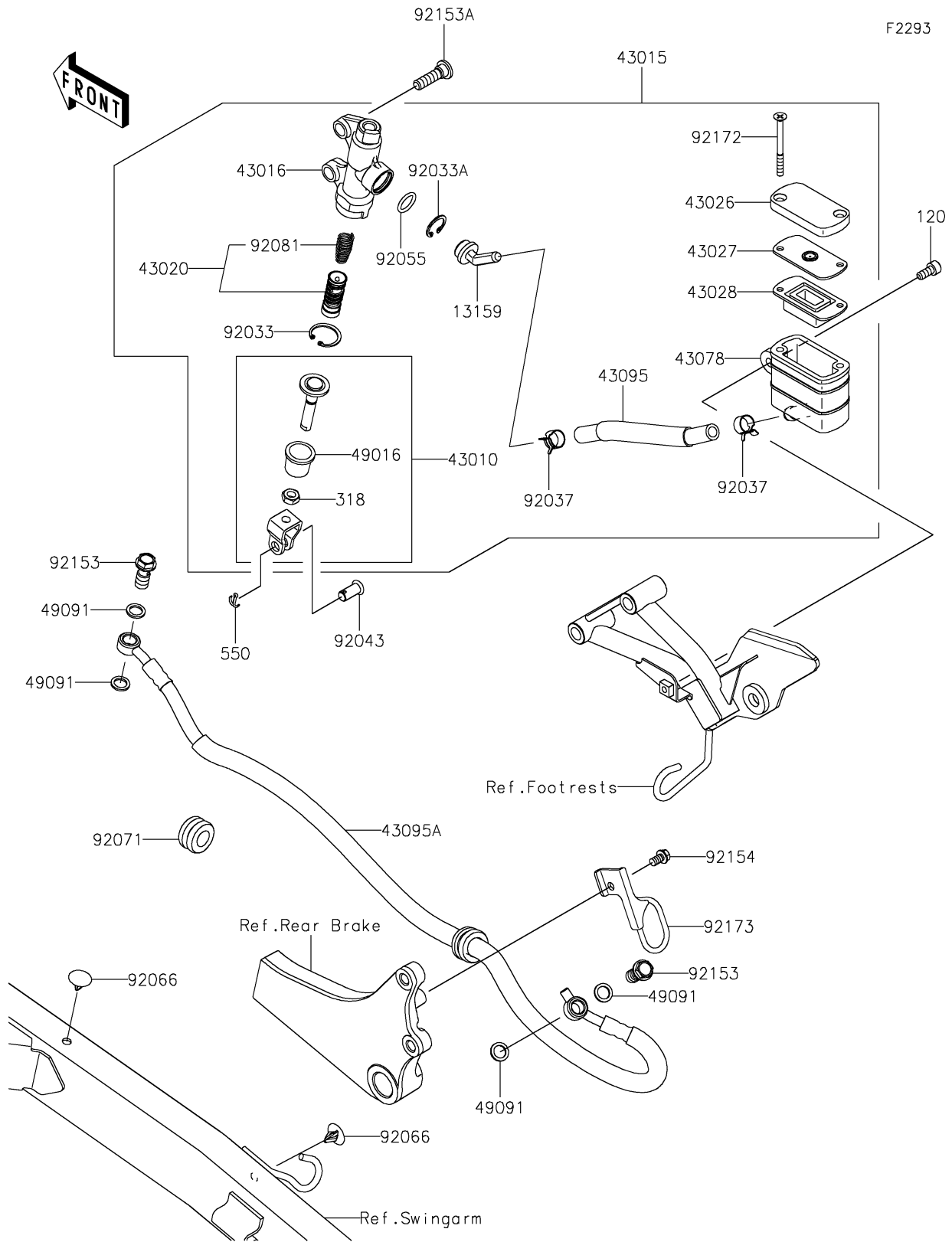

## 2023 KLR® 650 S PARTS LIST

### Rear Master Cylinder

ITEM NAME	PART NUMBER	QUANTITY
CONNECTOR (Ref # 13159)	13159-0008	1
ROD-ASSY-BRAKE (Ref # 43010)	43010-0031	1
CYLINDER-ASSY-MASTER,RR (Ref # 43015)	43015-0794	1
CYLINDER-MASTER,RR (Ref # 43016)	43016-1208	1
PISTON-COMP-BRAKE (Ref # 43020)	43020-1057	1
CAP-BRAKE (Ref # 43026)	43026-0014	1
PLATE-DIAPHRAGM (Ref # 43027)	43027-0006	1
DIAPHRAGM (Ref # 43028)	43028-0009	1
RESERVOIR (Ref # 43078)	43078-0056	1
HOSE-BRAKE (Ref # 43095)	43095-1857	1
HOSE-BRAKE,RR (Ref # 43095A)	43095-1862	1
COVER-SEAL,BRAKE PISTON (Ref # 49016)	49016-1103	1
WASHER-SEAL,10.1X14.5X1.5 (Ref # 49091)	49091-0001	4
RING-SNAP,20.9X24.6X1.2 (Ref # 92033)	92033-0079	1
RING-SNAP,20.5MM (Ref # 92033A)	92033-1186	1
CLAMP (Ref # 92037)	92037-1710	2
PIN,8X17 (Ref # 92043)	92043-0104	1
RING-O,14.8X2.4 (Ref # 92055)	92055-0741	1
PLUG (Ref # 92066)	92066-0980	2
GROMMET,15X20X16 (Ref # 92071)	92071-0056	1
SPRING,MASTER CYLINDER (Ref # 92081)	92081-1737	1
BOLT,OIL,L=23 (Ref # 92153)	92153-0627	2
BOLT,SOCKET,8X30 (Ref # 92153A)	92153-1624	2
BOLT,FLANGED,6X10 (Ref # 92154)	92154-0950	1
SCREW (Ref # 92172)	92172-0383	2
CLAMP (Ref # 92173)	92173-2454	1
BOLT-SOCKET,6X14 (Ref # 120)	120CA0614	1
NUT-HEX-SMALL,8MM (Ref # 318)	318BA0800	1
PIN-COTTER,2.0X15 (Ref # 550)	550AA2015	1