

2025 KLR650 S PARTS DIAGRAM

Rear Master Cylinder

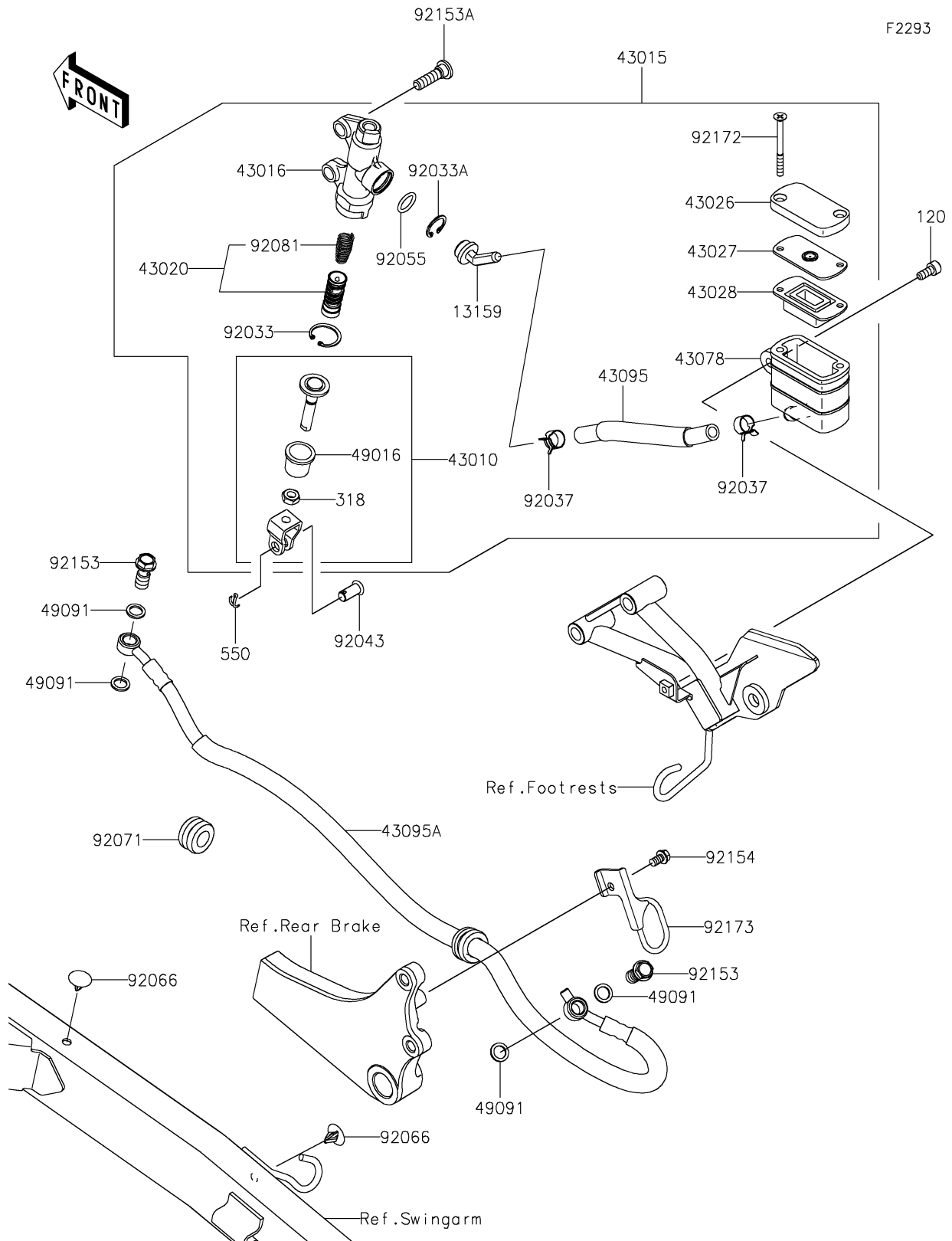

2025 KLR650 S PARTS LIST

Rear Master Cylinder

| ITEM NAME | PART NUMBER | QUANTITY |
|---|-------------|----------|
| CONNECTOR (Ref # 13159) | 13159-0008 | 1 |
| ROD-ASSY-BRAKE (Ref # 43010) | 43010-0031 | 1 |
| CYLINDER-ASSY-MASTER,RR (Ref # 43015) | 43015-0794 | 1 |
| CYLINDER-MASTER,RR (Ref # 43016) | 43016-1208 | 1 |
| PISTON-COMP-BRAKE (Ref # 43020) | 43020-1057 | 1 |
| CAP-BRAKE (Ref # 43026) | 43026-0014 | 1 |
| PLATE-DIAPHRAGM (Ref # 43027) | 43027-0006 | 1 |
| DIAPHRAGM (Ref # 43028) | 43028-0009 | 1 |
| RESERVOIR (Ref # 43078) | 43078-0056 | 1 |
| HOSE-BRAKE (Ref # 43095) | 43095-1857 | 1 |
| HOSE-BRAKE,RR (Ref # 43095A) | 43095-1862 | 1 |
| COVER-SEAL,BRAKE PISTON (Ref # 49016) | 49016-1103 | 1 |
| WASHER-SEAL,10.1X14.5X1.5 (Ref # 49091) | 49091-0001 | 4 |
| RING-SNAP,20.9X24.6X1.2 (Ref # 92033) | 92033-0079 | 1 |
| RING-SNAP,20.5MM (Ref # 92033A) | 92033-1186 | 1 |
| CLAMP (Ref # 92037) | 92037-1710 | 2 |
| PIN,8X17 (Ref # 92043) | 92043-0104 | 1 |
| RING-O,14.8X2.4 (Ref # 92055) | 92055-0741 | 1 |
| PLUG (Ref # 92066) | 92066-0980 | 2 |
| GROMMET,15X20X16 (Ref # 92071) | 92071-0056 | 1 |
| SPRING,MASTER CYLINDER (Ref # 92081) | 92081-1737 | 1 |
| BOLT,OIL,L=23 (Ref # 92153) | 92153-0627 | 2 |
| BOLT,SOCKET,8X30 (Ref # 92153A) | 92153-1624 | 2 |
| BOLT,FLANGED,6X10 (Ref # 92154) | 92154-0950 | 1 |
| SCREW (Ref # 92172) | 92172-0383 | 2 |
| CLAMP (Ref # 92173) | 92173-2454 | 1 |
| BOLT-SOCKET,6X14 (Ref # 120) | 120CA0614 | 1 |
| NUT-HEX-SMALL,8MM (Ref # 318) | 318BA0800 | 1 |
| PIN-COTTER,2.0X15 (Ref # 550) | 550AA2015 | 1 |