

# 2025 Eliminator PARTS DIAGRAM

Fuel Tank

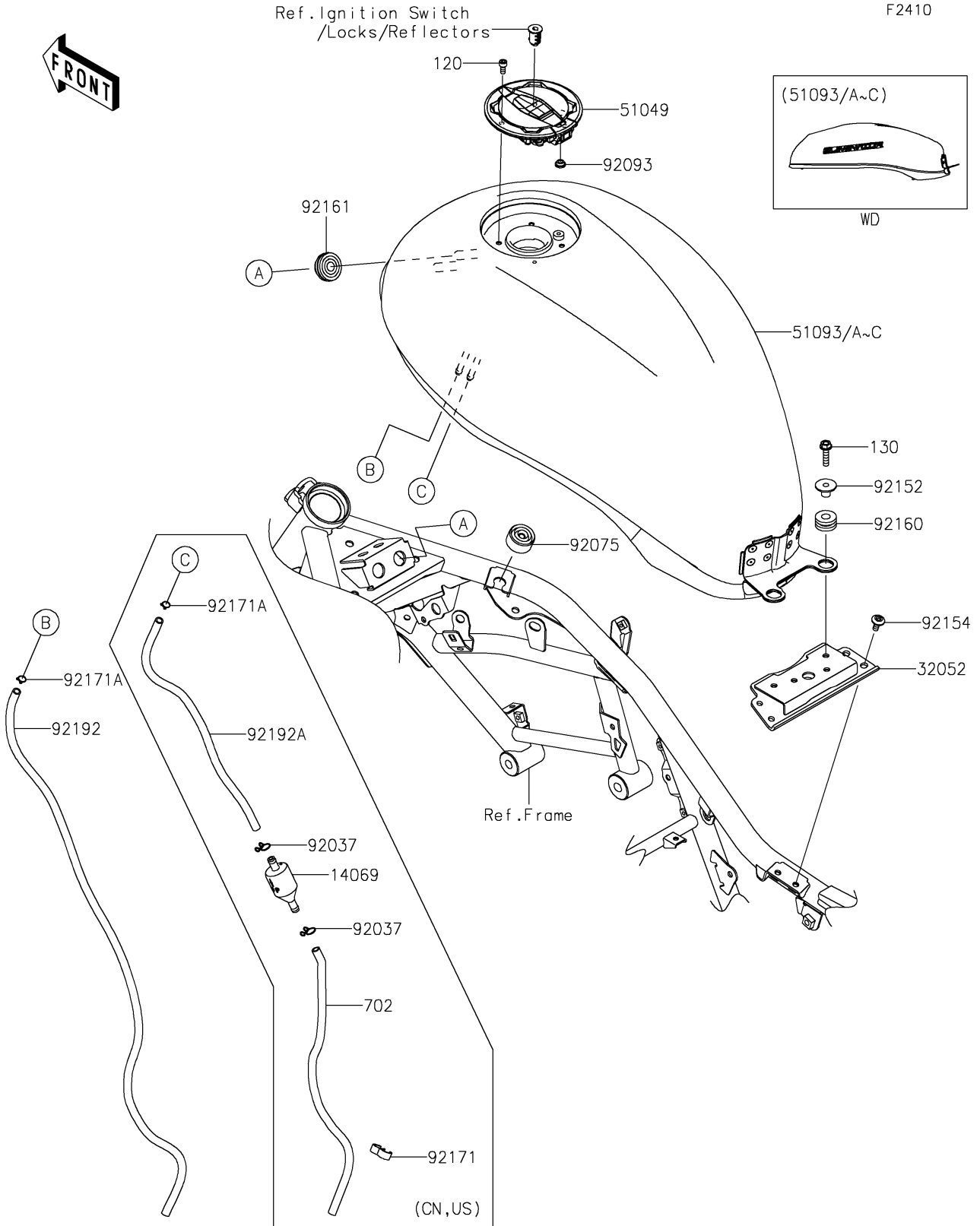

## 2025 Eliminator PARTS LIST

### Fuel Tank

| ITEM NAME                                | PART NUMBER    | QUANTITY |
|--|----------------|----------|
| BRACKET-TANK (Ref # 32052)               | 32052-0854     | 1        |
| CAP-TANK,FUEL (Ref # 51049)              | 51049-0756     | 1        |
| TANK-COMP-FUEL,M.F.S.BLACK (Ref # 51093) | 51093-5119-739 | 1        |
| TANK-COMP-FUEL,P.S.KHAKI (Ref # 51093C)  | 51093-5364-63F | 1        |
| DAMPER (Ref # 92075)                     | 92075-015      | 2        |
| SEAL,FUEL TANK CAP (Ref # 92093)         | 92093-1030     | 1        |
| COLLAR,6.5X10X13.6 (Ref # 92152)         | 92152-2204     | 2        |
| BOLT,SOCKET,6X14 (Ref # 92154)           | 92154-0932     | 4        |
| DAMPER (Ref # 92160)                     | 92160-1162     | 2        |
| DAMPER,10X32X8 (Ref # 92161)             | 92161-1791     | 2        |
| CLAMP,8X0.7 (Ref # 92171A)               | 92171-1973     | 1        |
| TUBE,DRAIN (Ref # 92192)                 | 92192-2612     | 1        |
| BOLT-SOCKET,5X12 (Ref # 120)             | 120CA0512      | 4        |
| BOLT-FLANGED,6X25 (Ref # 130)            | 130CC0625      | 2        |
| BREATHER,FUEL TANK (Ref # 14069)         | 14069-1004     | 1        |
| CLAMP,TUBE (Ref # 92037)                 | 92037-147      | 2        |
| CLAMP (Ref # 92171)                      | 92171-1184     | 1        |
| CLAMP,8X0.7 (Ref # 92171A)               | 92171-1973     | 2        |
| TUBE,6X9X320 (Ref # 92192A)              | 92192-2661     | 1        |
| TUBE-RUBBER,6X9X360 (Ref # 702)          | 702A06360      | 1        |