

# 2002 ZZR1200 PARTS DIAGRAM

Engine Cover(s)

E1431

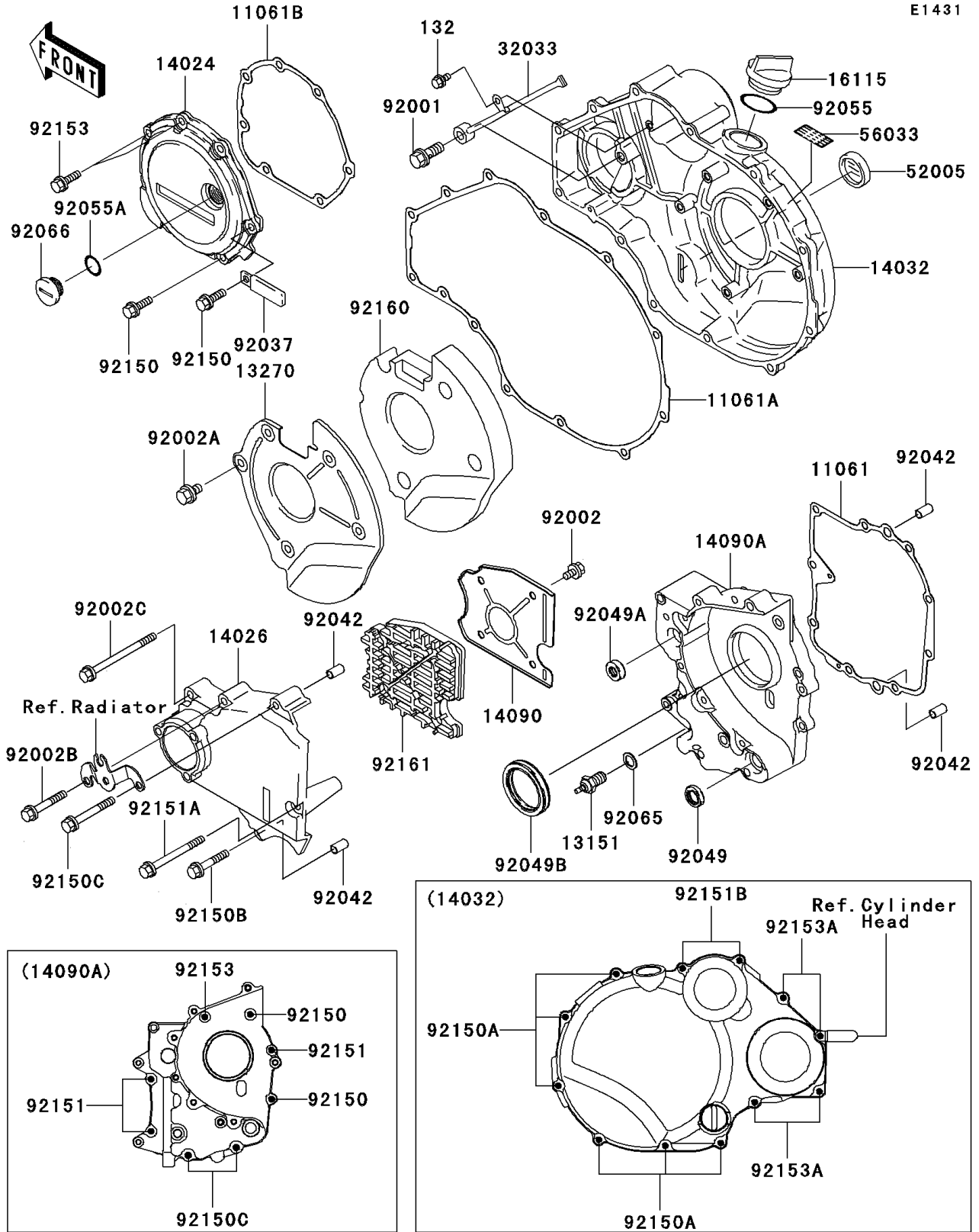

## 2002 ZZR1200 PARTS LIST

### Engine Cover(s)

ITEM NAME	PART NUMBER	QUANTITY
BOLT-FLANGED-SMALL (Ref # 132)	132H0510	1
GASKET,TRANSMISSION COVER (Ref # 11061)	11061-1093	1
GASKET,CLUTCH COVER (Ref # 11061A)	11061-1154	1
GASKET,PULSING COVER (Ref # 11061B)	11061-1155	1
SWITCH-COMP,NEUTRAL (Ref # 13151)	13151-1080	1
PLATE (Ref # 13270)	13270-1765	1
COVER,PULSING (Ref # 14024)	14024-1721	1
COVER-CHAIN (Ref # 14026)	14026-1213	1
COVER-CLUTCH (Ref # 14032)	14032-1530	1
COVER,SOUND ARRESTER (Ref # 14090)	14090-1527	1
COVER,TRANSMISSION (Ref # 14090A)	14090-1877	1
CAP-OIL FILLER (Ref # 16115)	16115-1009	1
PIPE,CLUTCH COVER (Ref # 32033)	32033-1204	1
GAUGE,OIL LEVEL (Ref # 52005)	52005-1057	1
LABEL-MANUAL,OIL CAPACITY (Ref # 56033)	56033-1292	1
BOLT,BANJO,8X20 (Ref # 92001)	92001-1855	1
BOLT,6X10 (Ref # 92002)	92002-1449	4
BOLT,6X10 (Ref # 92002A)	92002-1541	5
BOLT,6X40 (Ref # 92002B)	92002-1566	1
BOLT,6X80 (Ref # 92002C)	92002-1568	1
CLAMP,L=60 (Ref # 92037)	92037-1069	1
PIN,DOWEL,6.3X8X14 (Ref # 92042)	92042-007	4
SEAL-OIL (Ref # 92049)	92049-1564	1
SEAL-OIL (Ref # 92049A)	92049-1566	1
SEAL-OIL (Ref # 92049B)	92049-1567	1
RING-O,31.7X2.4 (Ref # 92055)	92055-049	1
RING-O (Ref # 92055A)	92055-1146	1
GASKET,10.5X16X1 (Ref # 92065)	92065-058	1
PLUG,COVER (Ref # 92066)	92066-1163	1

## 2002 ZZR1200 PARTS LIST

### Engine Cover(s)

ITEM NAME	PART NUMBER	QUANTITY
BOLT,6X20 (Ref # 92150)	92150-1010	7
BOLT,6X25 (Ref # 92150A)	92150-1779	6
BOLT,6X35 (Ref # 92150B)	92150-1967	1
BOLT,6X50 (Ref # 92150C)	92150-1968	3
BOLT,6X25 (Ref # 92151)	92151-1190	3
BOLT,6X65 (Ref # 92151A)	92151-1191	1
BOLT,6X55 (Ref # 92151B)	92151-1341	2
BOLT,M6X20 (Ref # 92153)	92153-1114	3
BOLT,M6X40 (Ref # 92153A)	92153-1190	4
DAMPER (Ref # 92160)	92160-1812	1
DAMPER,SOUND ARRESTER (Ref # 92161)	92161-1304	1