

# 1996 Ninja® 600R PARTS DIAGRAM

Gear Change Drum/Shift Fork(s)

E1362-0103

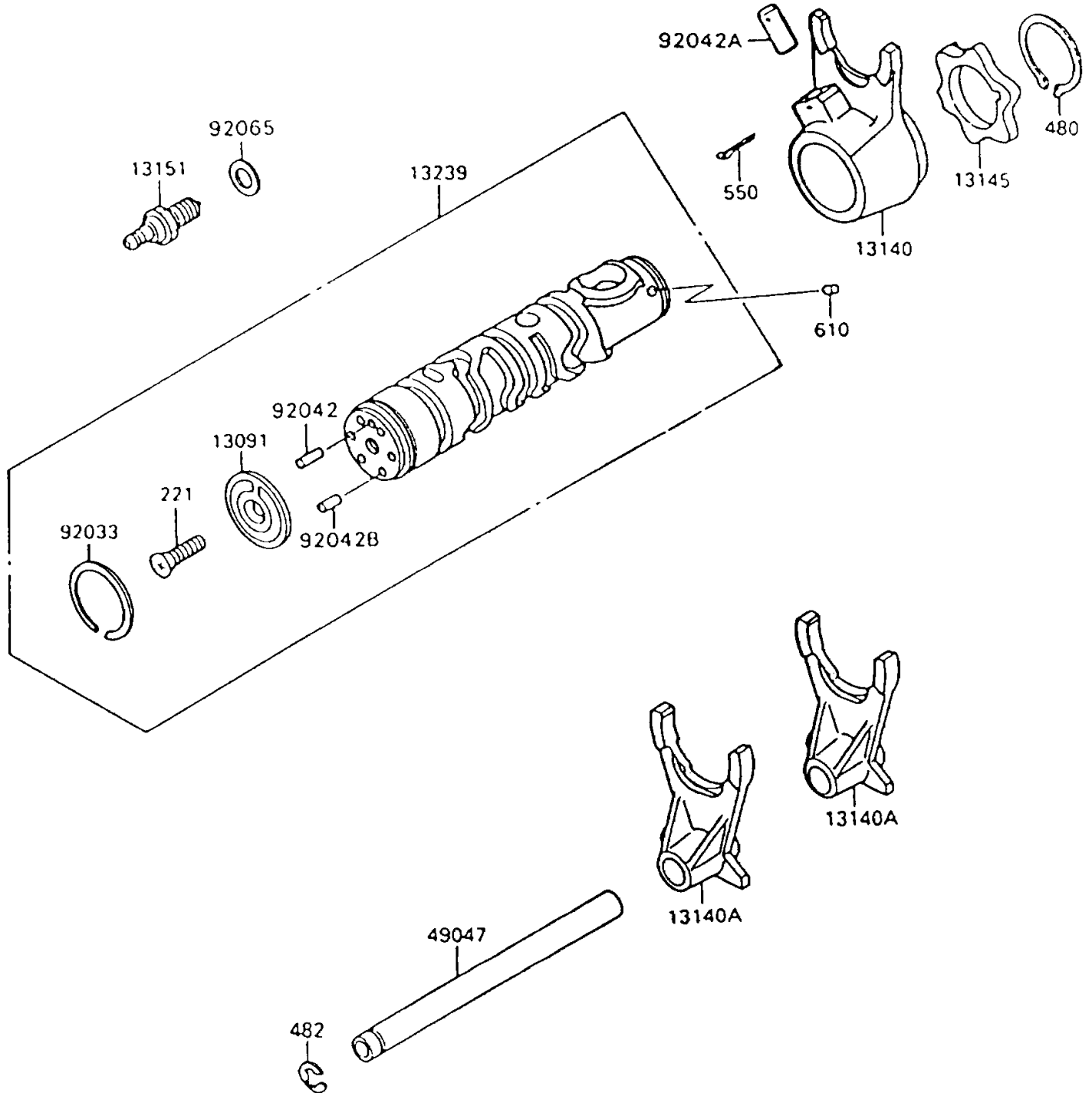

# 1996 Ninja® 600R PARTS LIST

## Gear Change Drum/Shift Fork(s)

| ITEM NAME                                 | PART NUMBER | QUANTITY |
|---|-------------|----------|
| HOLDER,CHANGE DRUM PIN (Ref # 13091)      | 13091-1104  | 1        |
| FORK-SHIFT,DRIVE (Ref # 13140)            | 13140-1016  | 1        |
| FORK-SHIFT,OUTPUT (Ref # 13140A)          | 13140-1062  | 2        |
| CAM-CHANGE DRUM (Ref # 13145)             | 13145-1058  | 1        |
| SWITCH-COMP,NEUTRAL (Ref # 13151)         | 13151-1080  | 1        |
| DRUM-ASSY-CHANGE (Ref # 13239)            | 13239-1119  | 1        |
| ROD-SHIFT (Ref # 49047)                   | 49047-1069  | 1        |
| RING-SNAP,37MM (Ref # 92033)              | 92033-035   | 1        |
| PIN,DOWEL,4X15.8 (Ref # 92042)            | 92042-014   | 1        |
| PIN,DOWEL,8X18 (Ref # 92042A)             | 92042-021   | 1        |
| PIN,DOWEL,4X13.8 (Ref # 92042B)           | 92042-030   | 5        |
| GASKET,10.5X16X1,DRAIN PLUG (Ref # 92065) | 92065-058   | 1        |
| SCREW-CSK-CROS,6X20 (Ref # 221)           | 221B0620    | 1        |
| CIRCLIP-TYPE-C,30MM (Ref # 480)           | 480J3000    | 1        |
| CIRCLIP-TYPE-E,10MM (Ref # 482)           | 482J0100    | 1        |
| PIN-COTTER,3.0X20 (Ref # 550)             | 550D3020    | 1        |
| ROLLER,4X6 (Ref # 610)                    | 610A0406    | 1        |