

1991 Ninja® ZX™-6 PARTS DIAGRAM

Side Cover/Chain Case(ZX600-D2/D3)

F2610

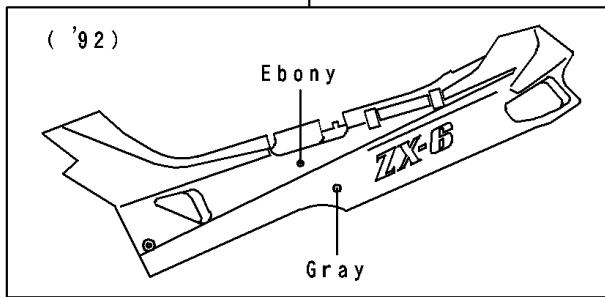
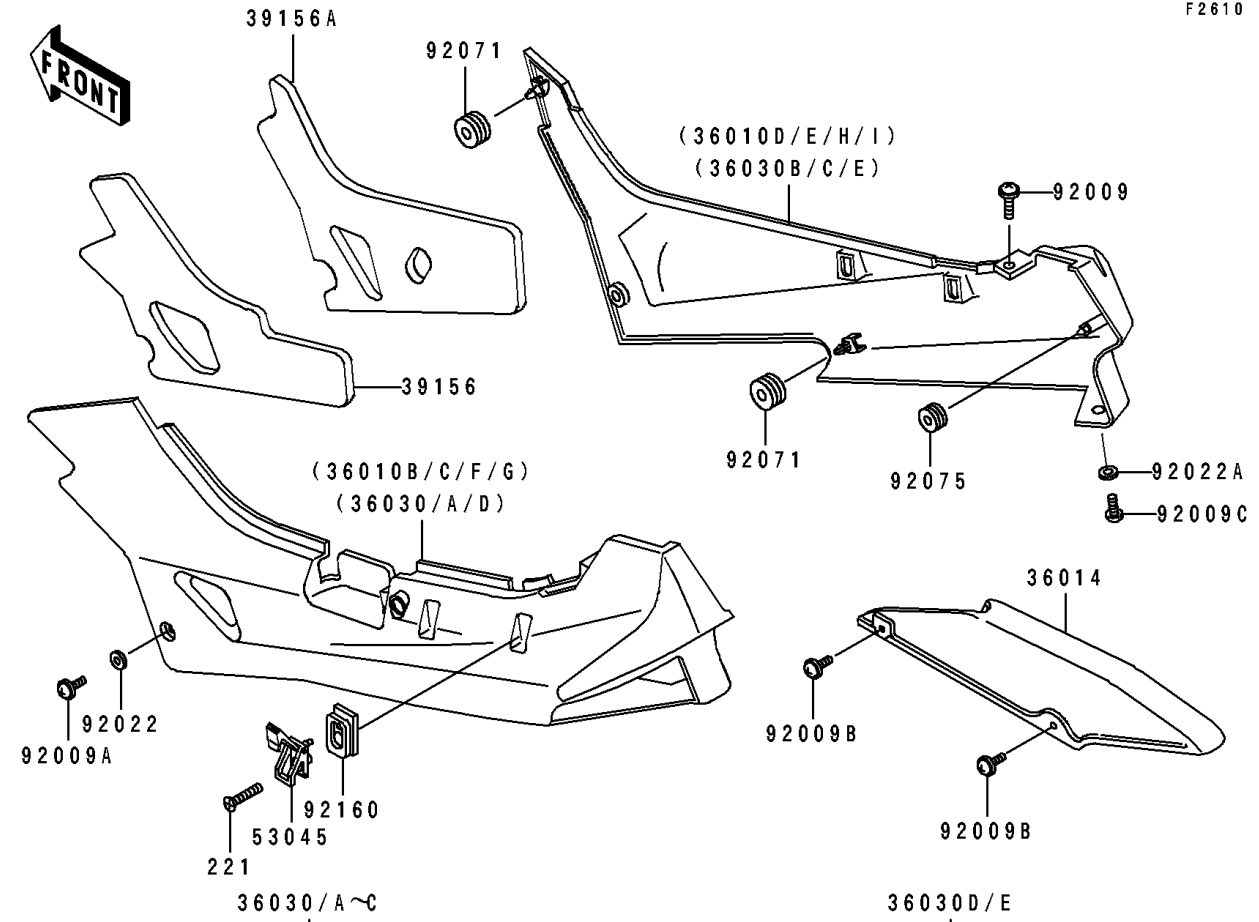

36010B~E

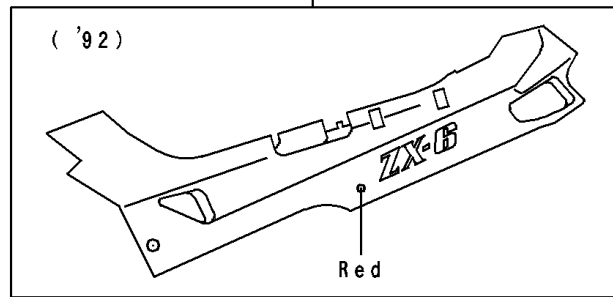

36010F~I

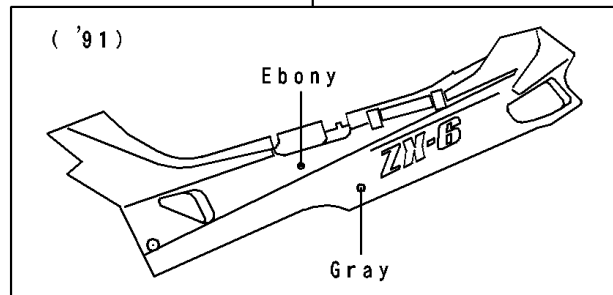
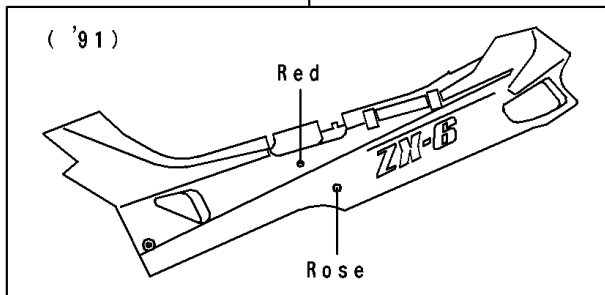

1991 Ninja® ZX™ -6 PARTS LIST

Side Cover/Chain Case(ZX600-D2/D3)

ITEM NAME	PART NUMBER	QUANTITY
COVER-SIDE,LH,RED/ROSE OPERA (Ref # 36010B)	36010-5370-HF	1
COVER-SIDE,LH,RED/ROSE OPERA (Ref # 36010C)	36010-5370-HP	1
COVER-SIDE,RH,RED/ROSE OPERA (Ref # 36010D)	36010-5371-HF	1
COVER-SIDE,RH,RED/ROSE OPERA (Ref # 36010E)	36010-5371-HP	1
COVER-SIDE,LH,EBONY/GRAY (Ref # 36010F)	36010-5426-JP	1
COVER-SIDE,LH,EBONY/GRAY (Ref # 36010G)	36010-5426-T4	1
COVER-SIDE,RH,EBONY/GRAY (Ref # 36010H)	36010-5427-JP	1
COVER-SIDE,RH,EBONY/GRAY (Ref # 36010I)	36010-5427-T4	1
CASE-CHAIN (Ref # 36014)	36014-1164	1
PAD,SIDE COVER,LH (Ref # 39156)	39156-1202	1
PAD,SIDE COVER,RH (Ref # 39156A)	39156-1203	1
HOOK-ASSY,TOOL BOX (Ref # 53045)	53045-1053	4
SCREW,6X18,BLACK (Ref # 92009)	92009-1181	2
SCREW,6X14 (Ref # 92009A)	92009-1288	2
SCREW,6X10 (Ref # 92009B)	92009-1402	2
SCREW,5X16 (Ref # 92009C)	92009-1654	2
WASHER,6.5X16X1 (Ref # 92022)	92022-1143	2
WASHER,NYLON,5.3X11.5X1.5 (Ref # 92022A)	92022-1521	2
GROMMET (Ref # 92071)	92071-056	4
DAMPER (Ref # 92075)	92075-1629	2
DAMPER,ROPE HOOK (Ref # 92160)	92160-1042	4
SCREW-CSK-CROS (Ref # 221)	221E0625	4