

# 2025 MULE PRO-FXT 1000 LE PARTS DIAGRAM

Engine Cover(s)

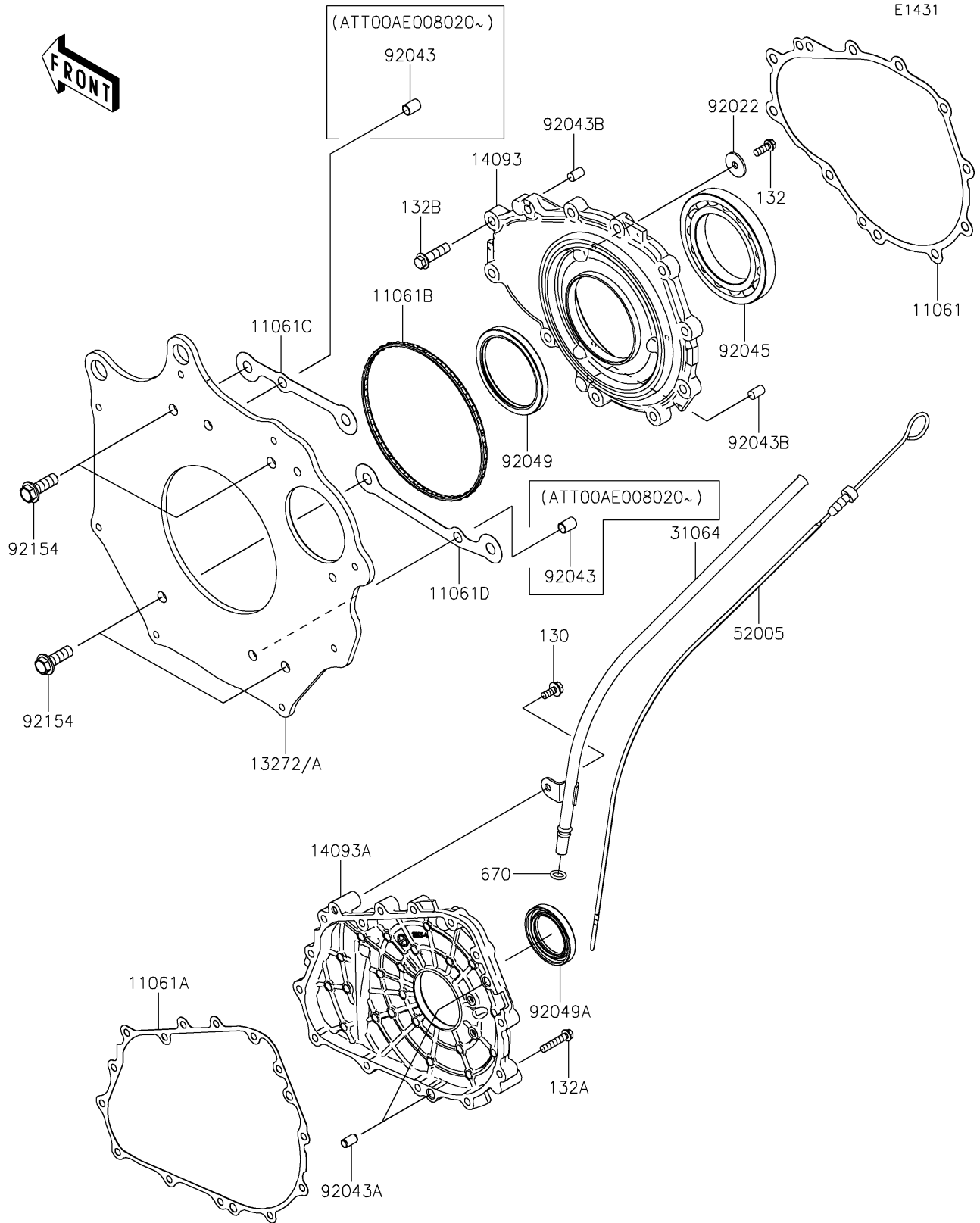

## 2025 MULE PRO-FXT 1000 LE PARTS LIST

### Engine Cover(s)

| ITEM NAME                              | PART NUMBER | QUANTITY |
|--|-------------|----------|
| GASKET,CLUTCH COVER (Ref # 11061)      | 11061-1305  | 1        |
| GASKET,CRANKCASE COVER (Ref # 11061A)  | 11061-1461  | 1        |
| GASKET,COVER-BACK PLATE (Ref # 11061B) | 11061-1462  | 1        |
| GASKET,CRANKCASE UPPER (Ref # 11061C)  | 11061-1533  | 1        |
| GASKET,CRANKCASE LOWER (Ref # 11061D)  | 11061-1534  | 1        |
| PLATE,CLUTCH COVER,BACK (Ref # 13272)  | 13272-4106  | 1        |
| PLATE,CLUTCH COVER,BACK (Ref # 13272A) | 13272-4346  | 1        |
| COVER,CRANKCASE LH (Ref # 14093)       | 14093-1385  | 1        |
| COVER,CRANKCASE RH (Ref # 14093A)      | 14093-1386  | 1        |
| PIPE-COMP (Ref # 31064)                | 31064-0753  | 1        |
| GAUGE,OIL (Ref # 52005)                | 52005-0783  | 1        |
| WASHER,6.5X24X2 (Ref # 92022)          | 92022-1690  | 3        |
| PIN,DOWEL,10X14 (Ref # 92043)          | 92043-1037  | 2        |
| PIN,6.2X8X14 (Ref # 92043A)            | 92043-1263  | 2        |
| PIN,8X14 (Ref # 92043B)                | 92043-1567  | 2        |
| BEARING-BALL,16014CS45 (Ref # 92045)   | 92045-0709  | 1        |
| SEAL-OIL (Ref # 92049)                 | 92049-0869  | 1        |
| SEAL-OIL (Ref # 92049A)                | 92049-0875  | 1        |
| BOLT-FLANGED,10X30 (Ref # 92154)       | 92154-7039  | 4        |
| BOLT-FLANGED,6X14 (Ref # 130)          | 130BA0614   | 1        |
| BOLT-FLANGED-SMALL,6X16 (Ref # 132)    | 132BA0616   | 3        |
| BOLT-FLANGED-SMALL,6X30 (Ref # 132A)   | 132BA0630   | 14       |
| BOLT-FLANGED-SMALL,8X30 (Ref # 132B)   | 132BA0830   | 11       |
| O RING,10MM (Ref # 670)                | 670D2010    | 1        |