

2024 MULE PRO-FXT™ 1000 LE CAMO PARTS DIAGRAM

Engine Cover(s)

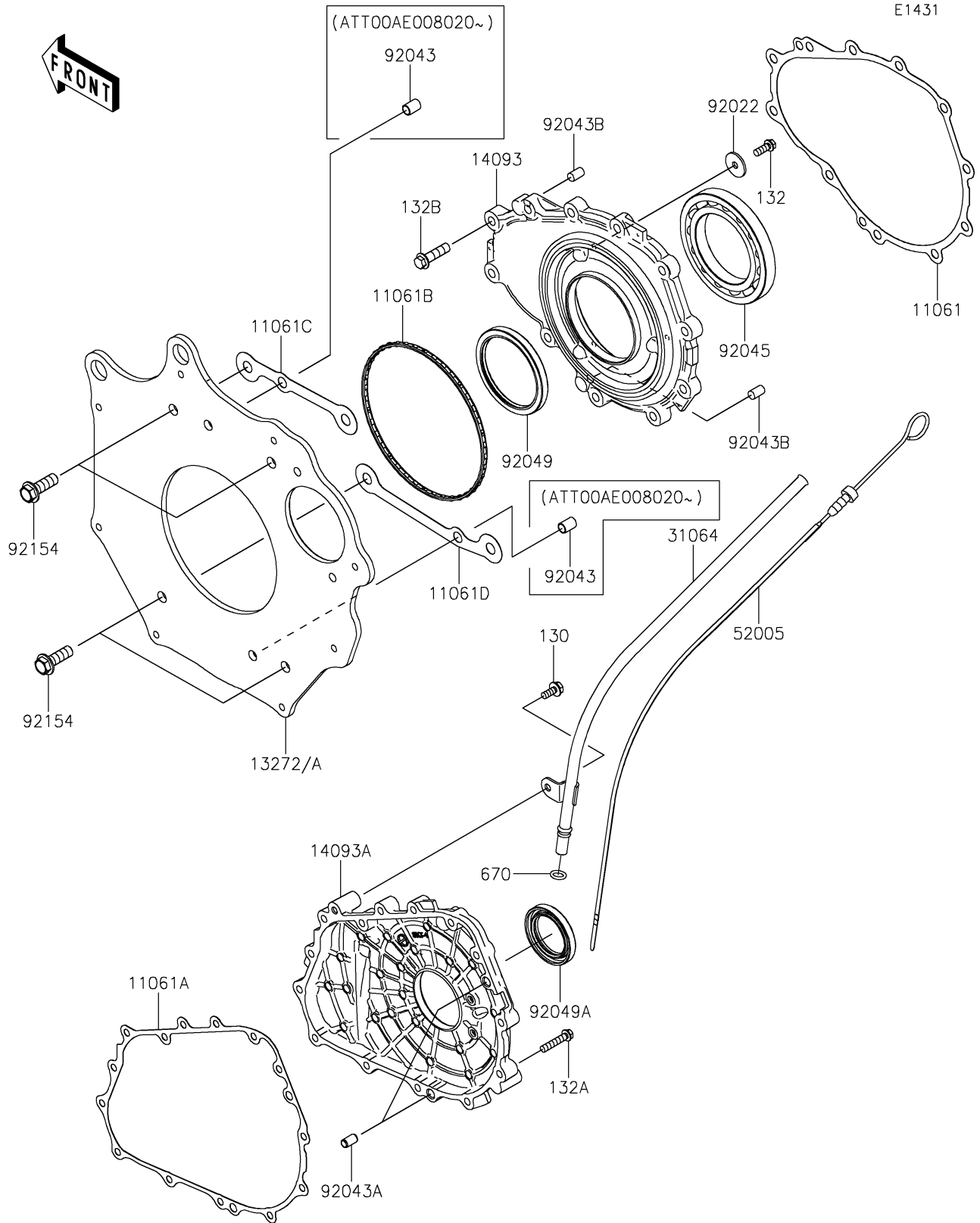

2024 MULE PRO-FXT™ 1000 LE CAMO PARTS LIST

Engine Cover(s)

ITEM NAME	PART NUMBER	QUANTITY
GASKET,CLUTCH COVER (Ref # 11061)	11061-1305	1
GASKET,CRANKCASE COVER (Ref # 11061A)	11061-1461	1
GASKET,COVER-BACK PLATE (Ref # 11061B)	11061-1462	1
GASKET,CRANKCASE UPPER (Ref # 11061C)	11061-1533	1
GASKET,CRANKCASE LOWER (Ref # 11061D)	11061-1534	1
PLATE,CLUTCH COVER,BACK (Ref # 13272)	13272-4106	1
PLATE,CLUTCH COVER,BACK (Ref # 13272A)	13272-4346	1
COVER,CRANKCASE LH (Ref # 14093)	14093-1385	1
COVER,CRANKCASE RH (Ref # 14093A)	14093-1386	1
PIPE-COMP (Ref # 31064)	31064-0753	1
GAUGE,OIL (Ref # 52005)	52005-0783	1
WASHER,6.5X24X2 (Ref # 92022)	92022-1690	3
PIN,DOWEL,10X14 (Ref # 92043)	92043-1037	2
PIN,6.2X8X14 (Ref # 92043A)	92043-1263	2
PIN,8X14 (Ref # 92043B)	92043-1567	2
BEARING-BALL,16014CS45 (Ref # 92045)	92045-0709	1
SEAL-OIL (Ref # 92049)	92049-0869	1
SEAL-OIL (Ref # 92049A)	92049-0875	1
BOLT-FLANGED,10X30 (Ref # 92154)	92154-7039	4
BOLT-FLANGED,6X14 (Ref # 130)	130BA0614	1
BOLT-FLANGED-SMALL,6X16 (Ref # 132)	132BA0616	3
BOLT-FLANGED-SMALL,6X30 (Ref # 132A)	132BA0630	14
BOLT-FLANGED-SMALL,8X30 (Ref # 132B)	132BA0830	11
O RING,10MM (Ref # 670)	670D2010	1