

# 2004 ZZR600 PARTS DIAGRAM

## Air Cleaner

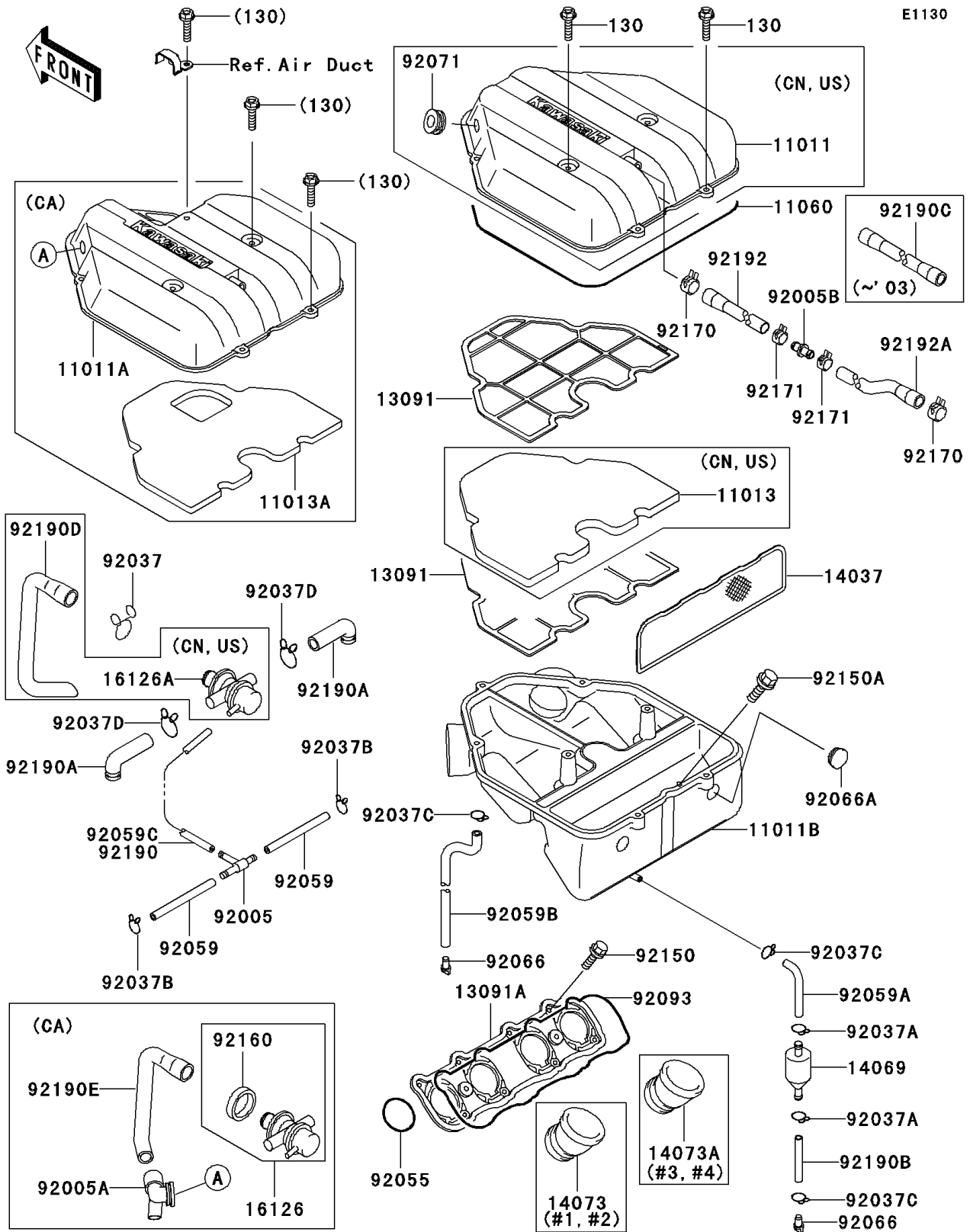

E1130

## 2004 ZZR600 PARTS LIST

### Air Cleaner

ITEM NAME	PART NUMBER	QUANTITY
CASE-AIR FILTER,LWR (Ref # 11011B)	11011-1633	1
GASKET,AIR FILTER CASE (Ref # 11060)	11060-1317	1
HOLDER,ELEMENT (Ref # 13091)	13091-1815	2
HOLDER,DUCT (Ref # 13091A)	13091-1816	1
SCREEN,AIR FILTER (Ref # 14037)	14037-1165	1
BREATHER (Ref # 14069)	14069-1051	1
DUCT,CARBURETOR,#1&#2 (Ref # 14073)	14073-1562	2
DUCT,CARBURETOR,#3&#4 (Ref # 14073A)	14073-1563	2
FITTING,TUBE,T-TYPE (Ref # 92005)	92005-1017	1
FITTING (Ref # 92005B)	92005-1379	1
CLAMP,TUBE (Ref # 92037)	92037-1076	1
CLAMP,FUEL TUBE (Ref # 92037A)	92037-1271	2
CLAMP (Ref # 92037B)	92037-1712	2
CLAMP,TUBE (Ref # 92037C)	92037-1972	4
CLAMP,TUBE (Ref # 92037D)	92037-213	2
RING-O,67.7X3.1 (Ref # 92055)	92055-1434	4
TUBE,4X9X80 (Ref # 92059)	92059-1365	2
TUBE,7X12X230 (Ref # 92059A)	92059-1750	1
TUBE,7X12X435,GREEN (Ref # 92059B)	92059-1761	2
PLUG,DRAIN (Ref # 92066)	92066-1211	3
PLUG (Ref # 92066A)	92066-1389	2
SEAL,DUCT HOLDER (Ref # 92093)	92093-1346	1
BOLT,5X12 (Ref # 92150)	92150-1661	8
BOLT-FLANGED,6X25 (Ref # 130)	130H0625	7
BOLT,6X20 (Ref # 92150A)	92150-1662	2
CLAMP (Ref # 92170)	92170-1060	2
CLAMP (Ref # 92171)	92171-0332	2
TUBE,AIR SWITCH VALVE (Ref # 92190A)	92190-1168	2
TUBE,7X12X45 (Ref # 92190B)	92190-1200	1

## 2004 ZZR600 PARTS LIST

### Air Cleaner

ITEM NAME	PART NUMBER	QUANTITY
TUBE (Ref # 92192)	92192-0118	1
TUBE (Ref # 92192A)	92192-0119	1
CASE-AIR FILTER,UPP (Ref # 11011)	11011-1395	1
CASE-AIR FILTER,UPP (Ref # 11011A)	11011-1412	1
ELEMENT-AIR FILTER (Ref # 11013)	11013-1226	1
ELEMENT-AIR FILTER (Ref # 11013A)	11013-1230	1
VALVE,AIR SWITCH (Ref # 16126)	16126-1144	1
VALVE,AIR SWITCH (Ref # 16126A)	16126-1277	1
FITTING,CANISTER (Ref # 92005A)	92005-1253	1
TUBE,4X9X136 (Ref # 92059C)	92059-1956	1
GROMMET,AIR FILTER (Ref # 92071)	92071-1028	1
DAMPER,VALVE (Ref # 92160)	92160-1454	1
TUBE,4X9X220 (Ref # 92190)	92190-1091	1
TUBE,VALVE-AIR FILTER (Ref # 92190D)	92190-1416	1
TUBE,AIR SWITCH-FITTING (Ref # 92190E)	92190-1435	1