

# 1996 Ninja® ZX™ -6 PARTS DIAGRAM

Carburetor

E1611

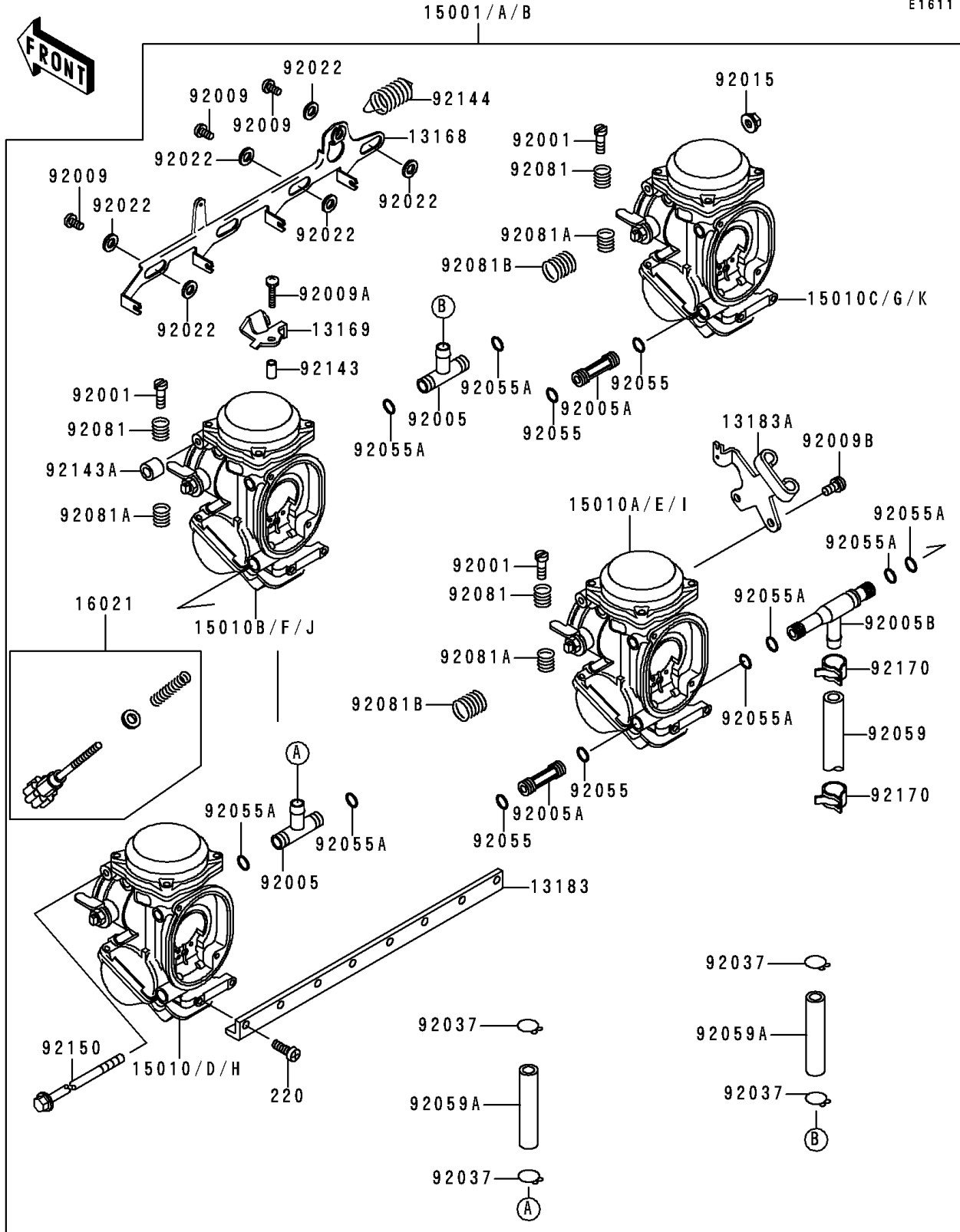

# 1996 Ninja® ZX™-6 PARTS LIST

## Carburetor

ITEM NAME	PART NUMBER	QUANTITY
LEVER,STARTER (Ref # 13168)	13168-1462	1
PLATE,STARTER CABLE (Ref # 13169)	13169-1965	1
PLATE,CARBURETOR STAY (Ref # 13183)	13183-1608	1
PLATE,THROTTLE CABLE (Ref # 13183A)	13183-1610	1
SCREW-THROTTLE STOP (Ref # 16021)	16021-1160	1
BOLT,THROTTLE ADJUST (Ref # 92001)	92001-1998	3
FITTING,T-TYPE (Ref # 92005)	92005-1125	2
FITTING (Ref # 92005A)	92005-1157	2
SCREW-PAN-CROS,5X14 (Ref # 220)	220D0514	8
FITTING,T-TYPE (Ref # 92005B)	92005-1214	1
SCREW (Ref # 92009)	92009-1262	3
SCREW,4X18 (Ref # 92009A)	92009-1446	1
SCREW (Ref # 92009B)	92009-1597	1
NUT,FLANGED,5MM (Ref # 92015)	92015-1259	1
WASHER,6.1X11X0.8,POLYACETAL (Ref # 92022)	92022-1199	6
CLAMP,TUBE (Ref # 92037)	92037-1531	4
RING-O (Ref # 92055)	92055-1004	4
RING-O,FUEL FITTING (Ref # 92055A)	92055-1223	8
TUBE,7.3X12.5X240 (Ref # 92059)	92059-1487	1
TUBE,7X11X45 (Ref # 92059A)	92059-1738	2
SPRING,THROTTLE ADJUST UPP (Ref # 92081)	92081-1620	3
SPRING,THROTTLE ADJUST LWR (Ref # 92081A)	92081-1621	3
SPRING,THROTTLE ADJUST CNT (Ref # 92081B)	92081-1622	2
COLLAR,4X5.2X9.6 (Ref # 92143)	92143-1265	1
COLLAR (Ref # 92143A)	92143-1438	1
SPRING,STATER LEVER (Ref # 92144)	92144-1540	1
BOLT (Ref # 92150)	92150-1416	1
CLAMP,TUBE (Ref # 92170)	92170-1051	2
CARBURETOR-ASSY (Ref # 15001)	15001-1797	1

## 1996 Ninja® ZX™-6 PARTS LIST

### Carburetor

ITEM NAME	PART NUMBER	QUANTITY
CARBURETOR-ASSY (Ref # 15001A)	15001-1821	1
CARBURETOR-ASSY (Ref # 15001B)	15001-1823	1
CARBURETOR,LH,OUTSIDE (Ref # 15010)	15010-1537	1
CARBURETOR,LH,INSIDE (Ref # 15010A)	15010-1538	1
CARBURETOR,RH,INSIDE (Ref # 15010B)	15010-1539	1
CARBURETOR,RH,OUTSIDE (Ref # 15010C)	15010-1540	1
CARBURETOR,LH,OUTSIDE (Ref # 15010D)	15010-1549	1
CARBURETOR,LH,INSIDE (Ref # 15010E)	15010-1550	1
CARBURETOR,RH,INSIDE (Ref # 15010F)	15010-1551	1
CARBURETOR,RH,OUTSIDE (Ref # 15010G)	15010-1552	1
CARBURETOR,LH,OUTSIDE (Ref # 15010H)	15010-1557	1
CARBURETOR,LH,INSIDE (Ref # 15010I)	15010-1558	1
CARBURETOR,RH,INSIDE (Ref # 15010J)	15010-1559	1
CARBURETOR,RH,OUTSIDE (Ref # 15010K)	15010-1560	1