

1997 Ninja® ZX™-6 PARTS DIAGRAM

Carburetor

E1611

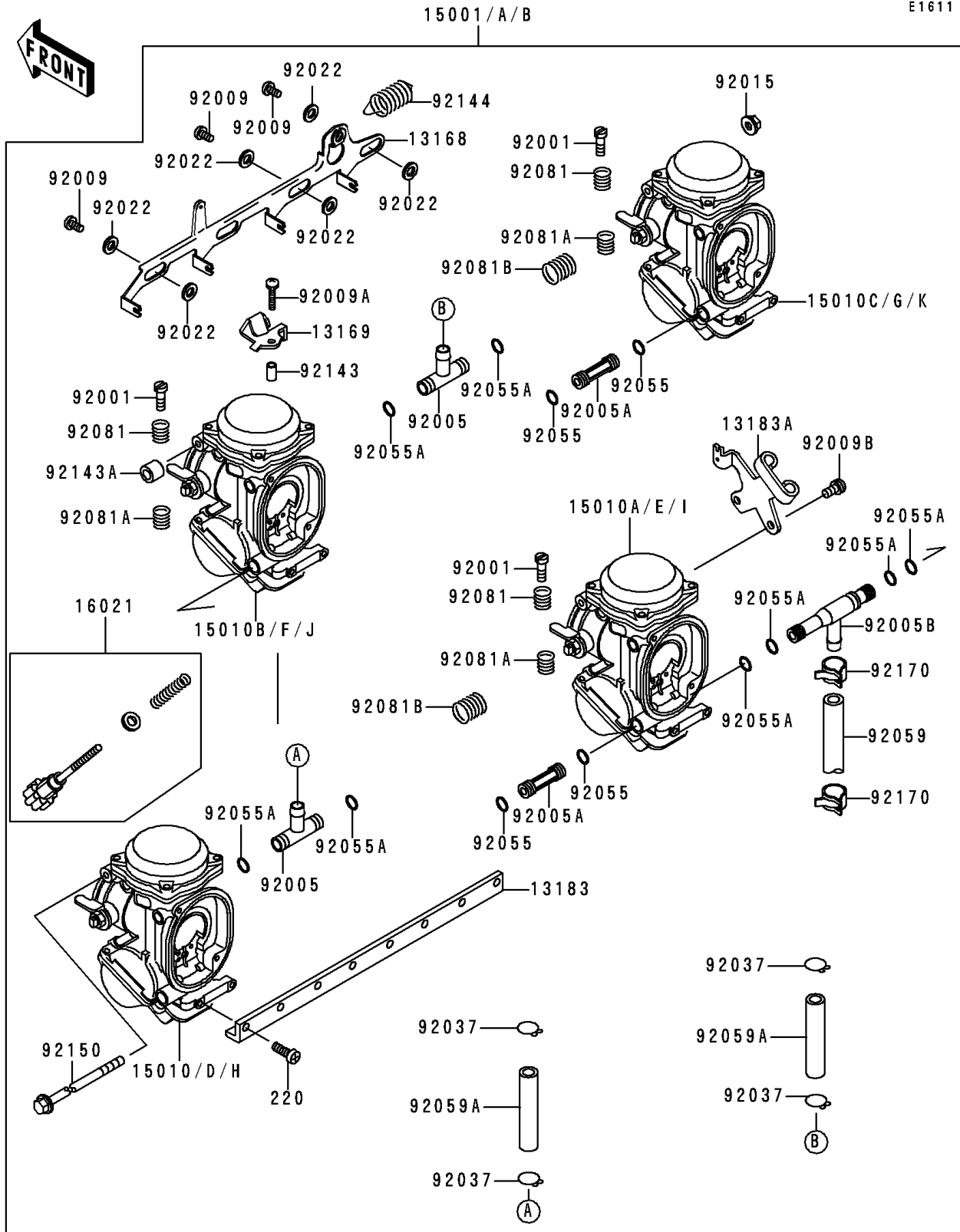

1997 Ninja® ZX™ -6 PARTS LIST

Carburetor

| ITEM NAME | PART NUMBER | QUANTITY |
|--|-------------|----------|
| LEVER,STARTER (Ref # 13168) | 13168-1462 | 1 |
| PLATE,STARTER CABLE (Ref # 13169) | 13169-1965 | 1 |
| PLATE,CARBURETOR STAY (Ref # 13183) | 13183-1608 | 1 |
| PLATE,THROTTLE CABLE (Ref # 13183A) | 13183-1610 | 1 |
| SCREW-THROTTLE STOP (Ref # 16021) | 16021-1160 | 1 |
| BOLT,THROTTLE ADJUST (Ref # 92001) | 92001-1998 | 3 |
| FITTING,T-TYPE (Ref # 92005) | 92005-1125 | 2 |
| FITTING (Ref # 92005A) | 92005-1157 | 2 |
| SCREW-PAN-CROS,5X14 (Ref # 220) | 220D0514 | 8 |
| FITTING,T-TYPE (Ref # 92005B) | 92005-1214 | 1 |
| SCREW (Ref # 92009) | 92009-1262 | 3 |
| SCREW,4X18 (Ref # 92009A) | 92009-1446 | 1 |
| SCREW (Ref # 92009B) | 92009-1597 | 1 |
| NUT,FLANGED,5MM (Ref # 92015) | 92015-1259 | 1 |
| WASHER,6.1X11X0.8,POLYACETAL (Ref # 92022) | 92022-1199 | 6 |
| CLAMP,TUBE (Ref # 92037) | 92037-1531 | 4 |
| RING-O (Ref # 92055) | 92055-1004 | 4 |
| RING-O,FUEL FITTING (Ref # 92055A) | 92055-1223 | 8 |
| TUBE,7.3X12.5X240 (Ref # 92059) | 92059-1487 | 1 |
| TUBE,7X11X45 (Ref # 92059A) | 92059-1738 | 2 |
| SPRING,THROTTLE ADJUST UPP (Ref # 92081) | 92081-1620 | 3 |
| SPRING,THROTTLE ADJUST LWR (Ref # 92081A) | 92081-1621 | 3 |
| SPRING,THROTTLE ADJUST CNT (Ref # 92081B) | 92081-1622 | 2 |
| COLLAR,4X5.2X9.6 (Ref # 92143) | 92143-1265 | 1 |
| COLLAR (Ref # 92143A) | 92143-1438 | 1 |
| SPRING,STATER LEVER (Ref # 92144) | 92144-1540 | 1 |
| BOLT (Ref # 92150) | 92150-1416 | 1 |
| CLAMP,TUBE (Ref # 92170) | 92170-1051 | 2 |
| CARBURETOR-ASSY (Ref # 15001) | 15001-1797 | 1 |

1997 Ninja® ZX™ -6 PARTS LIST

Carburetor

| ITEM NAME | PART NUMBER | QUANTITY |
|--------------------------------------|-------------|----------|
| CARBURETOR-ASSY (Ref # 15001B) | 15001-1823 | 1 |
| CARBURETOR,LH,OUTSIDE (Ref # 15010) | 15010-1537 | 1 |
| CARBURETOR,LH,INSIDE (Ref # 15010A) | 15010-1538 | 1 |
| CARBURETOR,RH,INSIDE (Ref # 15010B) | 15010-1539 | 1 |
| CARBURETOR,RH,OUTSIDE (Ref # 15010C) | 15010-1540 | 1 |
| CARBURETOR,LH,OUTSIDE (Ref # 15010H) | 15010-1557 | 1 |
| CARBURETOR,LH,INSIDE (Ref # 15010I) | 15010-1558 | 1 |
| CARBURETOR,RH,INSIDE (Ref # 15010J) | 15010-1559 | 1 |
| CARBURETOR,RH,OUTSIDE (Ref # 15010K) | 15010-1560 | 1 |