

2001 Ninja® ZX™-6 PARTS DIAGRAM

Cylinder Head

E1111

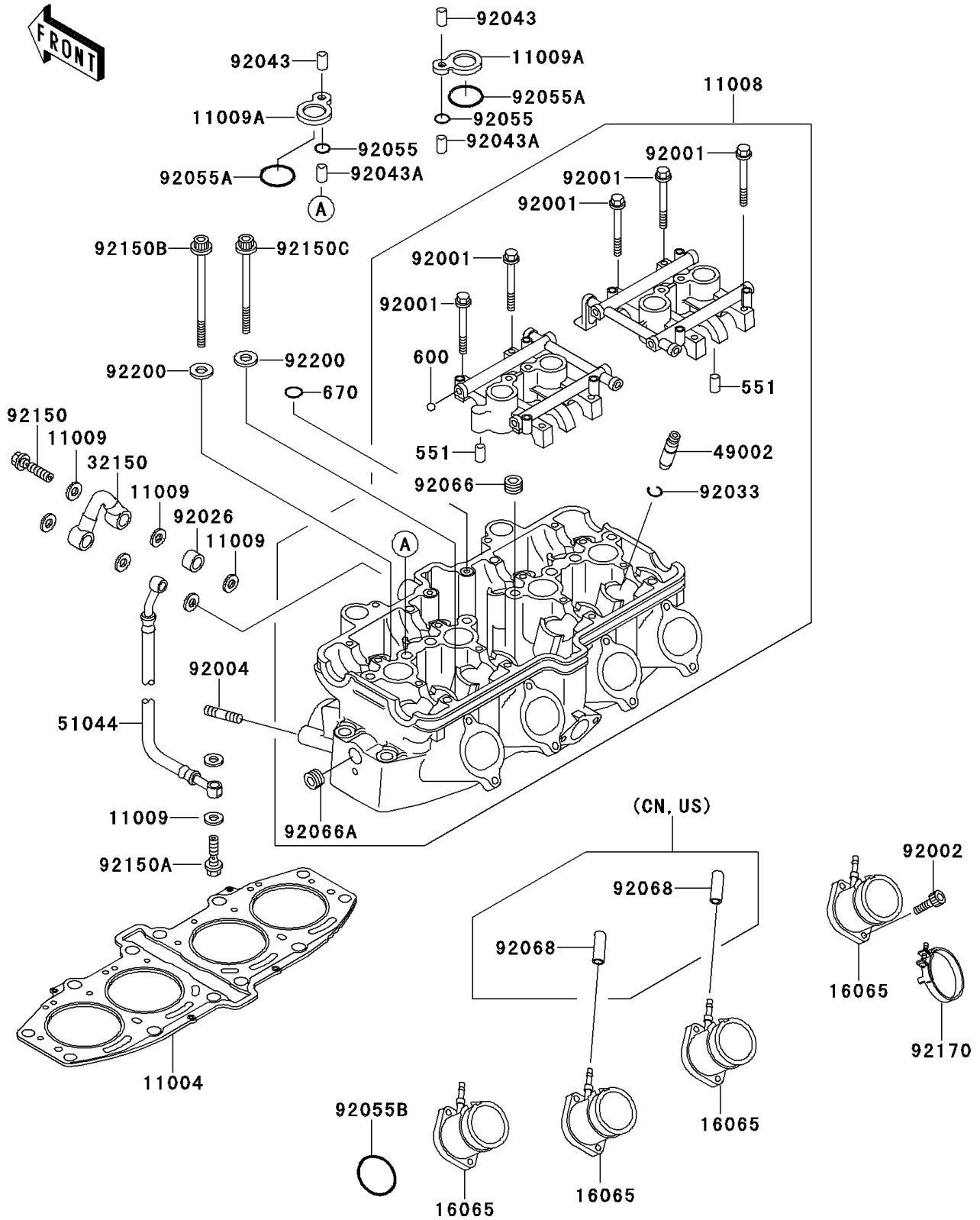

2001 Ninja® ZX™-6 PARTS LIST

Cylinder Head

| ITEM NAME | PART NUMBER | QUANTITY |
|--------------------------------------|-------------|----------|
| PIN-DOWEL,6X12 (Ref # 551) | 551A0612 | 4 |
| BALL-STEEL,9/32" (Ref # 600) | 600A0900 | 12 |
| O RING,8MM (Ref # 670) | 670D1508 | 2 |
| GASKET-HEAD (Ref # 11004) | 11004-1245 | 1 |
| HEAD-COMP-CYLINDER (Ref # 11008) | 11008-1273 | 1 |
| GASKET,10X14.5X1.5 (Ref # 11009) | 11009-1105 | 8 |
| GASKET,SPARK PLUG (Ref # 11009A) | 11009-1990 | 4 |
| HOLDER-CARBURETOR (Ref # 16065) | 16065-1276 | 4 |
| PIPE,HEAD (Ref # 32150) | 32150-1621 | 1 |
| GUIDE-VALVE (Ref # 49002) | 49002-1121 | AR |
| TUBE-ASSY,HEAD-OIL PAN (Ref # 51044) | 51044-1121 | 1 |
| BOLT,FLANGED,6X38 (Ref # 92001) | 92001-1105 | 16 |
| BOLT,SOCKET,6X14 (Ref # 92002) | 92002-1175 | 8 |
| STUD,8X18 (Ref # 92004) | 92004-1186 | 8 |
| SPACER,10.5X15.1X10 (Ref # 92026) | 92026-1393 | 1 |
| RING-SNAP (Ref # 92033) | 92033-1247 | 16 |
| PIN,6.2X8X14 (Ref # 92043) | 92043-1263 | 4 |
| PIN,8.2X10X14 (Ref # 92043A) | 92043-1264 | 4 |
| RING-O,11.5X1.5 (Ref # 92055) | 92055-1469 | 4 |
| RING-O (Ref # 92055A) | 92055-1470 | 4 |
| RING-O,42X1.9 (Ref # 92055B) | 92055-1519 | 4 |
| PLUG,PT1/2X12.5 (Ref # 92066) | 92066-1253 | 4 |
| PLUG,PT3/8X10 (Ref # 92066A) | 92066-1346 | 2 |
| BOLT,BANJO,10X37 (Ref # 92150) | 92150-1122 | 2 |
| BOLT,BANJO,10X23 (Ref # 92150A) | 92150-1123 | 1 |
| BOLT,10X165 (Ref # 92150B) | 92150-1368 | 2 |
| BOLT,10X151 (Ref # 92150C) | 92150-1369 | 10 |
| CLAMP (Ref # 92170) | 92170-1908 | 4 |
| WASHER,10.5X19X2.3 (Ref # 92200) | 92200-1042 | 12 |

2001 Ninja® ZX™-6 PARTS LIST

Cylinder Head

| ITEM NAME | PART NUMBER | QUANTITY |
|--------------------------|-------------|----------|
| PLUG,12X25 (Ref # 92068) | 92068-006 | 2 |