

1997 Ninja® ZX™-6R PARTS DIAGRAM

Fuel Tank(ZX600-F3)

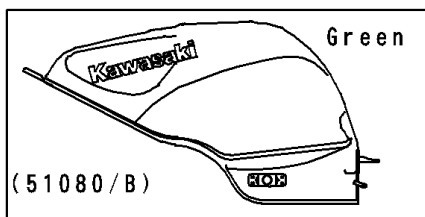

WD

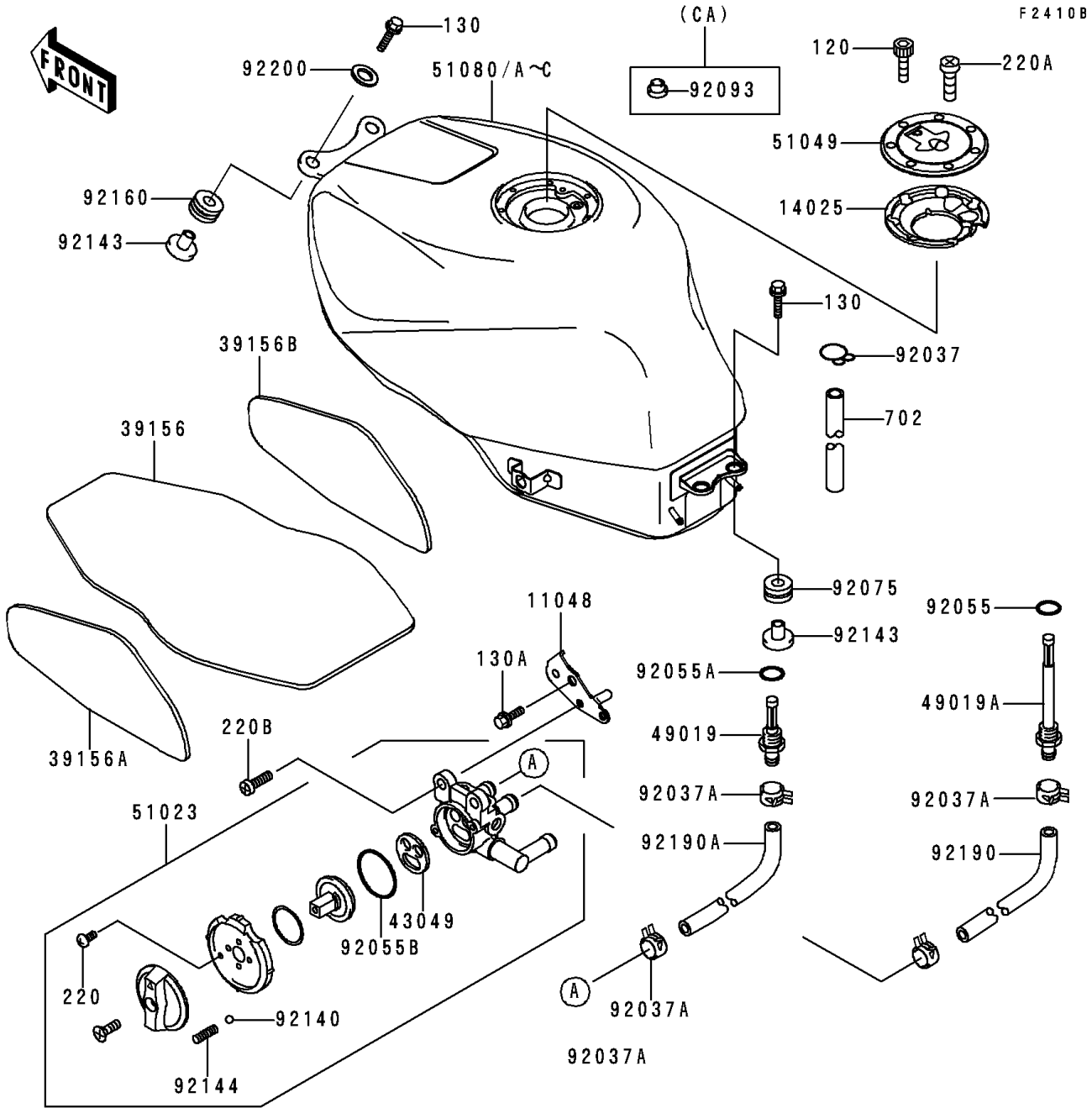
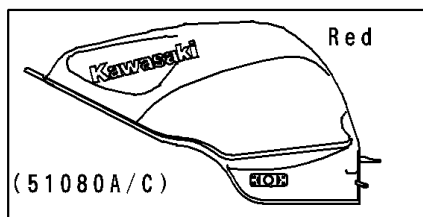

WD

1997 Ninja® ZX™-6R PARTS LIST

Fuel Tank(ZX600-F3)

| ITEM NAME | PART NUMBER | QUANTITY |
|-------------------------------------|-------------|----------|
| BRACKET,FUEL TAP (Ref # 11048) | 11048-1940 | 1 |
| COVER,TANK CAP (Ref # 14025) | 14025-1913 | 1 |
| PAD,FUEL TANK,CNT (Ref # 39156) | 39156-1448 | 1 |
| PAD,FUEL TANK,LH (Ref # 39156A) | 39156-1479 | 1 |
| PAD,FUEL TANK,RH (Ref # 39156B) | 39156-1480 | 1 |
| PACKING,TAP VALVE (Ref # 43049) | 43049-1066 | 1 |
| FILTER-FUEL (Ref # 49019) | 49019-1070 | 1 |
| FILTER-FUEL,"ON" (Ref # 49019A) | 49019-1079 | 1 |
| TAP-ASSY,FUEL (Ref # 51023) | 51023-1217 | 1 |
| CAP-TANK,FUEL (Ref # 51049) | 51049-1091 | 1 |
| CLAMP,TUBE (Ref # 92037) | 92037-010 | 1 |
| CLAMP (Ref # 92037A) | 92037-1181 | 4 |
| BOLT-SOCKET (Ref # 120) | 120S0512 | 7 |
| BOLT-FLANGED,6X30,BLACK (Ref # 130) | 130J0630 | 4 |
| BOLT-FLANGED (Ref # 130A) | 130J0812 | 1 |
| SCREW-PAN-CROS (Ref # 220) | 220B0308 | 2 |
| SCREW-PAN-CROS (Ref # 220A) | 220C0508 | 1 |
| SCREW-PAN-CROS,6X8 (Ref # 220B) | 220C0608 | 2 |
| TUBE-RUBBER,6X520 (Ref # 702) | 702A06520 | 1 |
| RING-O,ID=9.5 (Ref # 92055) | 92055-1386 | 1 |
| RING-O,11.5X1.5 (Ref # 92055A) | 92055-1387 | 1 |
| RING-O,TAP LEVER (Ref # 92055B) | 92055-1419 | 1 |
| DAMPER (Ref # 92075) | 92075-209 | 2 |
| BALL,STAINLESS,5/32" (Ref # 92140) | 92140-1051 | 1 |
| COLLAR (Ref # 92143) | 92143-1515 | 4 |
| SPRING,FUEL TAP KNOB (Ref # 92144) | 92144-1212 | 1 |
| DAMPER (Ref # 92160) | 92160-1162 | 2 |
| TUBE,FUEL,"ON" (Ref # 92190) | 92190-1586 | 1 |
| TUBE,FUEL,"RES" (Ref # 92190A) | 92190-1587 | 1 |

1997 Ninja® ZX™ -6R PARTS LIST

Fuel Tank(ZX600-F3)

| ITEM NAME | PART NUMBER | QUANTITY |
|---------------------------------------|---------------|----------|
| WASHER,6.5X22X1.6 (Ref # 92200) | 92200-1087 | 2 |
| TANK-COMP-FUEL,L.GREEN (Ref # 51080) | 51080-5373-7F | 1 |
| TANK-COMP-FUEL,C.P.RED (Ref # 51080A) | 51080-5374-A5 | 1 |
| TANK-COMP-FUEL,L.GREEN (Ref # 51080B) | 51080-5379-7F | 1 |
| TANK-COMP-FUEL,C.P.RED (Ref # 51080C) | 51080-5380-A5 | 1 |
| SEAL,FUEL TANK CAP (Ref # 92093) | 92093-1030 | 1 |