

# 2000 Ninja® ZX™-6R PARTS DIAGRAM

Front Fork

F2340

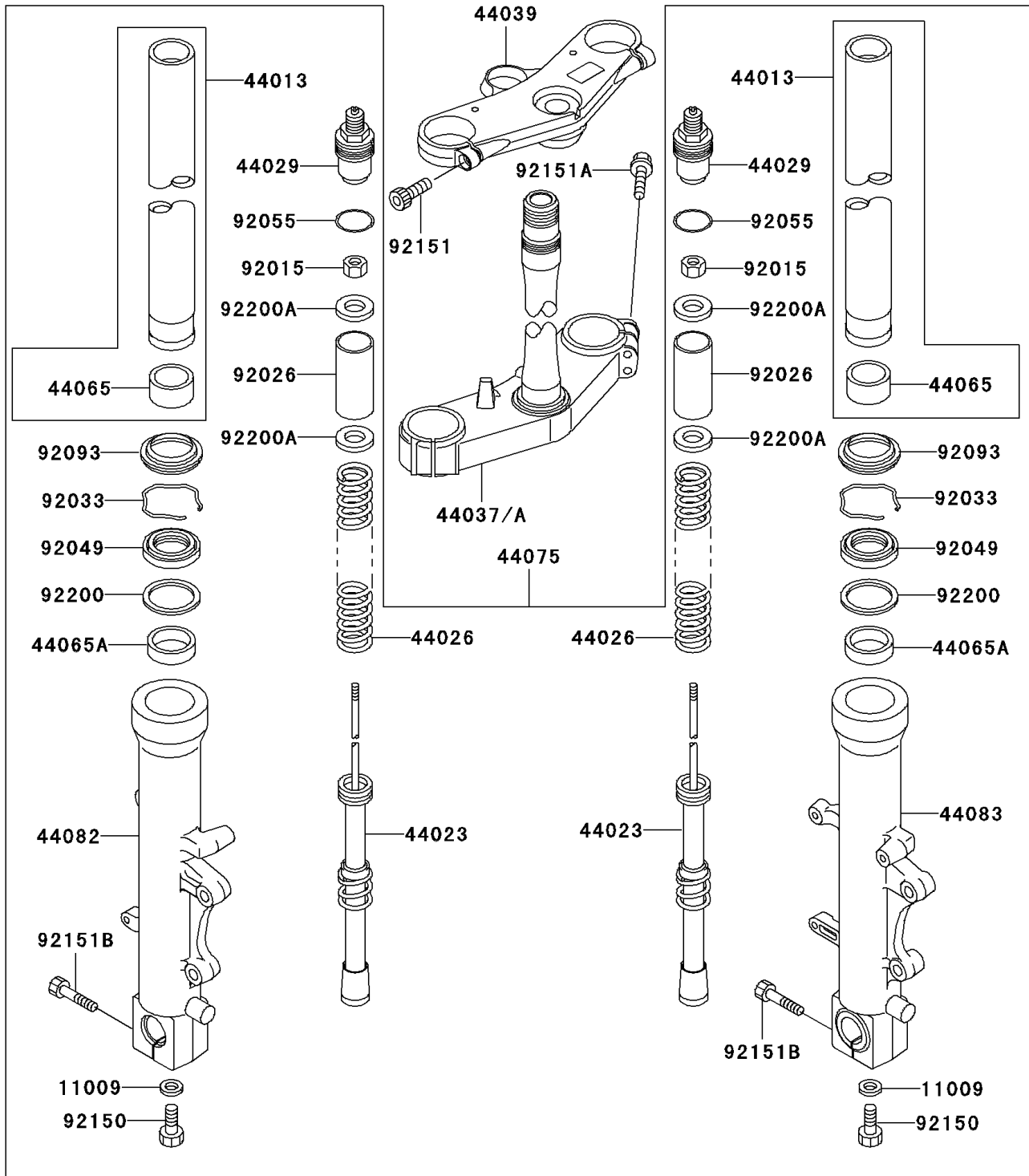

## 2000 Ninja® ZX™-6R PARTS LIST

### Front Fork

| ITEM NAME                               | PART NUMBER | QUANTITY |
|---|-------------|----------|
| GASKET,FORK CYLINDER BOLT (Ref # 11009) | 11009-1127  | 2        |
| PIPE-FORK INNER (Ref # 44013)           | 44013-1473  | 2        |
| CYLINDER-SET-FORK (Ref # 44023)         | 44023-1149  | 2        |
| SPRING-FRONT FORK (Ref # 44026)         | 44026-1705  | 2        |
| SEAT-FORK SPRING (Ref # 44029)          | 44029-1165  | 2        |
| HOLDER-FORK UNDER (Ref # 44037)         | 44037-1404  | 1        |
| HOLDER-FORK UPPER (Ref # 44039)         | 44039-1304  | 1        |
| BUSHING-FRONT FORK (Ref # 44065)        | 44065-1129  | 2        |
| BUSHING-FRONT FORK (Ref # 44065A)       | 44065-1130  | 2        |
| DAMPER-SET-FORK (Ref # 44075)           | 44075-1109  | 1        |
| PIPE-COMP-LEFT FORK OUT (Ref # 44082)   | 44082-1060  | 1        |
| PIPE-COMP-RIGHT FORK OUT (Ref # 44083)  | 44083-1059  | 1        |
| NUT (Ref # 92015)                       | 92015-1905  | 2        |
| SPACER,FORK,L=125 (Ref # 92026)         | 92026-1578  | 2        |
| RING-SNAP (Ref # 92033)                 | 92033-1264  | 2        |
| SEAL-OIL (Ref # 92049)                  | 92049-1508  | 2        |
| RING-O, (Ref # 92055)                   | 92055-1140  | 2        |
| SEAL,FORK OUTER TUBE (Ref # 92093)      | 92093-1473  | 2        |
| BOLT,12X22 (Ref # 92150)                | 92150-1398  | 2        |
| BOLT,SOCKET,8X25 (Ref # 92151)          | 92151-1681  | 2        |
| BOLT,FLANGED,8X40 (Ref # 92151A)        | 92151-1682  | 4        |
| BOLT,SOCKET,8X40 (Ref # 92151B)         | 92151-1683  | 4        |
| WASHER (Ref # 92200)                    | 92200-1006  | 2        |
| WASHER (Ref # 92200A)                   | 92200-1420  | 4        |