

1989 Ninja® 750R PARTS DIAGRAM

Engine Cover(s)

E1431-0201

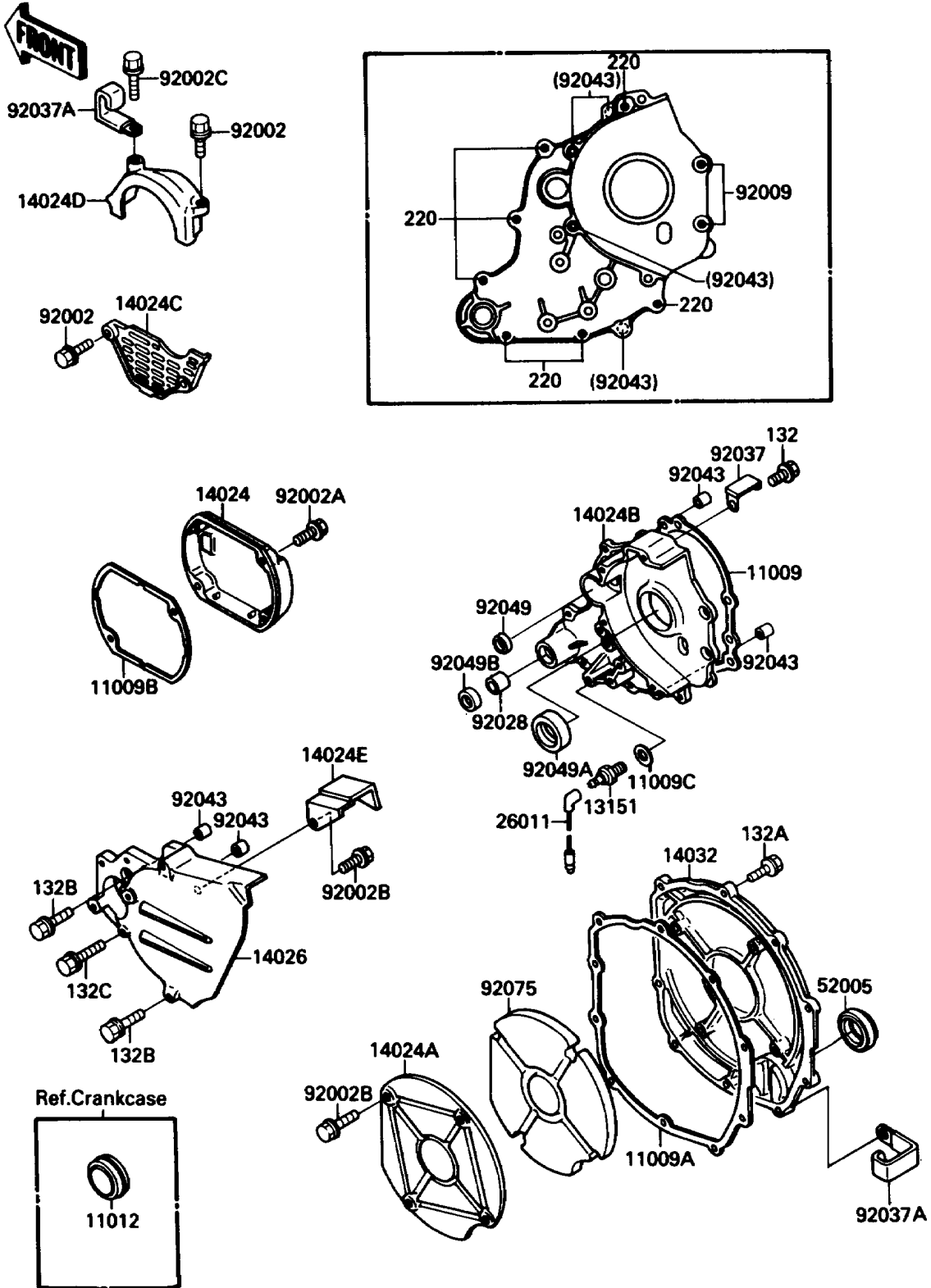

1989 Ninja® 750R PARTS LIST

Engine Cover(s)

| ITEM NAME | PART NUMBER | QUANTITY |
|--|-------------|----------|
| BOLT-FLANGED-SMALL (Ref # 132) | 132W0610 | 1 |
| BOLT-FLANGED-SMALL (Ref # 132A) | 132W0620 | 10 |
| BOLT-FLANGED-SMALL (Ref # 132B) | 132W0645 | 3 |
| BOLT-FLANGED-SMALL (Ref # 132C) | 132W0655 | 1 |
| SCREW-PAN-CROS,6X20,WHITE (Ref # 220) | 220B0620 | 7 |
| GASKET,TRANSMISSION COVER (Ref # 11009) | 11009-1600 | 1 |
| GASKET,CLUTCH COVER (Ref # 11009A) | 11009-1601 | 1 |
| GASKET,PULSING COIL COVER (Ref # 11009B) | 11009-1603 | 1 |
| GASKET,10.5X16X1,DRAIN PLUG (Ref # 11009C) | 92065-058 | 1 |
| CAP,LH,RCA378 (Ref # 11012) | 11012-1540 | 1 |
| SWITCH-COMP,NEUTRAL (Ref # 13151) | 13151-1007 | 1 |
| COVER,RH (Ref # 14024) | 14024-1299 | 1 |
| COVER,SOUND ARRESTER (Ref # 14024A) | 14024-1301 | 1 |
| COVER,TRANSMISSION (Ref # 14024B) | 14024-1305 | 1 |
| COVER,GENERATOR,SIDE (Ref # 14024C) | 14024-1309 | 1 |
| COVER,GENERATOR,UPP (Ref # 14024D) | 14024-1310 | 1 |
| COVER (Ref # 14024E) | 14024-1376 | 1 |
| COVER-CHAIN (Ref # 14026) | 14026-1126 | 1 |
| COVER-CLUTCH (Ref # 14032) | 14032-1224 | 1 |
| WIRE-LEAD (Ref # 26011) | 26011-1384 | 1 |
| GAUGE,OIL LEVEL (Ref # 52005) | 52005-1057 | 1 |
| BOLT,6X20 (Ref # 92002) | 92002-1343 | 3 |
| BOLT,6X25 (Ref # 92002A) | 92002-1344 | 2 |
| BOLT,6X10 (Ref # 92002B) | 92002-1449 | 5 |
| BOLT,6X30 (Ref # 92002C) | 92002-1534 | 1 |
| SCREW,6X20 (Ref # 92009) | 92009-1447 | 2 |
| BUSHING,13X15X20 (Ref # 92028) | 92028-1251 | 1 |
| CLAMP,LEAD WIRE (Ref # 92037) | 92037-1876 | 1 |
| CLAMP,WIRING HARNESS (Ref # 92037A) | 92037-1877 | 2 |

1989 Ninja® 750R PARTS LIST

Engine Cover(s)

| ITEM NAME | PART NUMBER | QUANTITY |
|-------------------------------------|-------------|----------|
| PIN,DOWEL,6.3X8X14 (Ref # 92043) | 92042-007 | 4 |
| SEAL-OIL,SD-8187 (Ref # 92049) | 92049-1017 | 1 |
| SEAL-OIL,SC32487 (Ref # 92049A) | 92049-1033 | 1 |
| SEAL-OIL,TB13205 (Ref # 92049B) | 92049-1186 | 1 |
| DAMPER,SOUND ARRESTER (Ref # 92075) | 92075-1837 | 1 |