

1995 Ninja® ZX™ -7 PARTS DIAGRAM

Front Fork

F2340

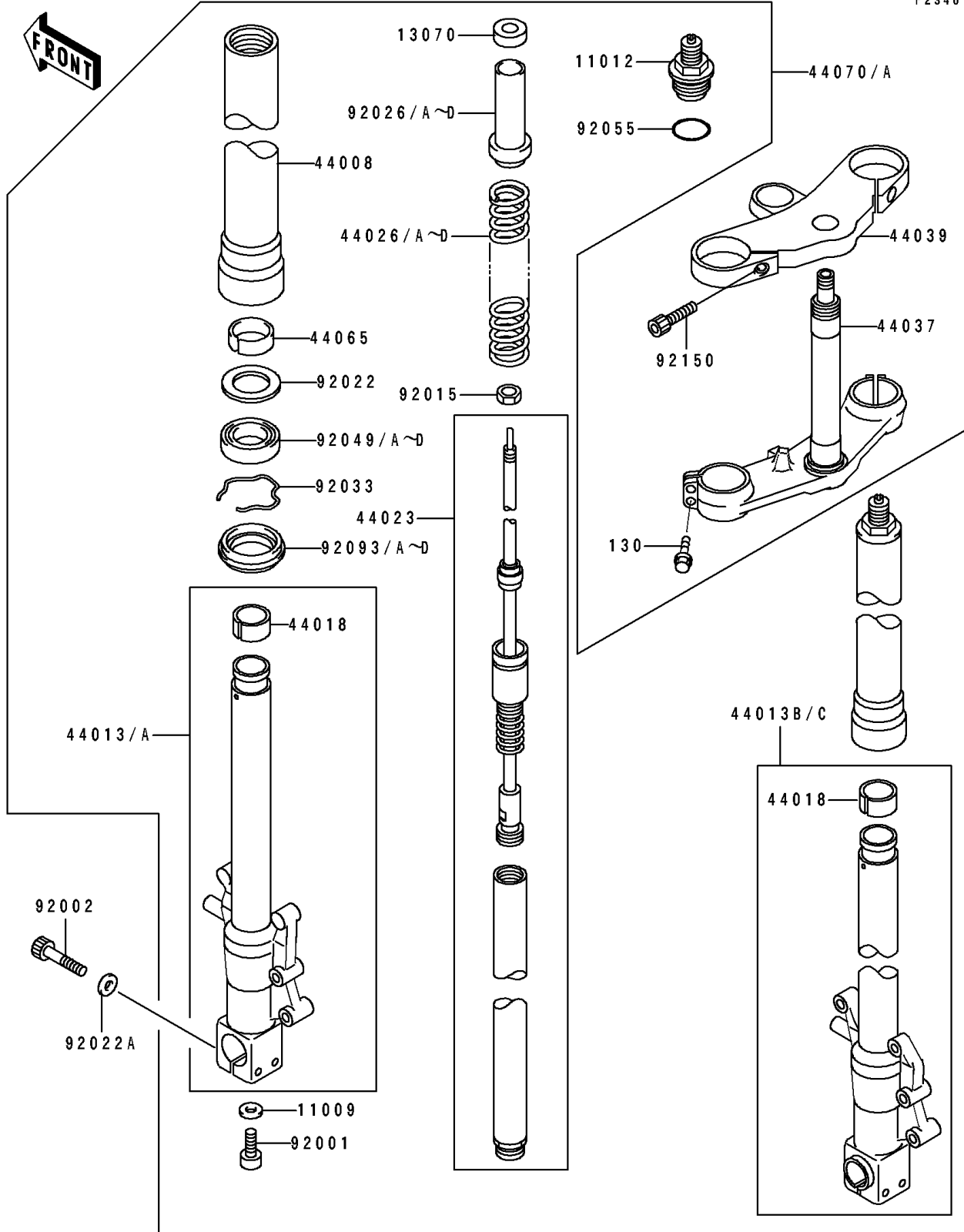

1995 Ninja® ZX™-7 PARTS LIST

Front Fork

ITEM NAME	PART NUMBER	QUANTITY
GASKET,FORK CYLINDER BOLT (Ref # 11009)	11009-1127	2
CAP,FORK TOP (Ref # 11012)	11012-1748	2
GUIDE,FORK (Ref # 13070)	13070-1236	2
PIPE-FORK OUTER,BROWN (Ref # 44008)	44008-1017-JS	2
PIPE-FORK INNER,LH,SILVER (Ref # 44013)	44013-1391-KF	1
PIPE-FORK INNER,RH,SILVER (Ref # 44013B)	44013-1392-KF	1
PISTON-FORK (Ref # 44018)	44018-1054	2
CYLINDER-COMP-FORK (Ref # 44023)	44023-1091	2
SPRING-FRONT FORK (Ref # 44026B)	44026-1550	2
HOLDER-FORK UNDER (Ref # 44037)	44037-1295	1
HOLDER-FORK UPPER (Ref # 44039)	44039-1234	1
BUSHING-FRONT FORK,FORK OUTER (Ref # 44065)	44065-1096	2
DAMPER-ASSY,FORK,SILVER NO.30 (Ref # 44070)	44070-5166-KF	1
BOLT,FORK CYLINDER (Ref # 92001)	92001-1309	2
BOLT,SOCKET,8X45 (Ref # 92002)	92002-1847	4
NUT (Ref # 92015)	92015-1795	2
WASHER,FORK OUTER TUBE (Ref # 92022)	92022-1298	2
WASHER (Ref # 92022A)	92022-1598	4
SPACER,FORK (Ref # 92026B)	92026-1442	2
RING-SNAP (Ref # 92033)	92033-1036	2
SEAL-OIL,FORK OUTER TUBE (Ref # 92049B)	92049-1356	2
RING-O (Ref # 92055)	92055-1115	2
SEAL,FORK OUTER TUBE (Ref # 92093B)	92093-1359	2
BOLT,SOCKET,8X25 (Ref # 92150)	92150-1172	2
BOLT-FLANGED,8X40 (Ref # 130)	130G0840	4