

# 1999 Ninja® ZX™-7R PARTS DIAGRAM

Front Fork

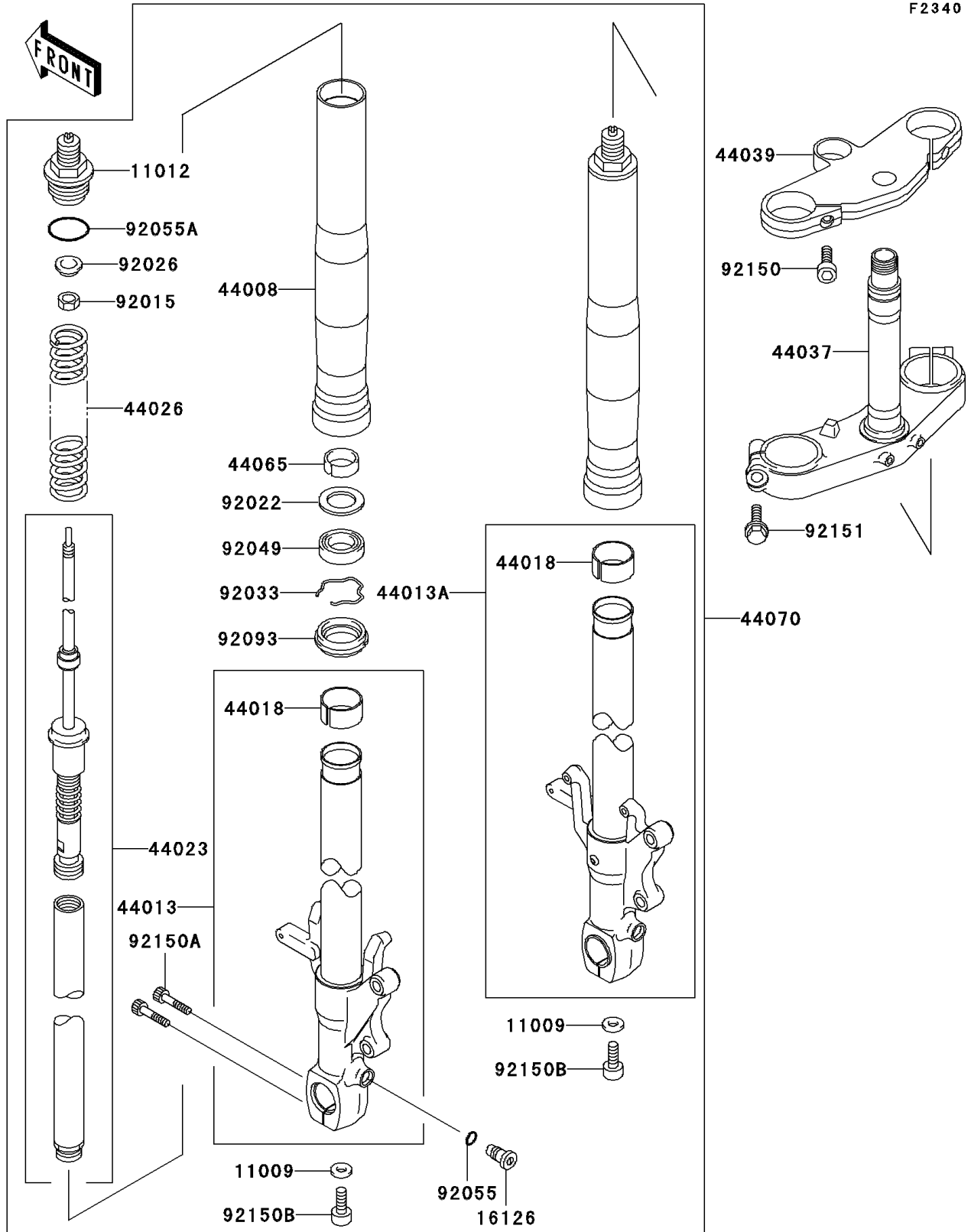

# 1999 Ninja® ZX™-7R PARTS LIST

## Front Fork

ITEM NAME	PART NUMBER	QUANTITY
GASKET,FORK CYLINDER BOLT (Ref # 11009)	11009-1127	2
CAP,FORK TOP (Ref # 11012)	11012-1792	2
VALVE,FORK (Ref # 16126)	16126-1261	2
PIPE-FORK OUTER,A.BRONZE (Ref # 44008)	44008-1039-JS	2
PIPE-FORK INNER,LH,SILVER (Ref # 44013)	44013-1415-KF	1
PIPE-FORK INNER,RH,SILVER (Ref # 44013A)	44013-1416-KF	1
PISTON-FORK,INNER PIPE (Ref # 44018)	44018-1056	2
CYLINDER-COMP-FORK (Ref # 44023)	44023-1098	2
SPRING-FRONT FORK (Ref # 44026)	44026-1593	2
HOLDER-FORK UNDER (Ref # 44037)	44037-1339	1
HOLDER-FORK UPPER (Ref # 44039)	44039-1264	1
BUSHING-FRONT FORK (Ref # 44065)	44065-1111	2
DAMPER-ASSY,FORK,SILVER (Ref # 44070)	44070-1490-KF	1
NUT (Ref # 92015)	92015-1795	2
WASHER (Ref # 92022)	92022-1299	2
SPACER,FORK (Ref # 92026)	92026-1471	2
RING-SNAP (Ref # 92033)	92033-1077	2
SEAL-OIL,FORK OUTER TUBE (Ref # 92049)	92049-1456	2
RING-O,ANTI-DIVE UNIT (Ref # 92055)	92055-1201	2
RING-O,FORK,AIR TUBE (Ref # 92055A)	92055-1333	2
SEAL,FORK OUTER TUBE (Ref # 92093)	92093-1415	2
BOLT,SOCKET,8X25 (Ref # 92150)	92150-1172	2
BOLT,SOCKET,8X40 (Ref # 92150A)	92150-1194	4
BOLT,12X22 (Ref # 92150B)	92150-1398	2
BOLT,FLANGED,10X40 (Ref # 92151)	92151-1171	2