

1998 Ninja® ZX™-7R PARTS DIAGRAM

Side Covers/Chain Cover

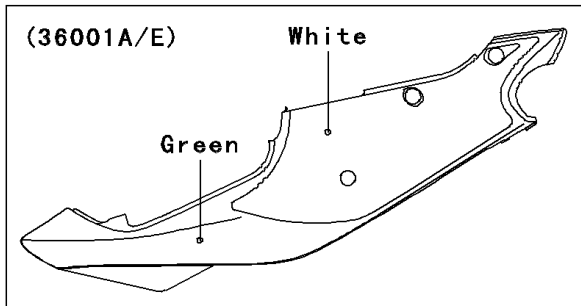

WOD

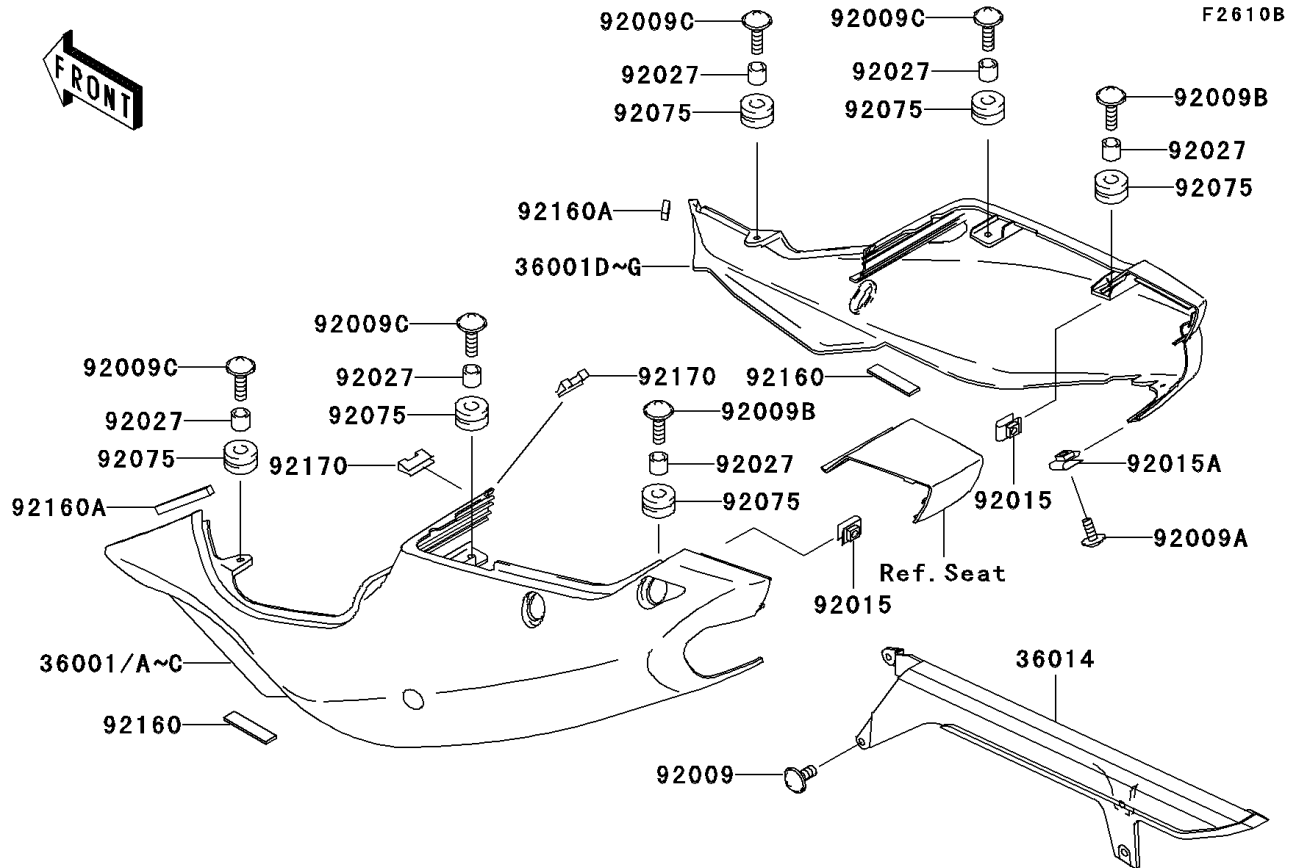
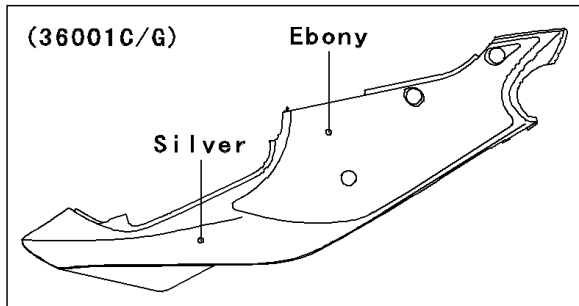

WOD

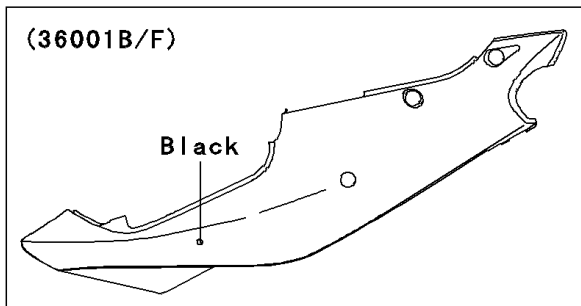

WOD

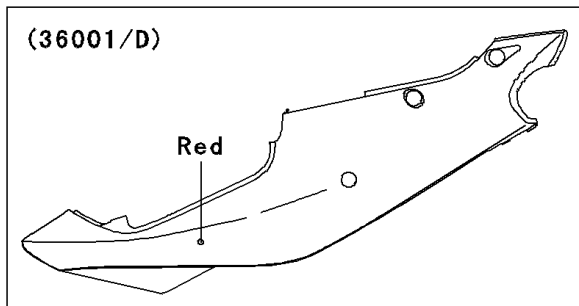

WOD

1998 Ninja® ZX™-7R PARTS LIST

Side Covers/Chain Cover

| ITEM NAME | PART NUMBER | QUANTITY |
|---|---------------|----------|
| COVER-SIDE,LH,GREEN/WHITE (Ref # 36001A) | 36001-1557-CK | 1 |
| COVER-SIDE,LH,P.P.BLACK MICA (Ref # 36001B) | 36001-1557-20 | 1 |
| COVER-SIDE,RH,GREEN/WHITE (Ref # 36001E) | 36001-1558-CK | 1 |
| COVER-SIDE,RH,P.P.BLACK MICA (Ref # 36001F) | 36001-1558-20 | 1 |
| CASE-CHAIN (Ref # 36014) | 36014-1200 | 1 |
| SCREW,6X10 (Ref # 92009) | 92009-1402 | 4 |
| SCREW,5X14 (Ref # 92009A) | 92009-1653 | 1 |
| SCREW,6X18 (Ref # 92009B) | 92009-1663 | 2 |
| SCREW,6X22 (Ref # 92009C) | 92009-1664 | 4 |
| NUT,5MM (Ref # 92015) | 92015-1798 | 2 |
| NUT,5MM (Ref # 92015A) | 92015-1996 | 1 |
| COLLAR,6.8X10X8.5 (Ref # 92027) | 92027-129 | 6 |
| DAMPER (Ref # 92075) | 92075-1634 | 6 |
| DAMPER (Ref # 92160) | 92160-1099 | 2 |
| DAMPER (Ref # 92160A) | 92160-1800 | 2 |
| CLAMP (Ref # 92170) | 92170-1440 | 2 |