

# 1999 Ninja® ZX™ -9R PARTS DIAGRAM

## Battery Case

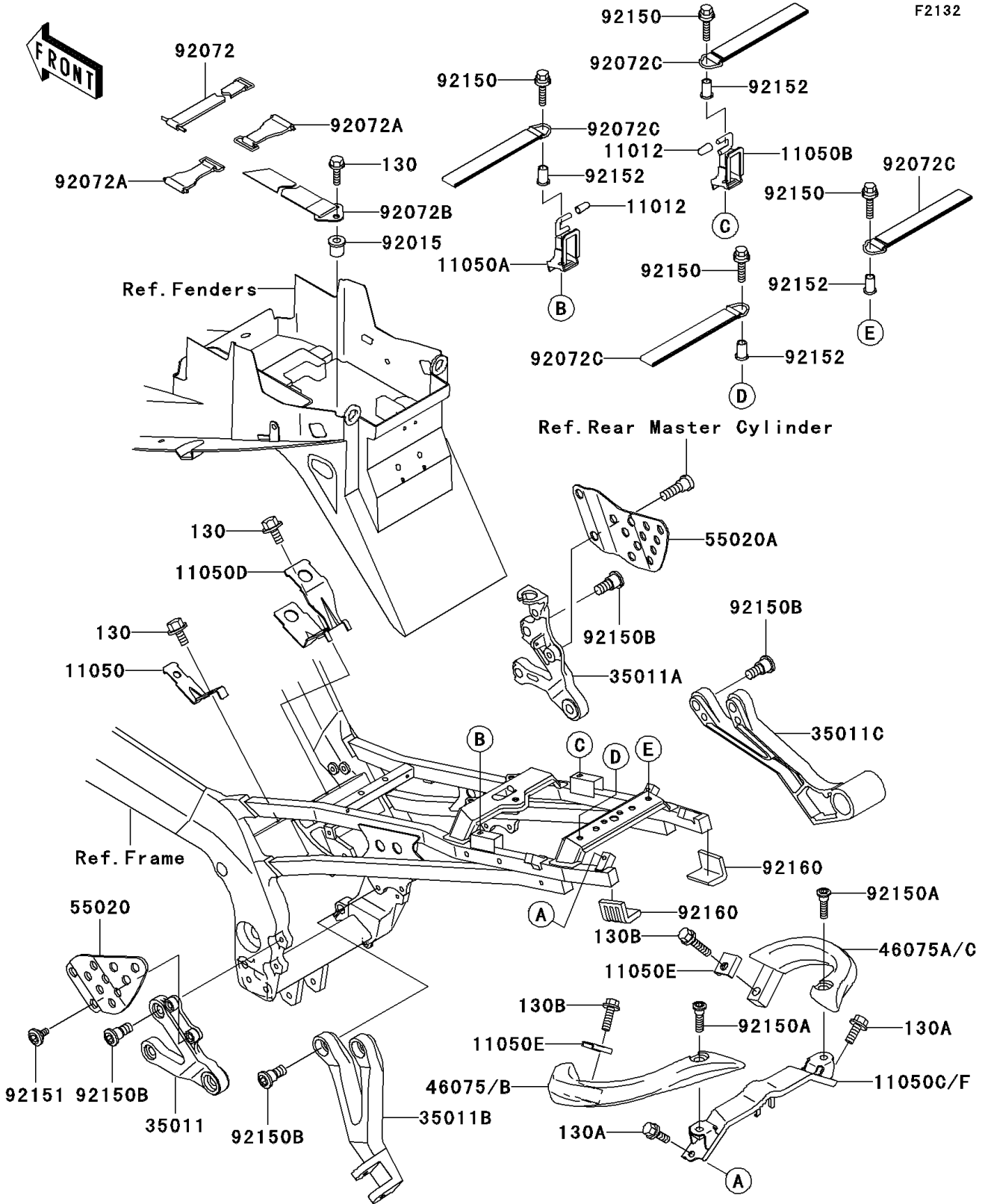

# 1999 Ninja® ZX™-9R PARTS LIST

## Battery Case

| ITEM NAME                                | PART NUMBER   | QUANTITY |
|--|---------------|----------|
| BOLT-FLANGED,6X16,BLACK (Ref # 130)      | 130J0616      | 3        |
| BOLT-FLANGED (Ref # 130A)                | 130J0812      | 2        |
| BOLT-FLANGED,8X30 (Ref # 130B)           | 130J0830      | 2        |
| CAP,BUNGEE CORD HOOK (Ref # 11012)       | 11012-1589    | 2        |
| BRACKET,FUEL FILTER (Ref # 11050)        | 11050-1471    | 1        |
| BRACKET,RR SEAT&HELMET,LH (Ref # 11050A) | 11050-1472    | 1        |
| BRACKET,RR SEAT&HELMET,RH (Ref # 11050B) | 11050-1475    | 1        |
| BRACKET,FUEL PUMP (Ref # 11050D)         | 11050-1501    | 1        |
| BRACKET,TAIL GRIP (Ref # 11050E)         | 11050-1797    | 2        |
| BRACKET,TAIL GRIP (Ref # 11050F)         | 11050-1871    | 1        |
| STAY,FR STEP,LH (Ref # 35011)            | 35011-1874    | 1        |
| STAY,FR STEP,RH (Ref # 35011A)           | 35011-1875    | 1        |
| STAY,RR STEP,LH,SILVER (Ref # 35011B)    | 35011-1878-TX | 1        |
| STAY,RR STEP,RH,SILVER (Ref # 35011C)    | 35011-1879-TX | 1        |
| GRIP,RR,LH,F.BLACK (Ref # 46075B)        | 46075-1171-21 | 1        |
| GRIP,RR,RH,F.BLACK (Ref # 46075C)        | 46075-1172-21 | 1        |
| GUARD,FR STEP STAY,LH (Ref # 55020)      | 55020-1627    | 1        |
| GUARD,FR STEP STAY,RH (Ref # 55020A)     | 55020-1628    | 1        |
| NUT (Ref # 92015)                        | 92015-1700    | 1        |
| BAND,TOOL (Ref # 92072)                  | 92072-1349    | 1        |
| BAND,U LOCK (Ref # 92072A)               | 92072-1355    | 2        |
| BAND,U LOCK (Ref # 92072B)               | 92072-1356    | 1        |
| BAND,L=122 (Ref # 92072C)                | 92072-1363    | 4        |
| BOLT,FLANGED,6X30 (Ref # 92150)          | 92150-1486    | 4        |
| BOLT,SOCKET,8X40 (Ref # 92150A)          | 92150-1735    | 2        |
| BOLT,SOCKET,8X20 (Ref # 92150B)          | 92150-1839    | 8        |
| BOLT,6MM (Ref # 92151)                   | 92151-1334    | 2        |
| COLLAR (Ref # 92152)                     | 92152-1108    | 4        |
| DAMPER (Ref # 92160)                     | 92160-1937    | 2        |