

# 1999 Ninja® ZX™-9R PARTS DIAGRAM

Rear Master Cylinder

F2293

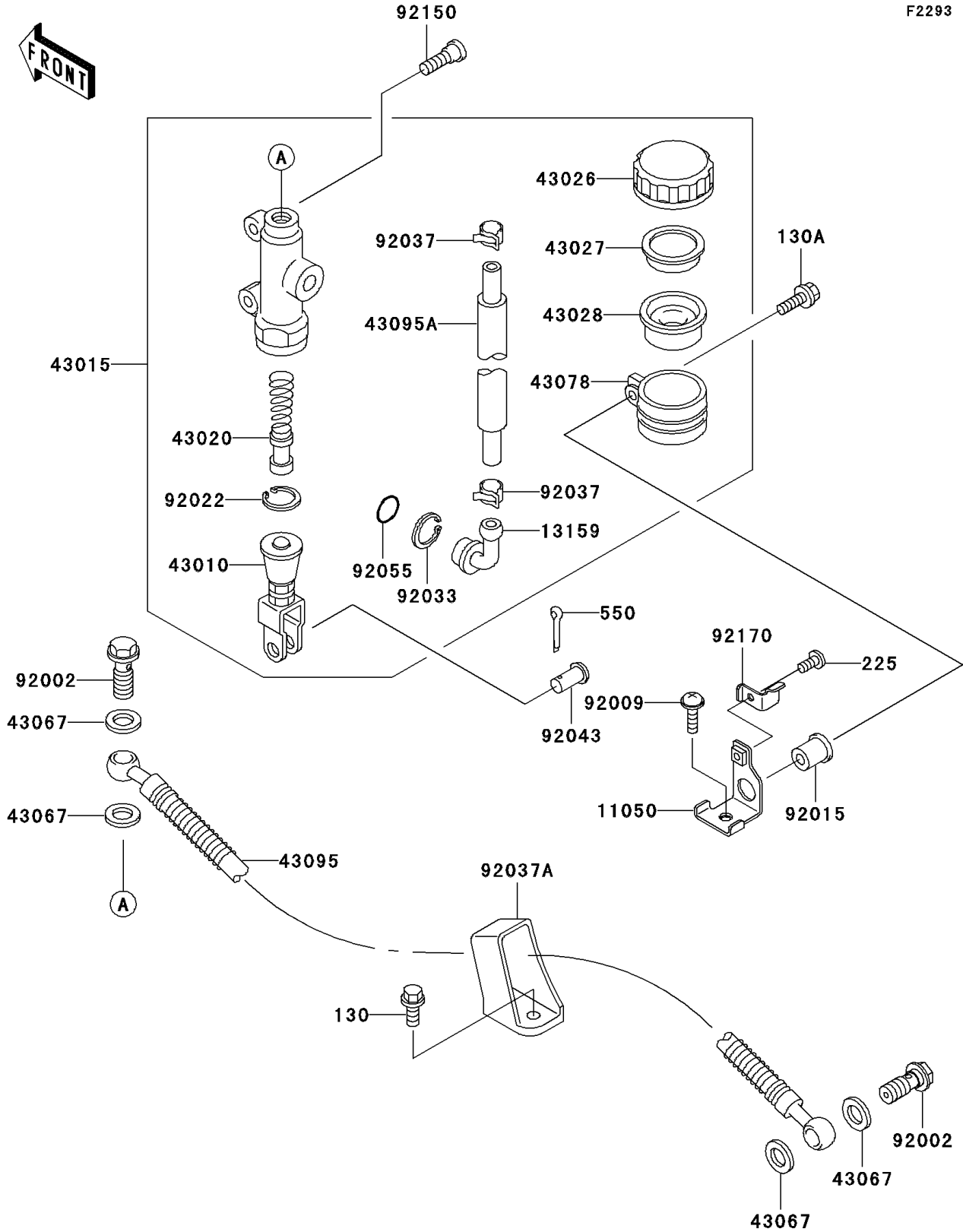

# 1999 Ninja® ZX™-9R PARTS LIST

## Rear Master Cylinder

ITEM NAME	PART NUMBER	QUANTITY
BOLT-FLANGED (Ref # 130)	130J0610	1
BOLT-FLANGED,6X25 (Ref # 130A)	130J0625	1
SCREW-PAN-WSP-CROS (Ref # 225)	225C0412	1
PIN-COTTER,2.0X15 (Ref # 550)	550D2015	1
BRACKET,RESERVE TANK (Ref # 11050)	11050-1768	1
CONNECTOR,RR MASTER CYLINDER (Ref # 13159)	13159-1052	1
ROD-ASSY-BRAKE (Ref # 43010)	43010-1062	1
CYLINDER-ASSY-MASTER,RR (Ref # 43015)	43015-1610	1
PISTON-COMP-BRAKE (Ref # 43020)	43020-1094	1
CAP-BRAKE (Ref # 43026)	43026-1051	1
PLATE-DIAPHRAGM (Ref # 43027)	43027-1051	1
DIAPHRAGM,MASTER CYLINDER (Ref # 43028)	43028-1057	1
WASHER,10.5X15X1.5 (Ref # 43067)	43067-001	4
RESERVOIR,RR MASTER CYLINDER (Ref # 43078)	43078-1082	1
HOSE-BRAKE,RR (Ref # 43095)	43095-1109	1
HOSE-BRAKE,RR MASTER CYLINDER (Ref # 43095A)	43095-1115	1
BOLT,OIL,L=23 (Ref # 92002)	92002-1888	2
SCREW,6X14 (Ref # 92009)	92009-1288	1
NUT (Ref # 92015)	92015-1700	1
WASHER,CIRCRIP (Ref # 92022)	92022-1601	1
RING-SNAP,20.5MM (Ref # 92033)	92033-1186	1
CLAMP,BRAKE HOSE (Ref # 92037)	92037-1547	2
CLAMP,HOSE (Ref # 92037A)	92037-1896	1
PIN,8MM (Ref # 92043)	92043-1303	1
RING-O,MASTER CYLINDER (Ref # 92055)	92055-1251	1
BOLT,SOCKET,8X30 (Ref # 92150)	92150-1843	2
CLAMP,RESERVE TANK CAP (Ref # 92170)	92170-1879	1