

2000 Ninja® ZX™-9R PARTS DIAGRAM

Rear Master Cylinder

F2293

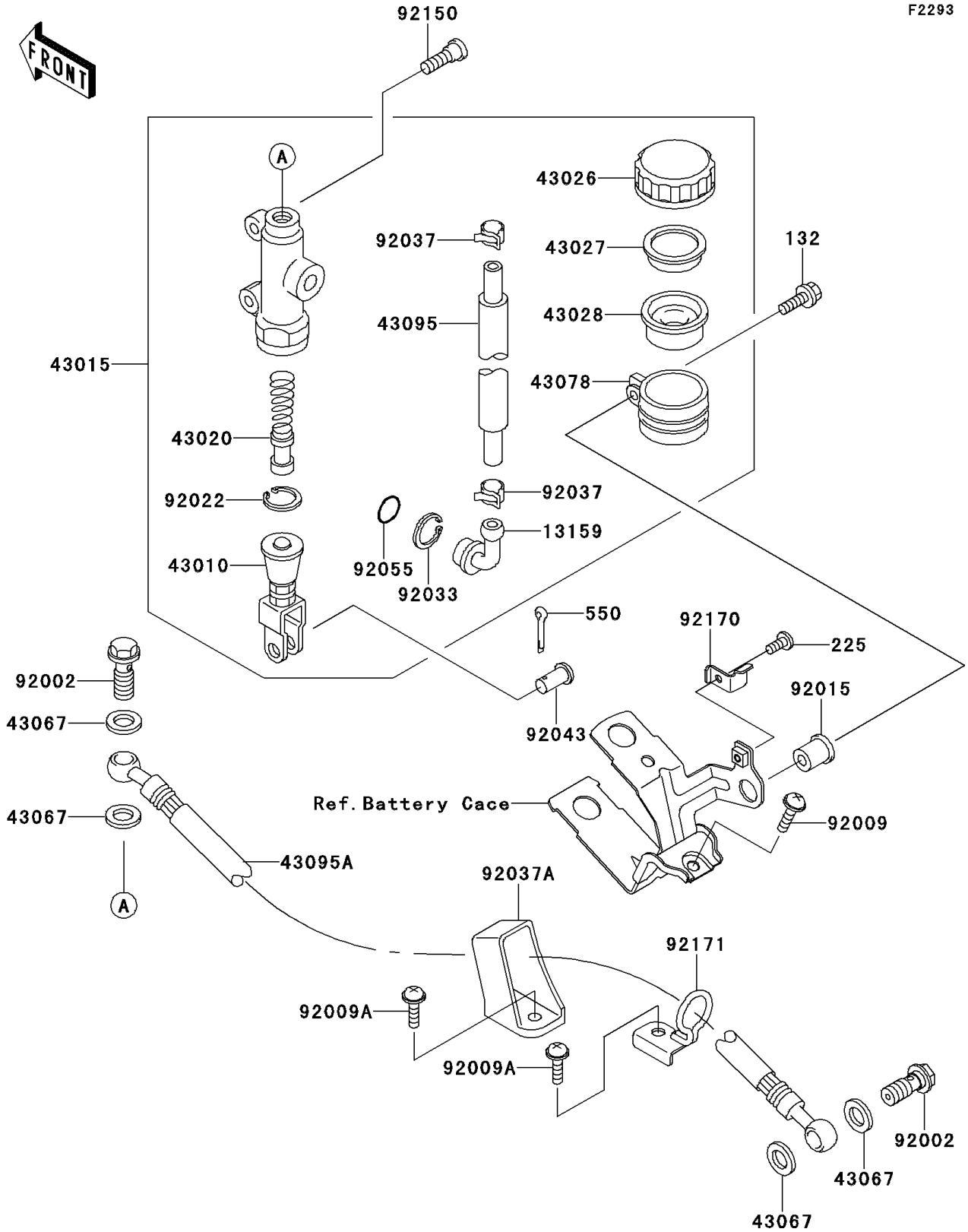

2000 Ninja® ZX™-9R PARTS LIST

Rear Master Cylinder

| ITEM NAME | PART NUMBER | QUANTITY |
|---|-------------|----------|
| BOLT-FLANGED-SMALL (Ref # 132) | 132J0625 | 1 |
| SCREW-PAN-WSP-CROS (Ref # 225) | 225C0412 | 1 |
| PIN-COTTER,2.0X15 (Ref # 550) | 550D2015 | 1 |
| CONNECTOR,RR MASTER CYLINDER (Ref # 13159) | 13159-1052 | 1 |
| ROD-ASSY-BRAKE (Ref # 43010) | 43010-1062 | 1 |
| CYLINDER-ASSY-MASTER,RR (Ref # 43015) | 43015-1610 | 1 |
| PISTON-COMP-BRAKE (Ref # 43020) | 43020-1094 | 1 |
| CAP-BRAKE (Ref # 43026) | 43026-1051 | 1 |
| PLATE-DIAPHRAGM (Ref # 43027) | 43027-1051 | 1 |
| DIAPHRAGM,MASTER CYLINDER (Ref # 43028) | 43028-1057 | 1 |
| WASHER,10.5X15X1.5 (Ref # 43067) | 43067-001 | 4 |
| RESERVOIR,RR MASTER CYLINDER (Ref # 43078) | 43078-1082 | 1 |
| HOSE-BRAKE,RR MASTER CYLINDER (Ref # 43095) | 43095-1115 | 1 |
| HOSE-BRAKE,RR (Ref # 43095A) | 43095-1163 | 1 |
| BOLT,OIL,L=23 (Ref # 92002) | 92002-1888 | 2 |
| SCREW,6X14 (Ref # 92009) | 92009-1288 | 1 |
| SCREW,6X10 (Ref # 92009A) | 92009-1661 | 2 |
| NUT (Ref # 92015) | 92015-1700 | 1 |
| WASHER,CIRCRIP (Ref # 92022) | 92022-1601 | 1 |
| RING-SNAP,20.5MM (Ref # 92033) | 92033-1186 | 1 |
| CLAMP,BRAKE HOSE (Ref # 92037) | 92037-1547 | 2 |
| CLAMP,HOSE (Ref # 92037A) | 92037-1896 | 1 |
| PIN,8MM (Ref # 92043) | 92043-1303 | 1 |
| RING-O,MASTER CYLINDER (Ref # 92055) | 92055-1251 | 1 |
| BOLT,SOCKET,8X30 (Ref # 92150) | 92150-1843 | 2 |
| CLAMP,RESERVE TANK CAP (Ref # 92170) | 92170-1879 | 1 |
| CLAMP,BRAKE HOSE (Ref # 92171) | 92171-1244 | 1 |