

2003 Ninja® ZX™ -9R PARTS DIAGRAM

Fuel Tank(ZX900-F2)

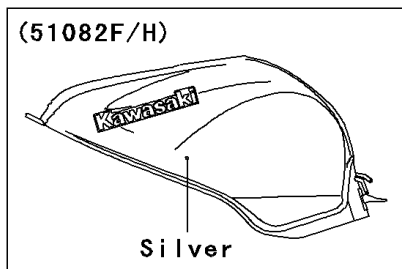

WD

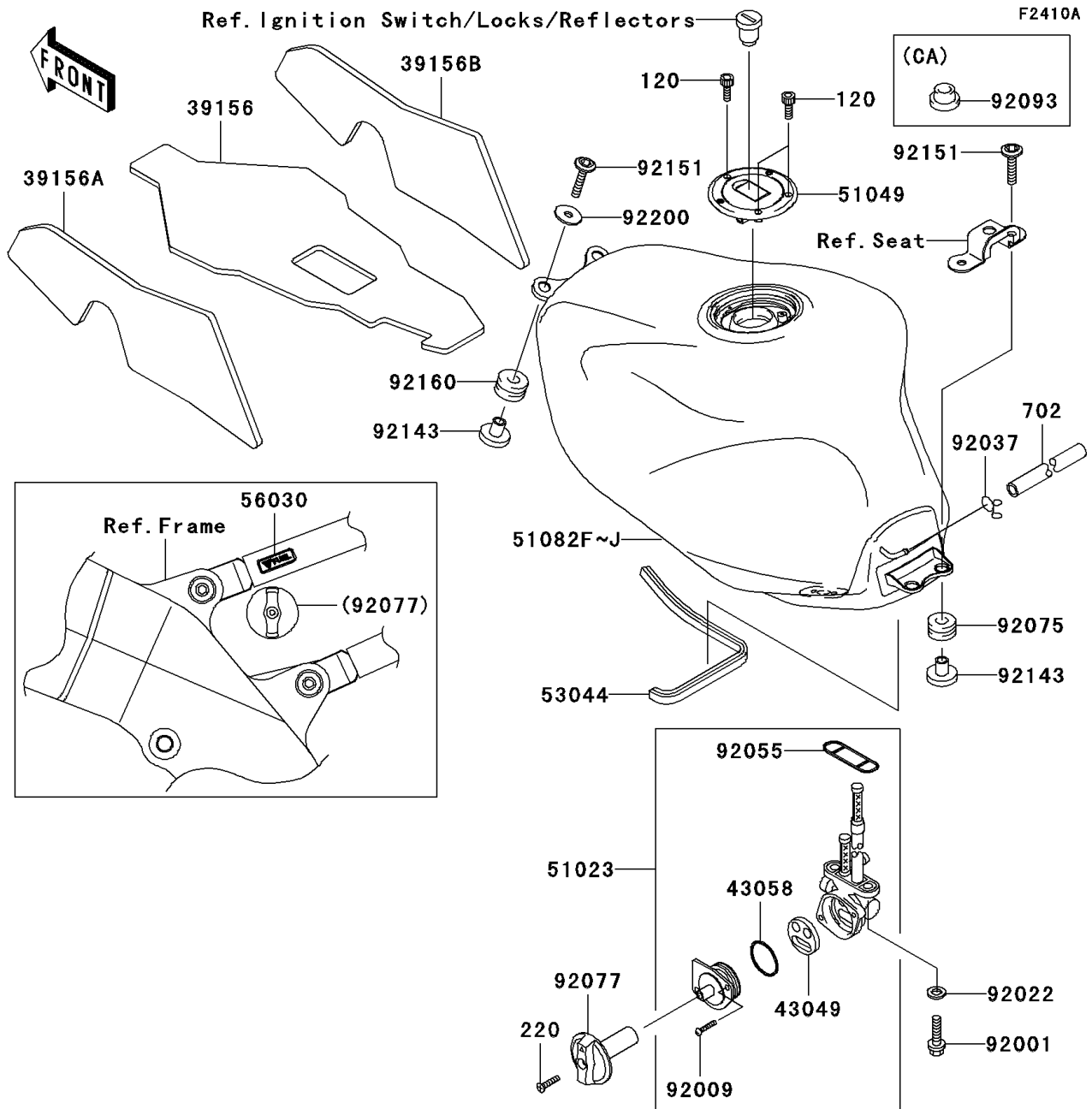
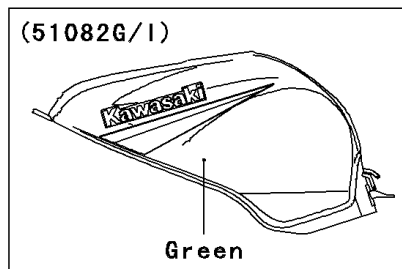

WD

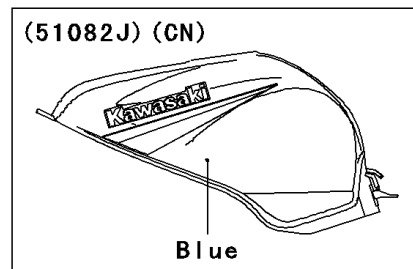

WD

2003 Ninja® ZX™ -9R PARTS LIST

Fuel Tank(ZX900-F2)

| ITEM NAME | PART NUMBER | QUANTITY |
|--|----------------|----------|
| PAD,FUEL TANK,CNT (Ref # 39156) | 39156-1600 | 1 |
| PAD,FUEL TANK,LH (Ref # 39156A) | 39156-1601 | 1 |
| PAD,FUEL TANK,RH (Ref # 39156B) | 39156-1602 | 1 |
| PACKING,TAP VALVE (Ref # 43049) | 43049-1099 | 1 |
| RING,TAP LEVER (Ref # 43058) | 43058-1083 | 1 |
| TAP-ASSY,FUEL (Ref # 51023) | 51023-1318 | 1 |
| CAP-TANK,FUEL (Ref # 51049) | 51049-1127 | 1 |
| TRIM,L=490 (Ref # 53044) | 53044-1209 | 1 |
| LABEL,FUEL TAP (Ref # 56030) | 56030-1195 | 1 |
| BOLT,6X25 (Ref # 92001) | 92001-1524 | 2 |
| SCREW,3X8 (Ref # 92009) | 92009-1386 | 2 |
| WASHER,6.2X11X1.5 (Ref # 92022) | 92022-183 | 2 |
| CLAMP,TUBE (Ref # 92037) | 92037-010 | 1 |
| RING-O,FUEL TAP PACKING (Ref # 92055) | 92055-1112 | 1 |
| DAMPER (Ref # 92075) | 92075-209 | 2 |
| KNOB,FUEL TAP (Ref # 92077) | 92077-1123 | 1 |
| BOLT-SOCKET (Ref # 120) | 120S0516 | 3 |
| SCREW-PAN-CROSS (Ref # 220) | 220C0416 | 1 |
| TUBE-RUBBER,6X520 (Ref # 702) | 702A06520 | 1 |
| COLLAR (Ref # 92143) | 92143-1515 | 4 |
| BOLT,SOCKET,6X30 (Ref # 92151) | 92151-1605 | 4 |
| DAMPER (Ref # 92160) | 92160-1162 | 2 |
| WASHER,6.5X22X1.6 (Ref # 92200) | 92200-1087 | 2 |
| TANK-COMP-FUEL,M.S.SILVER (Ref # 51082F) | 51082-5397-474 | 1 |
| TANK-COMP-FUEL,L.GREEN (Ref # 51082G) | 51082-5398-7F | 1 |
| TANK-COMP-FUEL,M.S.SILVER (Ref # 51082H) | 51082-5412-474 | 1 |
| TANK-COMP-FUEL,L.GREEN (Ref # 51082I) | 51082-5413-7F | 1 |
| TANK-COMP-FUEL,M.C.BLUE (Ref # 51082J) | 51082-5427-469 | 1 |
| SEAL,FUEL TANK CAP (Ref # 92093) | 92093-1030 | 1 |