

1992 KDX200 PARTS DIAGRAM

Front Fork(KDX200-E4)

F2340

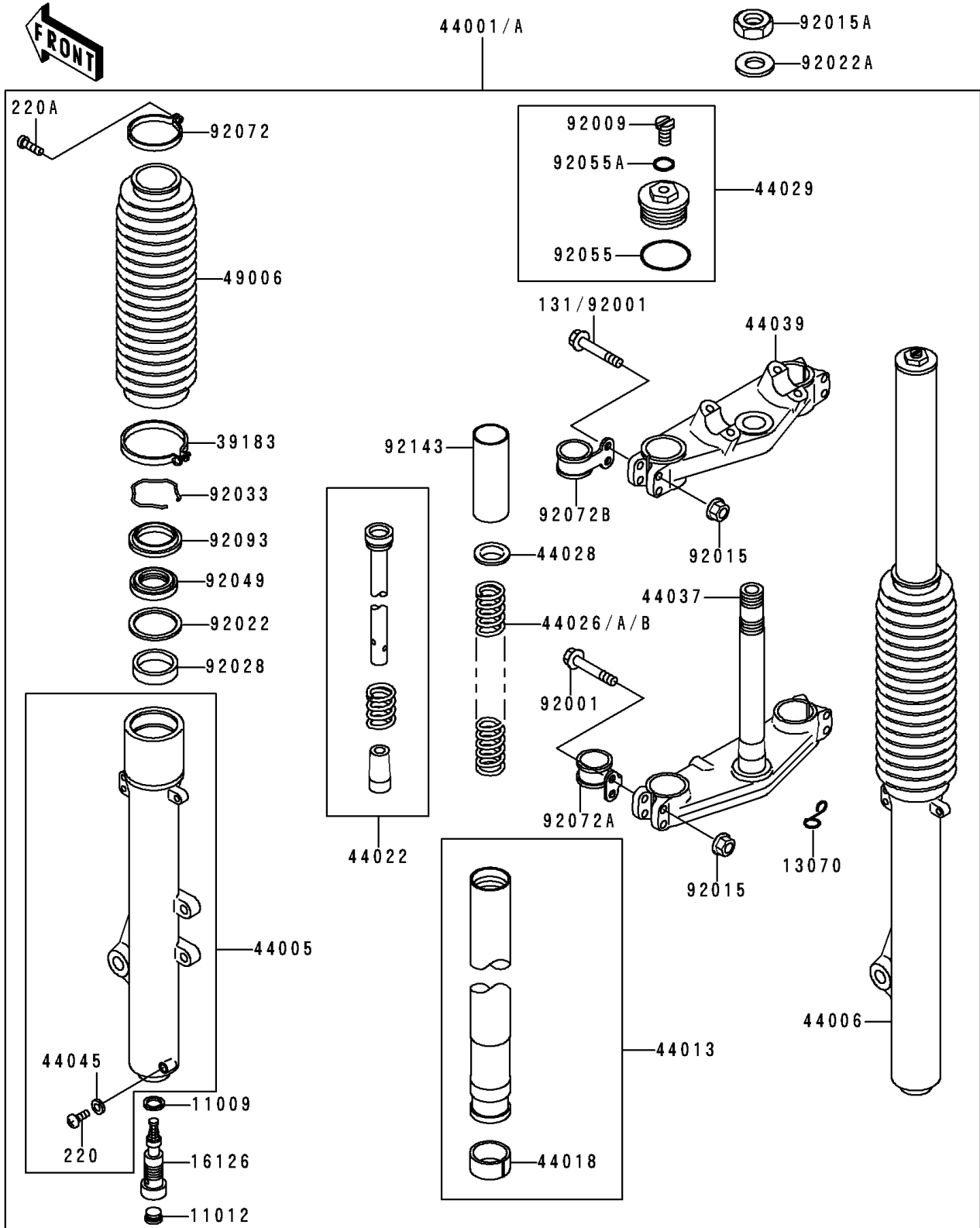

1992 KDX200 PARTS LIST

Front Fork(KDX200-E4)

ITEM NAME	PART NUMBER	QUANTITY
GASKET,FORK CYLINDER BOLT (Ref # 11009)	11009-1324	2
CAP,FORK CYLINDER (Ref # 11012)	11012-1381	2
GUIDE,CABLE (Ref # 13070)	13070-1208	1
VALVE,FORK CYLINDER (Ref # 16126)	16126-1134	2
BAND-ASSY,BOOT (Ref # 39183)	39183-1051	2
PIPE-LEFT FORK OUTER (Ref # 44005)	44005-1286	1
PIPE-RIGHT FORK OUTER (Ref # 44006)	44006-1300	1
PIPE-FORK INNER (Ref # 44013)	44013-1300	2
PISTON-FORK,INNER PIPE (Ref # 44018)	44018-1056	2
CYLINDER-FORK (Ref # 44022)	44022-1240	2
SPRING-FRONT FORK,K=0.30 (Ref # 44026)	44026-1401	2
SPRING-FRONT FORK,K=0.29 (Ref # 44026A)	44026-1430	2
SPRING-FRONT FORK,K=0.31 (Ref # 44026B)	44026-1431	2
GUIDE-FORK SPRING (Ref # 44028)	44028-1010	2
SEAT-FORK SPRING (Ref # 44029)	44029-1137	2
HOLDER-FORK UNDER (Ref # 44037)	44037-1248	1
HOLDER-FORK UPPER (Ref # 44039)	44039-1154	1
GASKET,FORK DRAIN PLUG (Ref # 44045)	44045-002	2
BOOT,FORK,BLUE NO.32 (Ref # 49006)	49006-1184-GF	2
SCREW (Ref # 92009)	92009-1568	2
NUT,FLANGED,8MM (Ref # 92015)	92015-1485	8
NUT,STEERING STEM,22MM (Ref # 92015A)	92015-1653	1
WASHER (Ref # 92022)	92022-1299	2
WASHER,STEERING STEM (Ref # 92022A)	92022-1873	1
BUSHING (Ref # 92028)	92028-1581	2
RING-SNAP (Ref # 92033)	92033-1077	2
SEAL-OIL,FORK OUTER TUBE (Ref # 92049)	92049-1295	2
RING-O (Ref # 92055)	92055-1123	2
RING-O (Ref # 92055A)	92055-1441	2

1992 KDX200 PARTS LIST

Front Fork(KDX200-E4)

ITEM NAME	PART NUMBER	QUANTITY
BAND,BOOT (Ref # 92072)	92072-1078	2
BAND,CABLE (Ref # 92072A)	92072-1205	1
BAND (Ref # 92072B)	92072-1246	1
SCREW-PAN-CROS (Ref # 220)	220B0408	2
SCREW-PAN-CROS (Ref # 220A)	220B0416	2
SEAL,FORK DUST (Ref # 92093)	92093-1086	2
COLLAR,FORK,L=110 (Ref # 92143)	92143-1328	2
FORK-FRONT,BLUE NO.32 (Ref # 44001)	44001-1711-GF	1
FORK-FRONT,BLUE NO.32 (Ref # 44001A)	44001-1733-GF	1
BOLT,FLANGED,8X55 (Ref # 92001)	92001-1639	4
BOLT,FLANGED,8X55 (Ref # 92001)	92001-1639	8
BOLT-FLANGED (Ref # 131)	131G0850	4