

# 2003 Vulcan 1600 Classic PARTS DIAGRAM

Throttle

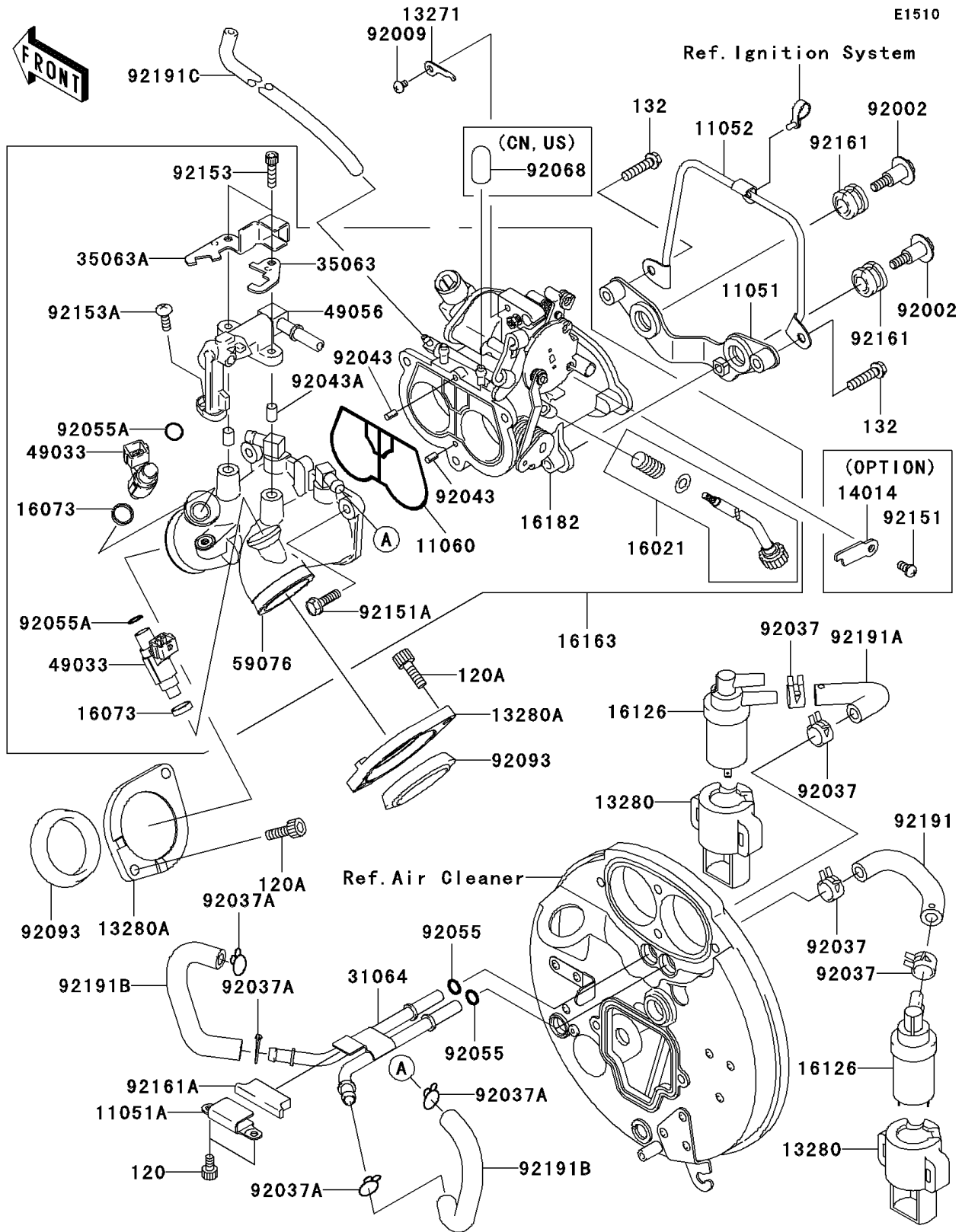

## 2003 Vulcan 1600 Classic PARTS LIST

### Throttle

ITEM NAME	PART NUMBER	QUANTITY
BRACKET (Ref # 11051)	11051-1333	1
BRACKET (Ref # 11051A)	11051-1345	1
BRACKET,HIGH TENSION CORD (Ref # 11052)	11052-1067	1
GASKET,THROTTLE BODY (Ref # 11060)	11060-1928	1
PLATE,STARTER CABLE (Ref # 13271)	13271-1314	1
HOLDER (Ref # 13280)	13280-1139	2
HOLDER (Ref # 13280A)	13280-1154	2
PLATE-POSITION,25KW (Ref # 14014)	14014-1142	1
SCREW-THROTTLE STOP (Ref # 16021)	16021-1227	1
INSULATOR (Ref # 16073)	16073-3707	2
VALVE (Ref # 16126)	16126-1372	2
THROTTLE-ASSY (Ref # 16163)	16163-1126	1
BODY-THROTTLE (Ref # 16182)	16182-0001	1
PIPE-COMP (Ref # 31064)	31064-1242	1
STAY (Ref # 35063)	35063-0030	1
STAY (Ref # 35063A)	35063-0038	1
NOZZLE-INJECTION (Ref # 49033)	49033-3707	2
PIPE-INJECTION (Ref # 49056)	49056-0002	1
MANIFOLD-INTAKE (Ref # 59076)	59076-0002	1
BOLT,FLANGED,M6X14X13.5 (Ref # 92002)	92002-1595	2
SCREW,4X6 (Ref # 92009)	92009-1903	1
CLAMP,HOSE CLIP (Ref # 92037)	92037-1181	4
CLAMP,FUEL TUBE (Ref # 92037A)	92037-1271	4
PIN,THROTTLE BODY (Ref # 92043)	92043-1600	2
PIN,DELIVERY PIPE (Ref # 92043A)	92043-1601	2
RING-O,7.8X3.5 (Ref # 92055)	92055-029	2
RING-O,INJECTION NOZZLE (Ref # 92055A)	92055-1622	2
SEAL (Ref # 92093)	92093-1484	2
BOLT,M5X10,25KW (Ref # 92151)	92151-1528	1

## 2003 Vulcan 1600 Classic PARTS LIST

### Throttle

ITEM NAME	PART NUMBER	QUANTITY
BOLT,THROTTLE BODY (Ref # 92151A)	92151-1587	3
BOLT,5X20 (Ref # 92153)	92153-0378	2
BOLT (Ref # 92153A)	92153-0379	1
DAMPER (Ref # 92161)	92161-1058	2
DAMPER (Ref # 92161A)	92161-1062	1
TUBE,REAR VALVE,RED (Ref # 92191)	92191-1367	1
TUBE,FRONT VALVE,BLUE (Ref # 92191A)	92191-1368	1
BOLT-SOCKET,M5X10 (Ref # 120)	120S0510	2
BOLT-SOCKET,M6X20 (Ref # 120A)	120Z0620	4
BOLT-FLANGED-SMALL,M6X25 (Ref # 132)	132J0625	2
TUBE (Ref # 92191B)	92191-1608	2
TUBE,THROTTLE-BOOST SENSOR (Ref # 92191C)	92191-1821	1
PLUG,12X25 (Ref # 92068)	92068-006	1