

# 2010 Super Sherpa (Canada Only) PARTS DIAGRAM

Starter Motor

E1840

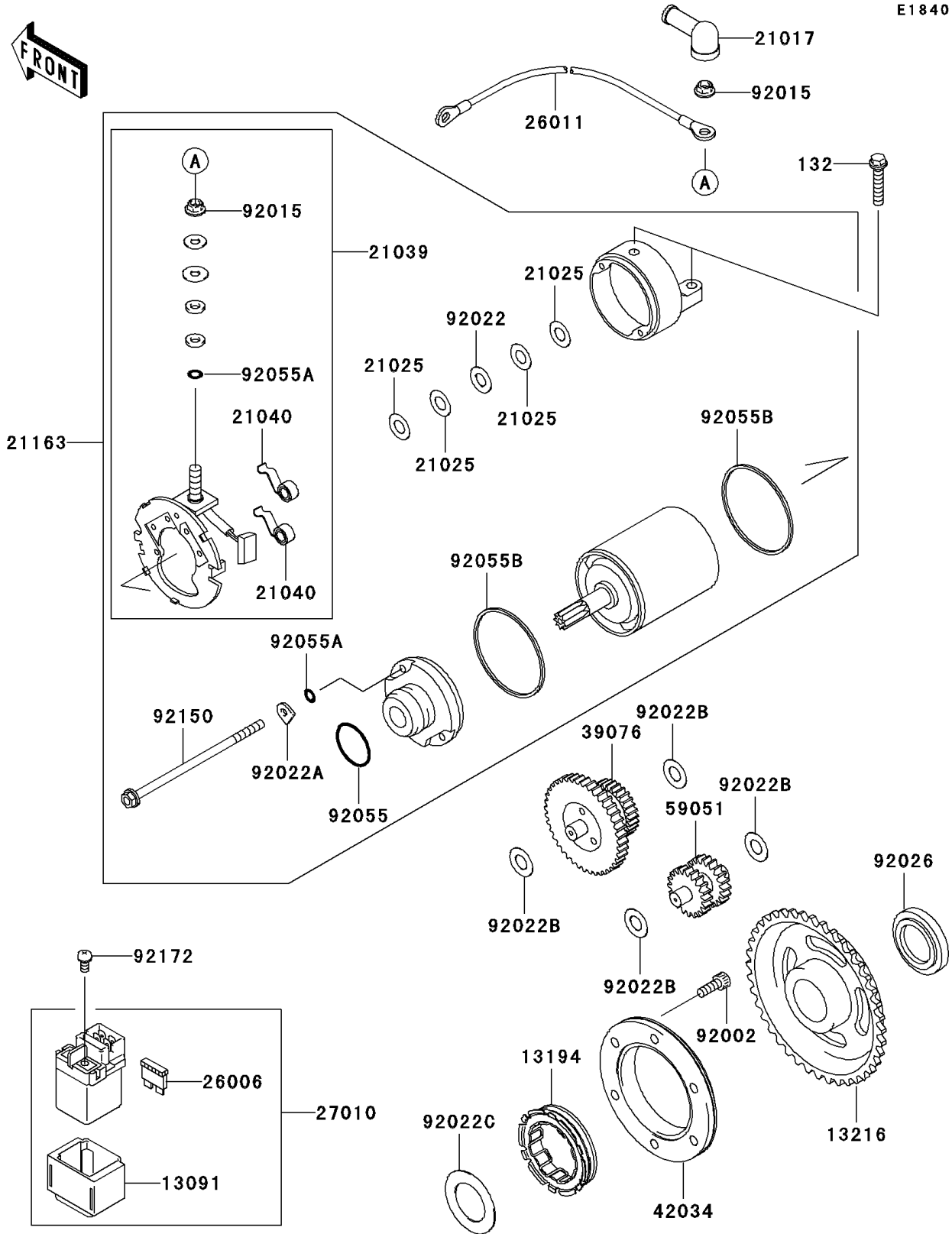

## 2010 Super Sherpa (Canada Only) PARTS LIST

### Starter Motor

ITEM NAME	PART NUMBER	QUANTITY
BOLT-FLANGED-SMALL,6X30 (Ref # 132)	132BC0630	2
HOLDER (Ref # 13091)	13091-1992	1
CLUTCH-ONEWAY (Ref # 13194)	13194-1091	1
GEAR-COMP,ONEWAY CLUTCH (Ref # 13216)	13216-1148	1
GROMMET,STARTER TERMINAL (Ref # 21017)	21017-017	1
WASHER,9.1X18X0.2 (Ref # 21025)	21025-011	AR
BRUSH,CARBON (Ref # 21039)	21039-1062	1
SPRING-BRUSH (Ref # 21040)	21040-1057	2
STARTER-ELECTRIC (Ref # 21163)	21163-1256	1
FUSE,20A-Y (Ref # 26006)	26006-1051	1
WIRE-LEAD (Ref # 26011)	26011-1604	1
SWITCH (Ref # 27010)	27010-0004	1
LIMITER,STARTER IDLER GEAR (Ref # 39076)	39076-1069	1
COUPLING (Ref # 42034)	42034-1181	1
GEAR-SPUR,IDLE (Ref # 59051)	59051-1304	1
BOLT,SOCKET,6X16 (Ref # 92002)	92002-1778	6
NUT,STARTER MOTOR (Ref # 92015)	92015-1476	2
WASHER,9.1X18X0.8 (Ref # 92022)	92022-1132	1
WASHER,LOCK,T=2.0 (Ref # 92022A)	92022-1458	2
WASHER,10.2X20X0.5 (Ref # 92022B)	92022-1649	4
WASHER,27.2X44X1.0 (Ref # 92022C)	92022-1781	1
SPACER (Ref # 92026)	92026-1450	1
RING-O (Ref # 92055)	92055-1276	1
RING-O,4.5X2.0 (Ref # 92055A)	92055-1370	3
RING-O,STARTER MOTOR (Ref # 92055B)	92055-1381	2
BOLT,STARTER MOTOR (Ref # 92150)	92150-1838	2
SCREW-PAN-WS-CROS,5X10 (Ref # 92172)	92172-0234	2