

2010 Vulcan® 1700 Classic LT PARTS DIAGRAM

Front Fork

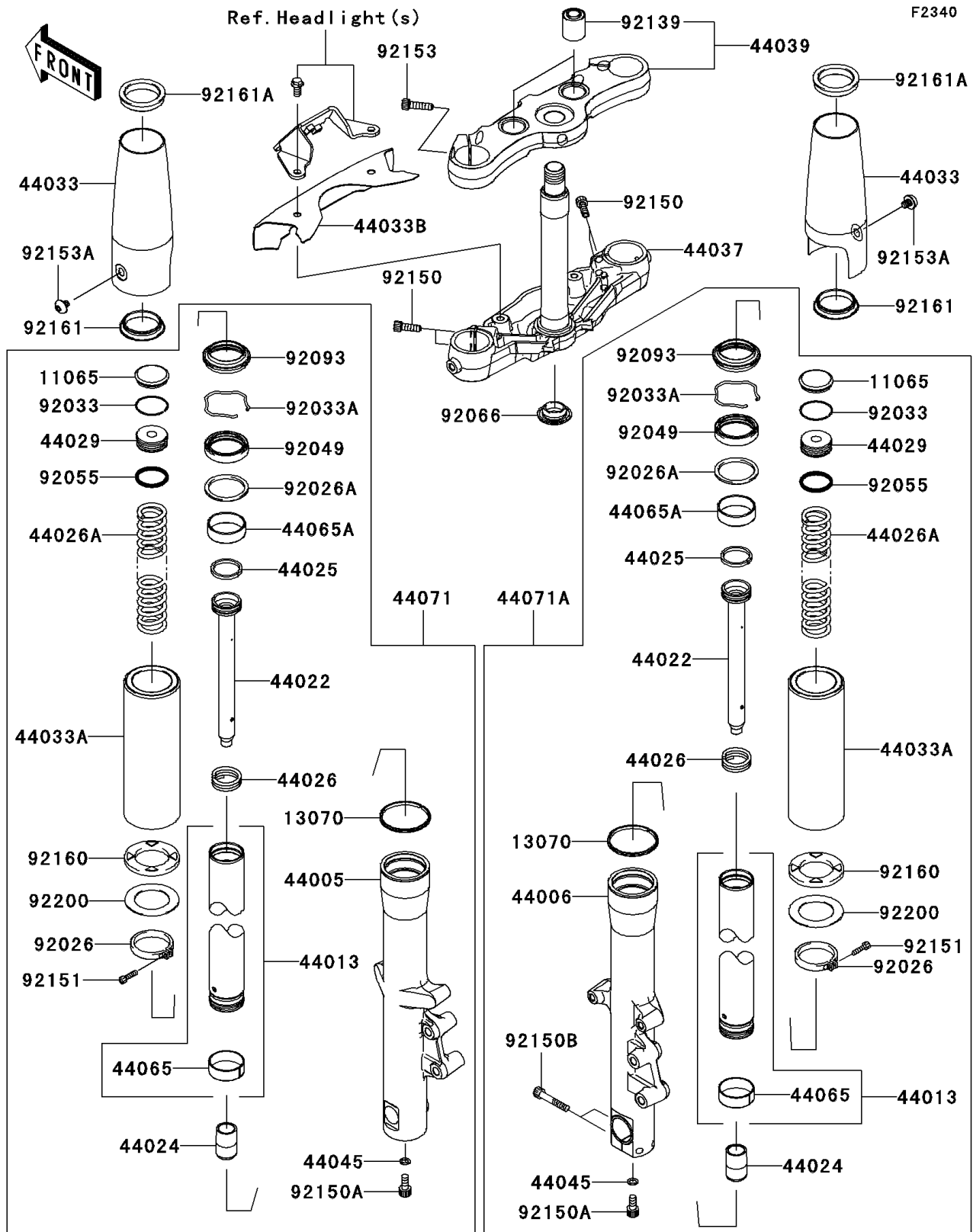

2010 Vulcan® 1700 Classic LT PARTS LIST

Front Fork

ITEM NAME	PART NUMBER	QUANTITY
CAP,FORK TOP (Ref # 11065)	11065-0297	2
GUIDE,CASE (Ref # 13070)	13070-0104	2
PIPE-LEFT FORK OUTER (Ref # 44005)	44005-0074	1
PIPE-RIGHT FORK OUTER (Ref # 44006)	44006-0068	1
PIPE-FORK INNER (Ref # 44013)	44013-0125	2
CYLINDER-FORK (Ref # 44022)	44022-0025	2
CAP-OIL-LOCK (Ref # 44024)	44024-0006	2
RING-FORK PISTON (Ref # 44025)	44025-0006	2
SPRING-FRONT FORK (Ref # 44026)	44026-0131	2
SPRING-FRONT FORK (Ref # 44026A)	44026-0132	2
SEAT-FORK SPRING (Ref # 44029)	44029-0013	2
COVER-FORK (Ref # 44033)	44033-0053	2
COVER-FORK (Ref # 44033A)	44033-0055	2
COVER-FORK (Ref # 44033B)	44033-0057	1
HOLDER-FORK UNDER (Ref # 44037)	44037-0087	1
HOLDER-FORK UPPER (Ref # 44039)	44039-0100	1
GASKET,FORK CYLINDER BOLT (Ref # 44045)	44045-051	2
BUSHING-FRONT FORK,INNER TUBE (Ref # 44065)	44065-0025	2
BUSHING-FRONT FORK (Ref # 44065A)	44065-0026	2
DAMPER-ASSY,FORK,LH (Ref # 44071)	44071-0529	1
DAMPER-ASSY,FORK,RH (Ref # 44071A)	44071-0530	1
SPACER (Ref # 92026)	92026-0134	2
SPACER (Ref # 92026A)	92026-1598	2
RING-SNAP (Ref # 92033)	92033-0061	2
RING-SNAP (Ref # 92033A)	92033-1222	2
SEAL-OIL (Ref # 92049)	92049-0119	2
RING-O,FORK TOP (Ref # 92055)	92055-1420	2
PLUG (Ref # 92066)	92066-0032	1
SEAL,DUST (Ref # 92093)	92093-0042	2

2010 Vulcan® 1700 Classic LT PARTS LIST

Front Fork

ITEM NAME	PART NUMBER	QUANTITY
BUSHING (Ref # 92139)	92139-0285	2
BOLT,SOCKET,8X30 (Ref # 92150)	92150-1407	4
BOLT,SOCKET,8X18 (Ref # 92150A)	92150-1432	2
BOLT,SOCKET (Ref # 92150B)	92150-1512	2
BOLT,SOCKET,4X16 (Ref # 92151)	92151-1356	2
BOLT,SOCKET,8X30 (Ref # 92153)	92153-0500	2
BOLT,SOCKET,8X10 (Ref # 92153A)	92153-1278	2
DAMPER (Ref # 92160)	92160-1927	2
DAMPER (Ref # 92161)	92161-0604	2
DAMPER (Ref # 92161A)	92161-0799	2
WASHER (Ref # 92200)	92200-0469	2