

2010 Vulcan® 1700 Classic LT PARTS DIAGRAM

Chassis Electrical Equipment

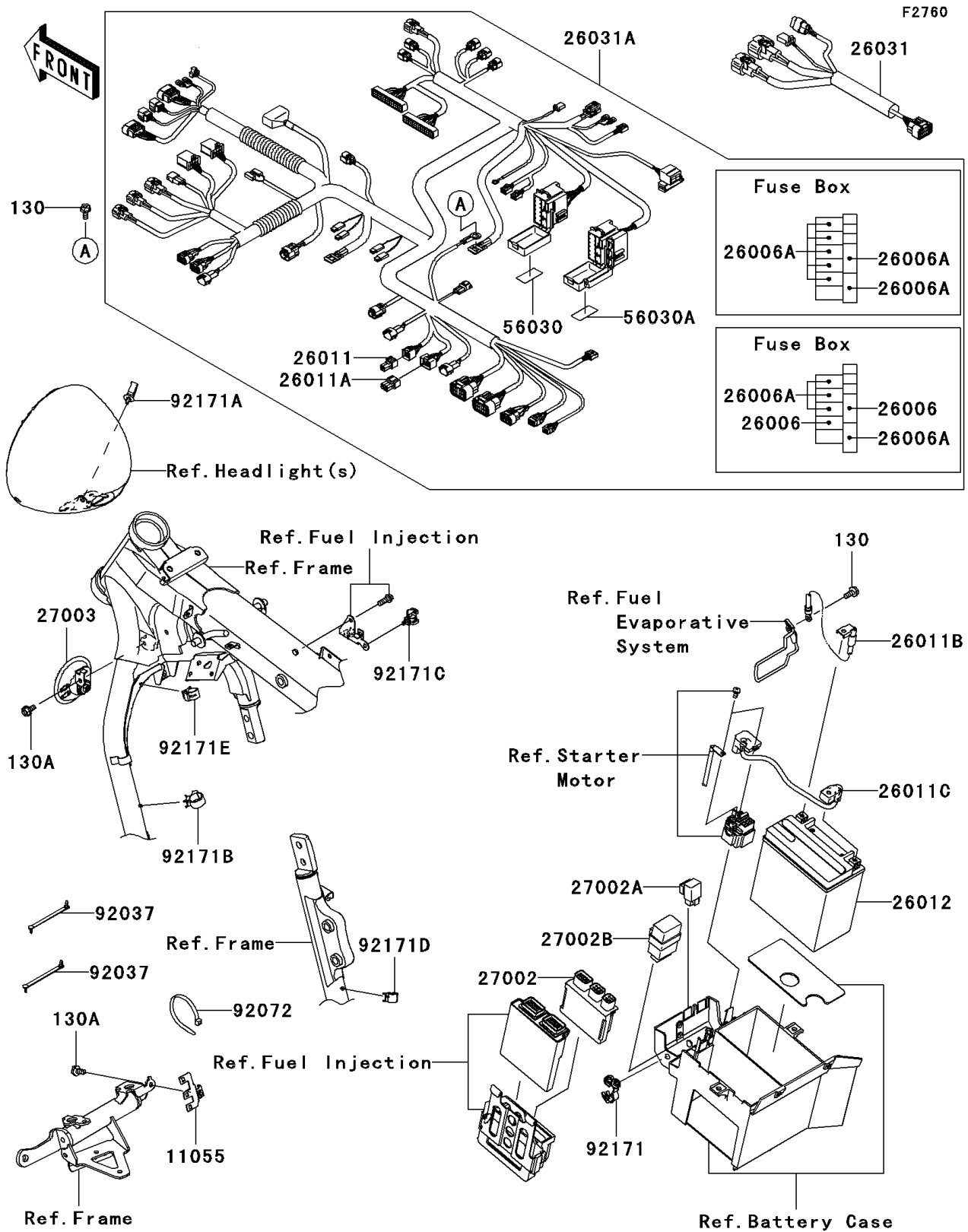

2010 Vulcan® 1700 Classic LT PARTS LIST

Chassis Electrical Equipment

ITEM NAME	PART NUMBER	QUANTITY
BOLT-FLANGED,6X14 (Ref # 130)	130BA0614	2
BOLT-FLANGED,6X12 (Ref # 130A)	130BB0612	2
BRACKET,CONNECTOR (Ref # 11055)	11055-0613	1
FUSE,15A (Ref # 26006)	26006-0001	2
FUSE,10A (Ref # 26006A)	26006-1078	11
WIRE-LEAD (Ref # 26011)	26011-0082	1
WIRE-LEAD (Ref # 26011A)	26011-0146	1
WIRE-LEAD,BATTERY(-) (Ref # 26011B)	26011-0180	1
WIRE-LEAD,BATTERY(+) (Ref # 26011C)	26011-0217	1
BATTERY,MF,FTZ16-BS,12V 18AH (Ref # 26012)	26012-1371	1
HARNESS,RR,SUB (Ref # 26031)	26031-0651	1
HARNESS,MAIN (Ref # 26031A)	26031-0714	1
RELAY-ASSY (Ref # 27002)	27002-0007	1
RELAY-ASSY (Ref # 27002A)	27002-1062	1
RELAY-ASSY,SIGNAL LAMP (Ref # 27002B)	27002-1113	1
HORN (Ref # 27003)	27003-0055	1
LABEL,FUSE BOX (Ref # 56030)	56030-0217	1
LABEL,FUSE BOX (Ref # 56030A)	56030-0291	1
CLAMP,SPEED,L=80.5 (Ref # 92037)	92037-1903	2
BAND,L=202 (Ref # 92072)	92072-1195	1
CLAMP,CLIP,DIA=20 (Ref # 92171)	92171-0068	1
CLAMP,DIA=20 (Ref # 92171A)	92171-0069	1
CLAMP,DIA=20 (Ref # 92171B)	92171-0081	1
CLAMP,DIA=13 (Ref # 92171C)	92171-1415	1
CLAMP,DIA=10 (Ref # 92171D)	92171-1423	1
CLAMP,DIA=15 (Ref # 92171E)	92171-1424	1