

Mule 2520 Turf PARTS DIAGRAM

Frame Fittings(Lever)

F2131A

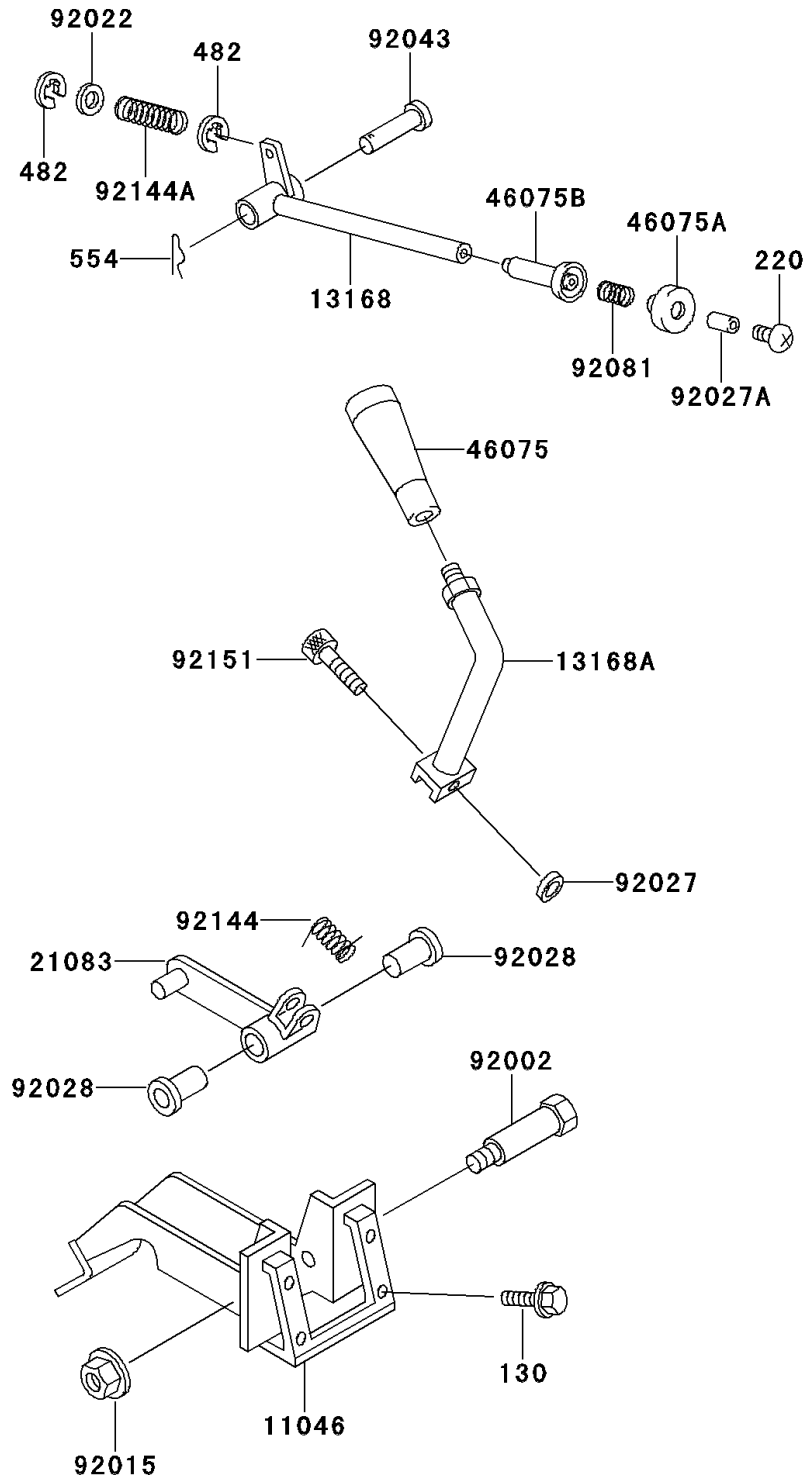

Mule 2520 Turf PARTS LIST

Frame Fittings(Lever)

| ITEM NAME | PART NUMBER | QUANTITY |
|---------------------------------------|-------------|----------|
| BOLT-FLANGED,6X12 (Ref # 130) | 130C0612 | 4 |
| SCREW-PAN-CROS (Ref # 220) | 220C0514 | 1 |
| CIRCLIP-TYPE-E,8MM (Ref # 482) | 482L8000 | 2 |
| PIN-SNAP,10MM (Ref # 554) | 554A1000 | 1 |
| BRACKET,SHIFT LEVER (Ref # 11046) | 11046-1677 | 1 |
| LEVER,DIFF MODE CONTROL (Ref # 13168) | 13168-1428 | 1 |
| LEVER,SHIFT (Ref # 13168A) | 13168-1440 | 1 |
| ARM,SHIFT LEVER (Ref # 21083) | 21083-1085 | 1 |
| GRIP,SHIFT LEVER (Ref # 46075) | 46075-1075 | 1 |
| GRIP,UPP (Ref # 46075A) | 46075-1085 | 1 |
| GRIP,LWR (Ref # 46075B) | 46075-1086 | 1 |
| BOLT (Ref # 92002) | 92002-1984 | 1 |
| NUT,LOCK,FLANGED,6MM (Ref # 92015) | 92015-1675 | 2 |
| WASHER,10.5X26X2.3 (Ref # 92022) | 92022-044 | 1 |
| COLLAR,6.3X10X4.8 (Ref # 92027) | 92027-1066 | 1 |
| COLLAR (Ref # 92027A) | 92027-1987 | 1 |
| BUSHING (Ref # 92028) | 92028-1507 | 2 |
| PIN,10X34 (Ref # 92043) | 92043-1069 | 1 |
| SPRING (Ref # 92081) | 92081-1714 | 1 |
| SPRING (Ref # 92144) | 92144-1175 | 1 |
| SPRING (Ref # 92144A) | 92144-1510 | 1 |
| BOLT,SOCKET,6X40 (Ref # 92151) | 92151-1128 | 1 |