

2008 Teryx® 750 4X4 PARTS DIAGRAM

Rear Suspension

F2153

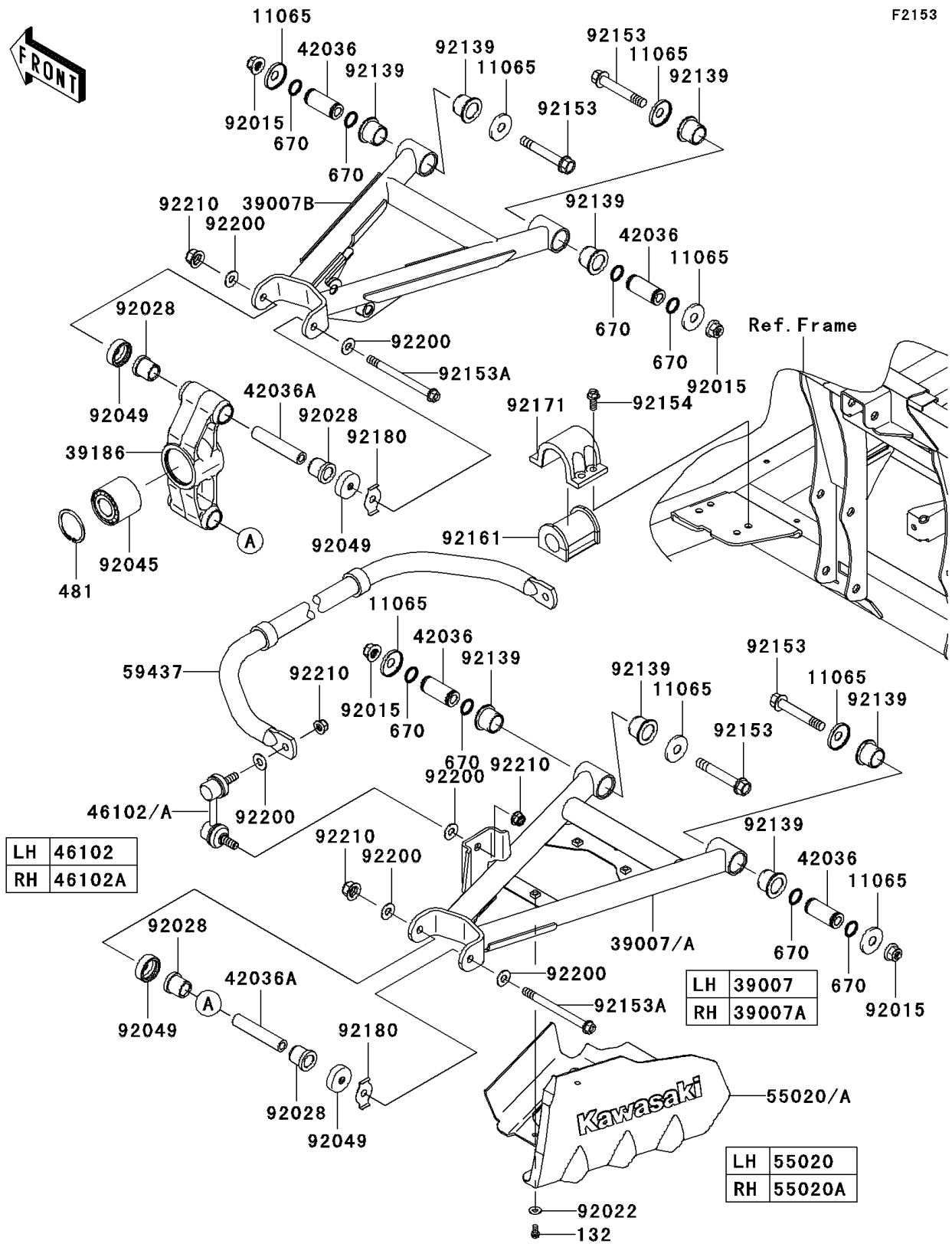

LH	46102
RH	46102A

LH	39007
RH	39007A

LH	55020
RH	55020A

2008 Teryx® 750 4X4 PARTS LIST

Rear Suspension

ITEM NAME	PART NUMBER	QUANTITY
BOLT-FLANGED-SMALL,6X12 (Ref # 132)	132BB0612	6
CIRCLIP (Ref # 481)	481J5200	2
O RING,18MM (Ref # 670)	670B2018	16
CAP (Ref # 11065)	11065-0253	16
ARM-SUSP,RR,LWR,LH (Ref # 39007)	39007-0128	1
ARM-SUSP,RR,LWR,RH (Ref # 39007A)	39007-0129	1
ARM-SUSP,RR,UPP,LH&RH (Ref # 39007B)	39007-0143	2
KNUCKLE,RR,LH&RH (Ref # 39186)	39186-0071	2
SLEEVE (Ref # 42036)	42036-0062	8
SLEEVE,10X17X85.6 (Ref # 42036A)	42036-1190	4
ROD,STABILIZER,LH (Ref # 46102)	46102-0100	1
ROD,STABILIZER,RH (Ref # 46102A)	46102-0101	1
GUARD,RR,LH (Ref # 55020)	55020-0310	1
GUARD,RR,RH (Ref # 55020A)	55020-0311	1
STABILIZER (Ref # 59437)	59437-0006	1
NUT,LOCK,FLANGED,12MM (Ref # 92015)	92015-1433	8
WASHER,7X16X1.2 (Ref # 92022)	92022-1344	6
BUSHING (Ref # 92028)	92028-1466	8
BEARING-BALL,DAC2552W-7CS31 (Ref # 92045)	92045-0102	2
SEAL-OIL,KNUCKLE (Ref # 92049)	92049-1198	8
BUSHING (Ref # 92139)	92139-0231	16
BOLT,FLANGED,12X76.5 (Ref # 92153)	92153-1733	8
BOLT,FLANGED,10X117 (Ref # 92153A)	92153-1966	4
BOLT,FLANGED,8X20 (Ref # 92154)	92154-0100	8
DAMPER (Ref # 92161)	92161-0539	2
CLAMP (Ref # 92171)	92171-1695	2
SHIM (Ref # 92180)	92180-0292	AR
WASHER,10.3X23X1.6 (Ref # 92200)	92200-2009	12
NUT,LOCK,FLANGED,10MM (Ref # 92210)	92210-0276	8