

2013 BRUTE FORCE® 750 4x4i EPS PARTS DIAGRAM

Drive Shaft-Front

E3136

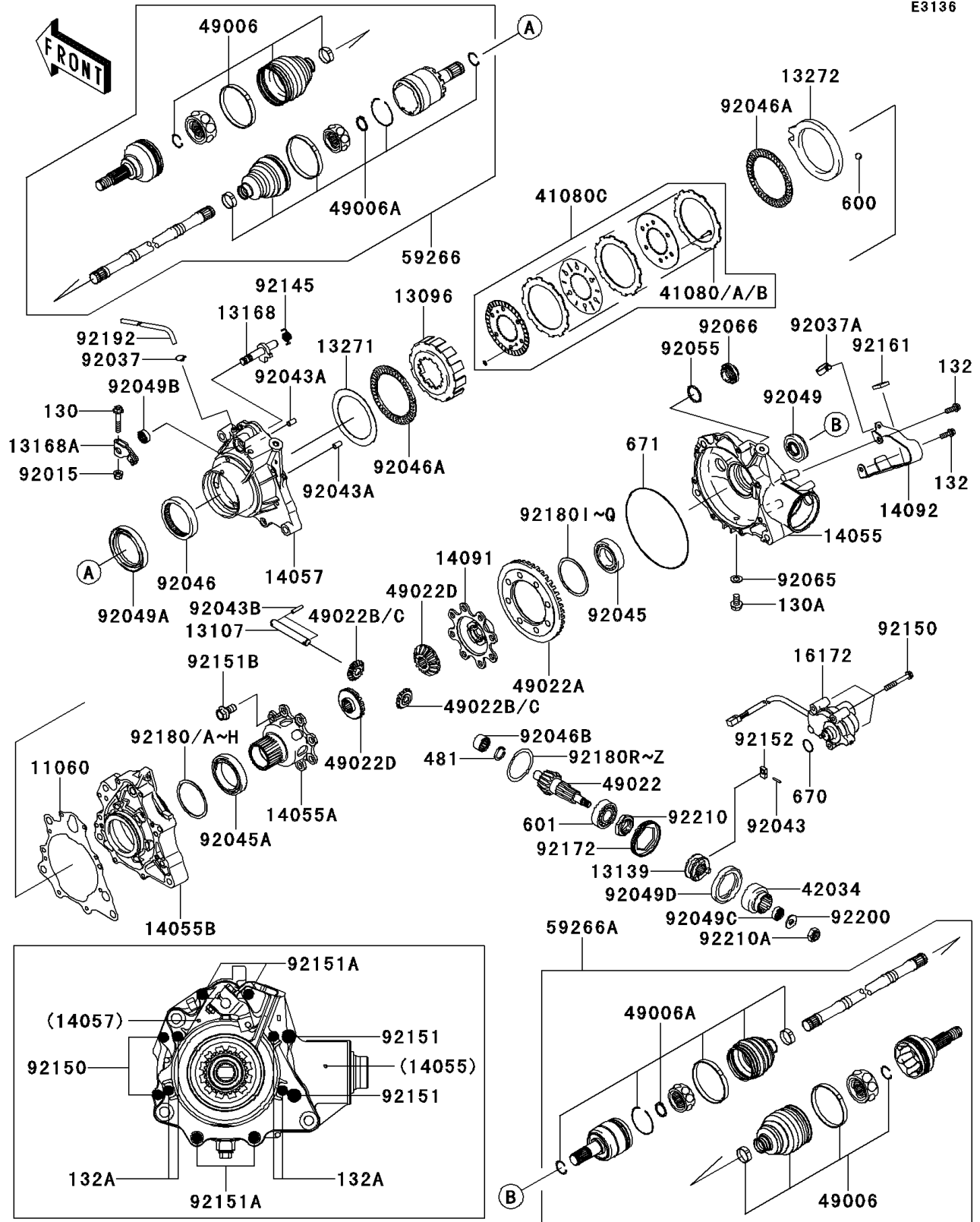

2013 BRUTE FORCE® 750 4x4i EPS PARTS LIST

Drive Shaft-Front

| ITEM NAME | PART NUMBER | QUANTITY |
|--|-------------|----------|
| GASKET,DIFF CASE (Ref # 11060) | 11060-1982 | 1 |
| HOUSING-CLUTCH,DISC (Ref # 13096) | 13096-1163 | 1 |
| SHAFT,CROSS (Ref # 13107) | 13107-0123 | 1 |
| SHIFTER,DIFFERENTIAL (Ref # 13139) | 13139-1097 | 1 |
| LEVER,DIFF (Ref # 13168) | 13168-1724 | 1 |
| LEVER,DIFFERENTIAL (Ref # 13168A) | 13168-1725 | 1 |
| PLATE,DISC (Ref # 13271) | 13271-1503 | 1 |
| PLATE,CAM (Ref # 13272) | 13272-0848 | 1 |
| CASE-GEAR (Ref # 14055) | 14055-0046 | 1 |
| CASE-GEAR,BEVEL,LH (Ref # 14055A) | 14055-0601 | 1 |
| CASE-GEAR,CENTER (Ref # 14055B) | 14055-1155 | 1 |
| CASE-COMP-GEAR,DIFF,LH (Ref # 14057) | 14057-1004 | 1 |
| COVER,BEVEL,RH (Ref # 14091) | 14091-1197 | 1 |
| COVER (Ref # 14092) | 14092-0202 | 1 |
| ACTUATOR (Ref # 16172) | 16172-0007 | 1 |
| DISC,T=1.20 (Ref # 41080) | 41080-1499 | AR |
| DISC,T=1.80 (Ref # 41080A) | 41080-1500 | AR |
| DISC,T=2.40 (Ref # 41080B) | 41080-1501 | AR |
| DISC ASSY,DIFFERENTIAL LOCK (Ref # 41080C) | 41080-1512 | 1 |
| COUPLING,BEVEL (Ref # 42034) | 42034-1192 | 1 |
| BOOT,UJ (Ref # 49006) | 49006-0073 | 2 |
| BOOT,DOJ (Ref # 49006A) | 49006-0074 | 2 |
| GEAR-BEVEL,8T (Ref # 49022) | 49022-0051 | 1 |
| GEAR-BEVEL,35T (Ref # 49022A) | 49022-0564 | 1 |
| GEAR-BEVEL,10T (Ref # 49022B) | 49022-0575 | 2 |
| GEAR-BEVEL,16T (Ref # 49022D) | 49022-1178 | 2 |
| JOINT-BALL (Ref # 59266) | 59266-0024 | 1 |
| JOINT-BALL (Ref # 59266A) | 59266-0025 | 1 |
| NUT,LOCK,FLANGED,6MM (Ref # 92015) | 92015-1339 | 1 |

2013 BRUTE FORCE® 750 4x4i EPS PARTS LIST

Drive Shaft-Front

| ITEM NAME | PART NUMBER | QUANTITY |
|---|-------------|----------|
| CLAMP,HOSE (Ref # 92037) | 92037-1104 | 1 |
| CLAMP,HOSE (Ref # 92037A) | 92037-1827 | 1 |
| PIN,2X10.5 (Ref # 92043) | 92043-0083 | 1 |
| PIN,6.2X8X14 (Ref # 92043A) | 92043-1263 | 2 |
| PIN (Ref # 92043B) | 92043-1575 | 2 |
| BEARING-BALL,60/32 (Ref # 92045) | 92045-1393 | 1 |
| BEARING-BALL,6910 (Ref # 92045A) | 92045-1394 | 1 |
| BEARING-NEEDLE (Ref # 92046) | 92046-0028 | 1 |
| BEARING-NEEDLE,AK1116 (Ref # 92046A) | 92046-1286 | 2 |
| BEARING-NEEDLE,AJ501515W (Ref # 92046B) | 92046-1297 | 1 |
| SEAL-OIL,SDD7 22X48X7HS (Ref # 92049) | 92049-1534 | 1 |
| SEAL-OIL,HTCY 62X81X10.5 (Ref # 92049A) | 92049-1536 | 1 |
| SEAL-OIL,TC 12X22X7 (Ref # 92049B) | 92049-1550 | 1 |
| SEAL-OIL,KB 13X19X13 (Ref # 92049C) | 92049-1572 | 1 |
| SEAL-OIL,TCY 48X65X8 (Ref # 92049D) | 92049-1573 | 1 |
| RING-O (Ref # 92055) | 92055-0122 | 1 |
| GASKET (Ref # 92065) | 92065-023 | 1 |
| PLUG (Ref # 92066) | 92066-1303 | 1 |
| SPRING,DIFF RETURN (Ref # 92145) | 92145-1344 | 1 |
| BOLT,6X45 (Ref # 92150) | 92150-1884 | 5 |
| BOLT,8X50 (Ref # 92151) | 92151-1794 | 2 |
| BOLT,6X60 (Ref # 92151A) | 92151-1795 | 4 |
| BOLT,10X19.5 (Ref # 92151B) | 92151-1910 | 8 |
| COLLAR (Ref # 92152) | 92152-1349 | 1 |
| DAMPER,20X20X5 (Ref # 92161) | 92161-1387 | 1 |
| SCREW,SET,64X10 (Ref # 92172) | 92172-0719 | 1 |
| SHIM,62X71X0.15 (Ref # 92180) | 92180-1390 | AR |
| SHIM,62X71X0.20 (Ref # 92180A) | 92180-1391 | AR |
| SHIM,62X71X0.50 (Ref # 92180B) | 92180-1392 | AR |

2013 BRUTE FORCE® 750 4x4i EPS PARTS LIST

Drive Shaft-Front

| ITEM NAME | PART NUMBER | QUANTITY |
|--------------------------------------|-------------|----------|
| SHIM,62X71X0.70 (Ref # 92180C) | 92180-1393 | AR |
| SHIM,62X71X0.80 (Ref # 92180D) | 92180-1394 | AR |
| SHIM,62X71X0.90 (Ref # 92180E) | 92180-1395 | AR |
| SHIM,62X71X1.00 (Ref # 92180F) | 92180-1396 | AR |
| SHIM,62X71X1.10 (Ref # 92180G) | 92180-1397 | AR |
| SHIM,62X71X1.20 (Ref # 92180H) | 92180-1398 | AR |
| SHIM,32X42X0.15 (Ref # 92180I) | 92180-1399 | AR |
| SHIM,32X42X0.20 (Ref # 92180J) | 92180-1400 | AR |
| SHIM,32X42X0.50 (Ref # 92180K) | 92180-1401 | AR |
| SHIM,32X42X0.70 (Ref # 92180L) | 92180-1402 | AR |
| SHIM,32X42X0.80 (Ref # 92180M) | 92180-1403 | AR |
| SHIM,32X42X0.90 (Ref # 92180N) | 92180-1404 | AR |
| SHIM,32X42X1.00 (Ref # 92180O) | 92180-1405 | AR |
| SHIM,32X42X1.10 (Ref # 92180P) | 92180-1406 | AR |
| SHIM,32X42X1.20 (Ref # 92180Q) | 92180-1407 | AR |
| SHIM,50X61X0.15 (Ref # 92180R) | 92180-1408 | AR |
| SHIM,50X61X0.20 (Ref # 92180S) | 92180-1409 | AR |
| SHIM,50X61X0.50 (Ref # 92180T) | 92180-1410 | AR |
| SHIM,50X61X0.70 (Ref # 92180U) | 92180-1411 | AR |
| SHIM,50X61X0.80 (Ref # 92180V) | 92180-1412 | AR |
| SHIM,50X61X0.90 (Ref # 92180W) | 92180-1413 | AR |
| SHIM,50X61X1.00 (Ref # 92180X) | 92180-1414 | AR |
| BOLT-FLANGED,6X35 (Ref # 130) | 130BA0635 | 1 |
| BOLT-FLANGED,8X14 (Ref # 130A) | 130BA0814 | 1 |
| BOLT-FLANGED-SMALL,6X16 (Ref # 132) | 132BA0616 | 2 |
| BOLT-FLANGED-SMALL,6X30 (Ref # 132A) | 132BD0630 | 4 |
| CIRCLIP-TYPE-C,25MM (Ref # 481) | 481J2500 | 1 |
| BALL-STEEL,11/32 (Ref # 600) | 600A1100 | 6 |
| BEARING-BALL,#6305 (Ref # 601) | 601A6305 | 1 |

2013 BRUTE FORCE® 750 4x4i EPS PARTS LIST

Drive Shaft-Front

| ITEM NAME | PART NUMBER | QUANTITY |
|--------------------------------|-------------|----------|
| O RING (Ref # 670) | 670D3022 | 1 |
| O RING (Ref # 671) | 671D25145 | 1 |
| SHIM,50X61X1.10 (Ref # 92180Y) | 92180-1415 | AR |
| SHIM,50X61X1.20 (Ref # 92180Z) | 92180-1416 | AR |
| TUBE,7X12X760 (Ref # 92192) | 92192-0716 | 1 |
| WASHER,10X24X2.5 (Ref # 92200) | 92200-1635 | 1 |
| NUT,25MM (Ref # 92210) | 92210-1225 | 1 |
| NUT,LOCK,10MM (Ref # 92210A) | 92210-1351 | 1 |