

# 2009 Brute Force® 650 4x4 PARTS DIAGRAM

Radiator

E3032

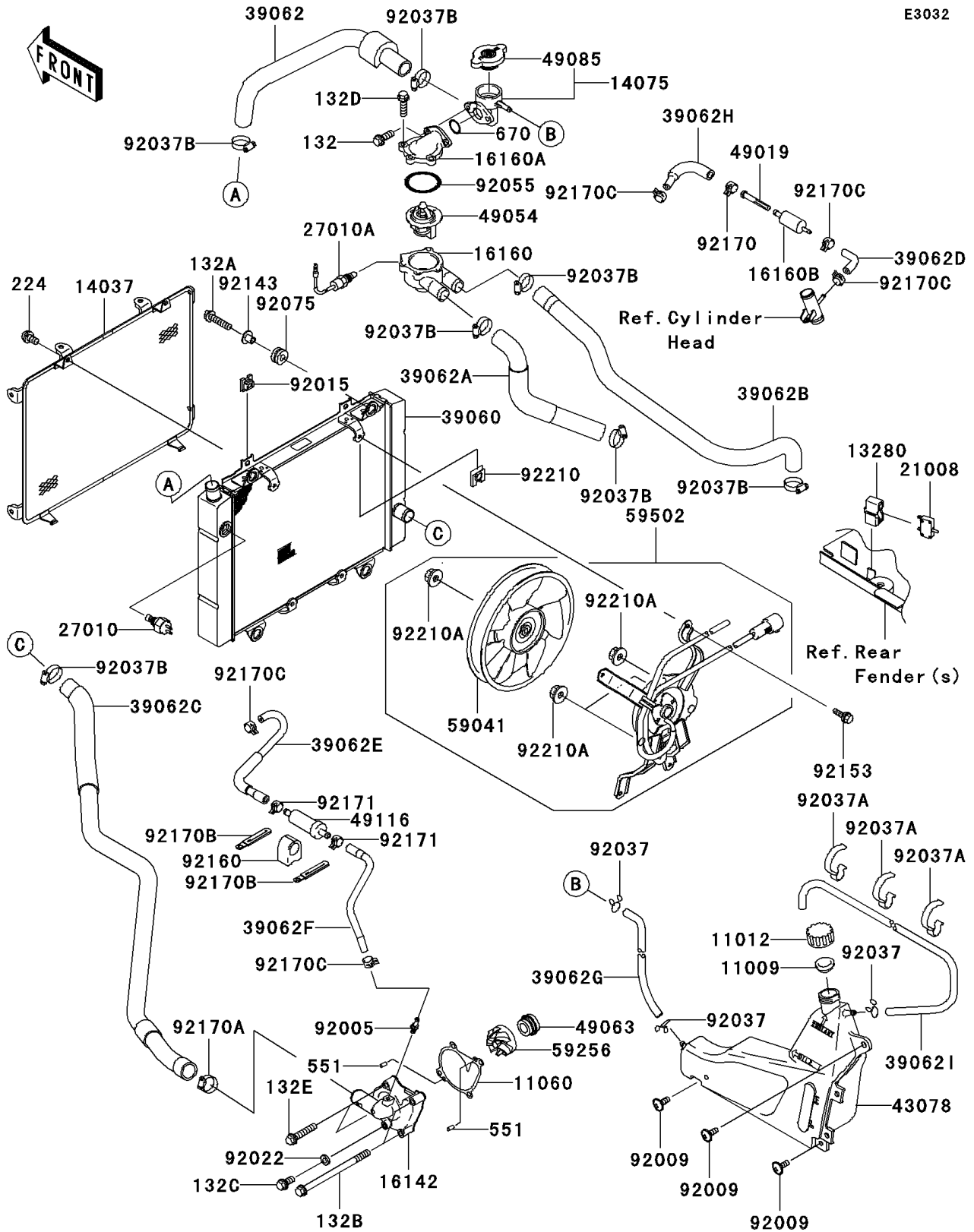

## 2009 Brute Force® 650 4x4 PARTS LIST

### Radiator

ITEM NAME	PART NUMBER	QUANTITY
GASKET,RESERVOIR TANK CAP (Ref # 11009)	11009-1145	1
CAP (Ref # 11012)	11012-1084	1
GASKET,WATER PUMP (Ref # 11060)	11060-1964	1
HOLDER,BREAKER (Ref # 13280)	13280-0082	1
SCREEN,RADIATOR (Ref # 14037)	14037-1283	1
CAP-ASSY,RADIATOR (Ref # 14075)	14075-1085	1
COVER-PUMP,WATER (Ref # 16142)	16142-0002	1
BODY,THERMOSTAT,LWR (Ref # 16160)	16160-1112	1
BODY,THERMOSTAT,UPP (Ref # 16160A)	16160-1113	1
BODY (Ref # 16160B)	16160-1359	1
BREAKER,FAN MOTOR (Ref # 21008)	21008-0001	1
SWITCH,FAN (Ref # 27010)	27010-1202	1
SWITCH,SENSOR WATER (Ref # 27010A)	27010-1346	1
RADIATOR (Ref # 39060)	39060-0011	1
HOSE-COOLING,THERMO-RADIATOR (Ref # 39062)	39062-0081	1
HOSE-COOLING,HEAD,FR-THERMO (Ref # 39062A)	39062-0181	1
HOSE-COOLING,HEAD,RR-THERMO (Ref # 39062B)	39062-0182	1
HOSE-COOLING,RADIATOR-PUMP (Ref # 39062C)	39062-0183	1
HOSE-COOLING,HEAD-FILTER (Ref # 39062D)	39062-1816	1
HOSE-COOLING,CARB-VALVE (Ref # 39062E)	39062-1817	1
HOSE-COOLING,VALVE-WATER PUMP (Ref # 39062F)	39062-1818	1
HOSE-COOLING,THERMO-RESERV (Ref # 39062G)	39062-1823	1
HOSE-COOLING,FILTER-CARB (Ref # 39062H)	39062-1858	1
HOSE-COOLING,5.5X10.5X1030 (Ref # 39062I)	39062-1872	1
RESERVOIR (Ref # 43078)	43078-1171	1
FILTER-WATER (Ref # 49019)	49019-1068	1
THERMOSTAT (Ref # 49054)	49054-1055	1
SEAL-MECHANICAL,WATER (Ref # 49063)	49063-1055	1
CAP-ASSY-PRESSURE (Ref # 49085)	49085-1066	1

## 2009 Brute Force® 650 4x4 PARTS LIST

### Radiator

ITEM NAME	PART NUMBER	QUANTITY
VALVE-ASSY (Ref # 49116)	49116-1190	1
FAN (Ref # 59041)	59041-1062	1
IMPELLER (Ref # 59256)	59256-1069	1
FAN-ASSY (Ref # 59502)	59502-0012	1
FITTING,BLEED PIPE (Ref # 92005)	92005-1337	1
SCREW,6X16 (Ref # 92009)	92009-1621	3
NUT (Ref # 92015)	92015-1487	2
WASHER,6.2X11X1 (Ref # 92022)	92022-304	1
CLAMP,TUBE (Ref # 92037)	92037-147	3
CLAMP,HOSE (Ref # 92037A)	92037-1552	3
CLAMP,COOLING HOSE (Ref # 92037B)	92037-1589	7
BOLT-FLANGED-SMALL,6X16 (Ref # 132)	132BA0616	2
BOLT-FLANGED-SMALL,6X25 (Ref # 132A)	132BA0625	4
BOLT-FLANGED-SMALL,6X90 (Ref # 132B)	132BB0690	2
BOLT-FLANGED-SMALL,6X12 (Ref # 132C)	132BD0612	1
BOLT-FLANGED-SMALL,6X20 (Ref # 132D)	132BD0620	4
BOLT-FLANGED-SMALL,6X30 (Ref # 132E)	132BD0630	2
SCREW-PAN-WP-CROS,6X12 (Ref # 224)	224AB0612	2
PIN-DOWEL,4X8 (Ref # 551)	551A0408	2
O RING,20MM (Ref # 670)	670B2020	1
RING-O,44.7X2.4 (Ref # 92055)	92055-1279	1
DAMPER (Ref # 92075)	92075-209	4
COLLAR (Ref # 92143)	92143-1353	4
BOLT (Ref # 92153)	92153-0531	4
DAMPER,VALVE (Ref # 92160)	92160-1451	1
CLAMP (Ref # 92170)	92170-1491	1
CLAMP (Ref # 92170A)	92170-1497	1
CLAMP (Ref # 92170B)	92170-1514	2
CLAMP (Ref # 92170C)	92170-2042	5

## 2009 Brute Force® 650 4x4 PARTS LIST

### Radiator

ITEM NAME	PART NUMBER	QUANTITY
CLAMP (Ref # 92171)	92171-0515	2
NUT (Ref # 92210)	92210-1323	4
NUT (Ref # 92210A)	92210-1396	4