

2009 Prairie® 360 PARTS DIAGRAM

Crankcase

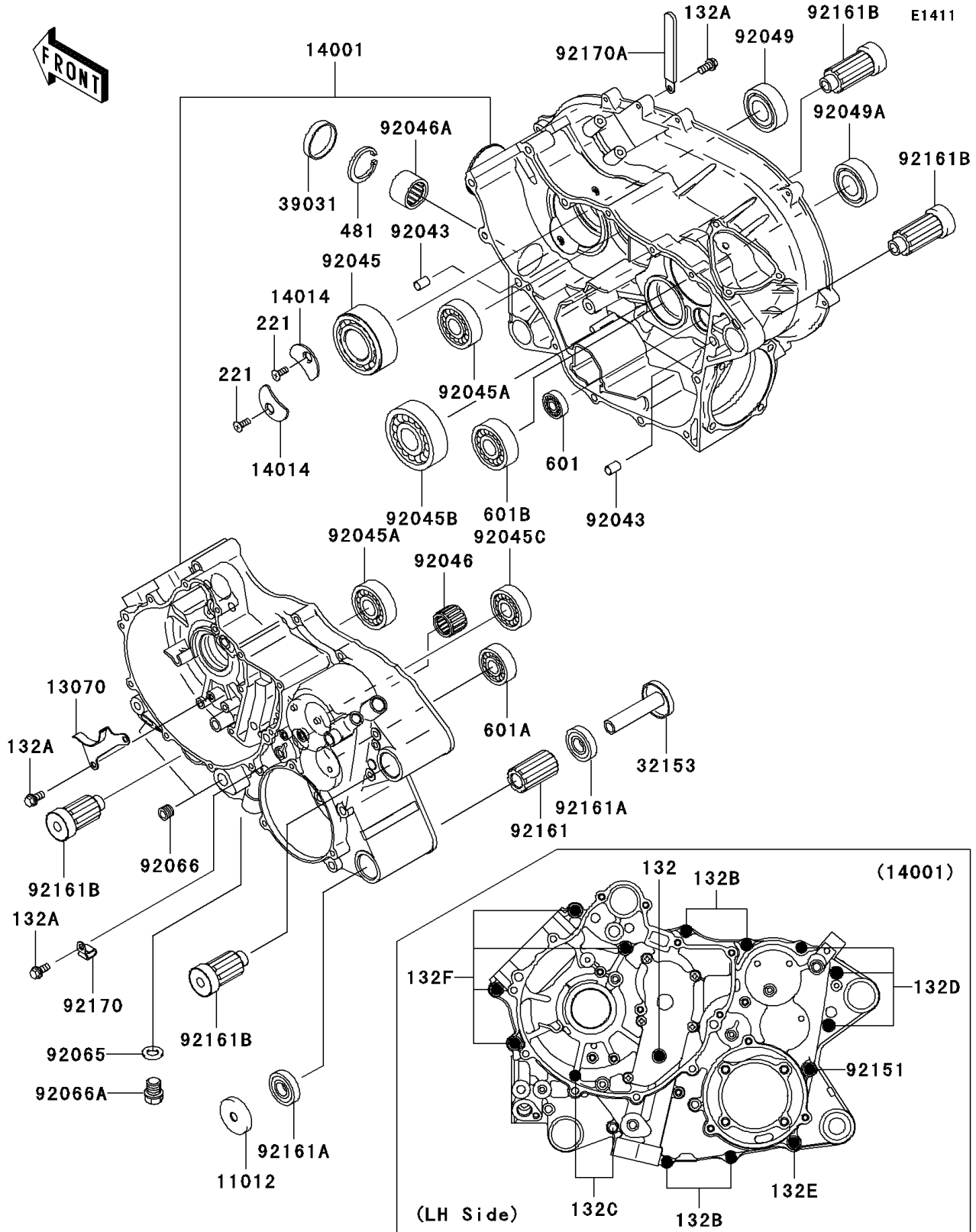

2009 Prairie® 360 PARTS LIST

Crankcase

ITEM NAME	PART NUMBER	QUANTITY
BOLT-FLANGED-SMALL,8X85 (Ref # 132)	132BB0885	1
BOLT-FLANGED-SMALL,6X12 (Ref # 132A)	132BD0612	4
BOLT-FLANGED-SMALL,6X40 (Ref # 132B)	132BD0640	4
BOLT-FLANGED-SMALL,6X65 (Ref # 132C)	132BD0665	2
BOLT-FLANGED-SMALL,6X85 (Ref # 132D)	132BD0685	3
BOLT-FLANGED-SMALL,8X110 (Ref # 132E)	132BD08110	1
BOLT-FLANGED-SMALL,8X75 (Ref # 132F)	132BD0875	4
SCREW-CSK-CROS,6X16 (Ref # 221)	221AA0616	2
CIRCLIP-TYPE-C,37MM (Ref # 481)	481J3700	1
BEARING-BALL (Ref # 601)	601A6000	1
BEARING-BALL,#6004 (Ref # 601A)	601A6004	1
BEARING-BALL,#6304 (Ref # 601B)	601A6304	1
CAP,ENGINE BRACKET (Ref # 11012)	11012-1228	1
GUIDE,CHAIN (Ref # 13070)	13070-1255	1
SET-CRANKCASE (Ref # 14001)	14001-0031	1
PLATE-POSITION (Ref # 14014)	14014-0016	2
PIPE (Ref # 32153)	32153-1873	1
CAP-END (Ref # 39031)	39031-1070	1
PIN,10X14 (Ref # 92043)	92043-1506	2
BEARING-BALL,5207-X1ECG45 (Ref # 92045)	92045-0027	1
BEARING-BALL,TMB304CCM (Ref # 92045A)	92045-1142	2
BEARING-BALL,6306SH2 (Ref # 92045B)	92045-1190	1
BEARING-BALL,6303LUA (Ref # 92045C)	92045-1389	1
BEARING-NEEDLE (Ref # 92046)	92046-1143	1
BEARING-NEEDLE,FJ-2820WA (Ref # 92046A)	92046-1277	1
SEAL-OIL,TC 35X50X8 (Ref # 92049)	92049-1452	1
SEAL-OIL,HTC 30X45X8 (Ref # 92049A)	92049-1575	1
GASKET,12X22X2 (Ref # 92065)	92065-097	1
PLUG,PT3/8X10 (Ref # 92066)	92066-0003	2

2009 Prairie® 360 PARTS LIST

Crankcase

ITEM NAME	PART NUMBER	QUANTITY
PLUG,OIL DRAIN,12X15 (Ref # 92066A)	92066-1174	1
BOLT,8X110 (Ref # 92151)	92151-1689	1
DAMPER,BACK UNDER,PIPE (Ref # 92161)	92161-1257	1
DAMPER,BACK UNDER (Ref # 92161A)	92161-1258	2
DAMPER,L=63.5 (Ref # 92161B)	92161-1259	4
CLAMP (Ref # 92170)	92170-1577	1
CLAMP (Ref # 92170A)	92170-1925	1