

2013 VULCAN® 1700 NOMAD™ PARTS DIAGRAM

Cowling

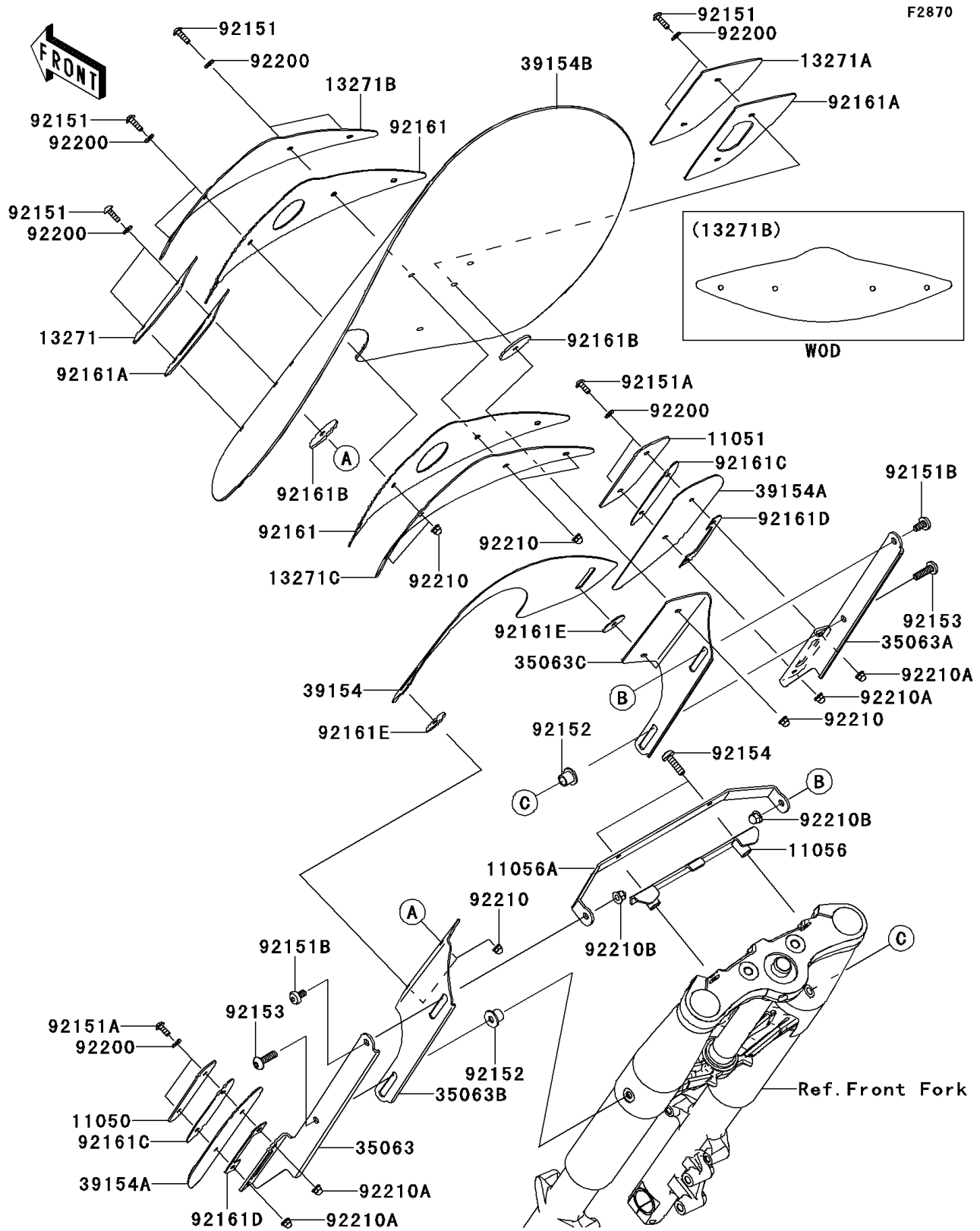

2013 VULCAN® 1700 NOMAD™ PARTS LIST

Cowling

ITEM NAME	PART NUMBER	QUANTITY
BRACKET,DEFLECTOR,LH (Ref # 11050)	11050-1750	1
BRACKET,DEFLECTOR,RH (Ref # 11051)	11051-1061	1
BRACKET (Ref # 11056)	11056-0507	1
BRACKET (Ref # 11056A)	11056-0508	1
PLATE,WINDSHIELD,LH,OUTER (Ref # 13271)	13271-0704	1
PLATE,WINDSHIELD,RH,OUTER (Ref # 13271A)	13271-0705	1
PLATE,WINDSHIELD,CNT,OUTER (Ref # 13271B)	13271-0706	1
PLATE,WINDSHIELD,CNT,INNER (Ref # 13271C)	13271-0707	1
STAY,DEFLECTOR,LH (Ref # 35063)	35063-0538	1
STAY,DEFLECTOR,RH (Ref # 35063A)	35063-0539	1
STAY,WINDSHIELD,LH (Ref # 35063B)	35063-0595	1
STAY,WINDSHIELD,RH (Ref # 35063C)	35063-0596	1
WINDSHIELD,SUB (Ref # 39154)	39154-0034	1
WINDSHIELD,DEFLECTOR (Ref # 39154A)	39154-0325	2
WINDSHIELD,MAIN (Ref # 39154B)	39154-0326	1
BOLT,SOCKET,6X20 (Ref # 92151)	92151-1750	8
BOLT,SOCKET,6X16 (Ref # 92151A)	92151-1751	4
BOLT,SOCKET,8X16 (Ref # 92151B)	92151-1752	2
COLLAR (Ref # 92152)	92152-0742	2
BOLT,SOCKET,8X30 (Ref # 92153)	92153-1467	2
BOLT,SOCKET,8X40 (Ref # 92154)	92154-0186	2
DAMPER,WINDSHIELD,CNT (Ref # 92161)	92161-0330	2
DAMPER,WINDSHIELD,LH&RH,OUTER (Ref # 92161A)	92161-0332	2
DAMPER (Ref # 92161B)	92161-0647	2
DAMPER,DEFLECTOR,OUTER (Ref # 92161C)	92161-0679	2
DAMPER,DEFLECTOR,INNER (Ref # 92161D)	92161-0680	2
DAMPER (Ref # 92161E)	92161-0712	2
WASHER,6.5X14.5X1.5 (Ref # 92200)	92200-3775	12
NUT,CAP,6MM (Ref # 92210)	92210-0220	8

2013 VULCAN® 1700 NOMAD™ PARTS LIST

Cowling

ITEM NAME	PART NUMBER	QUANTITY
NUT,CAP,6MM (Ref # 92210A)	92210-1129	4
NUT,CAP,8MM (Ref # 92210B)	92210-1132	2